

Hubs and Bulkhead Fittings

T&B® Bulkhead Fittings

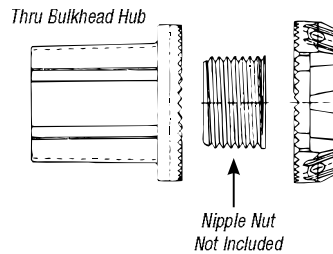
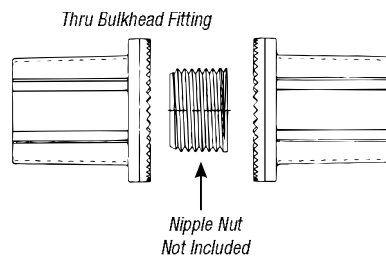
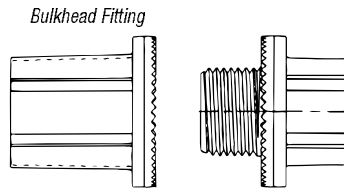
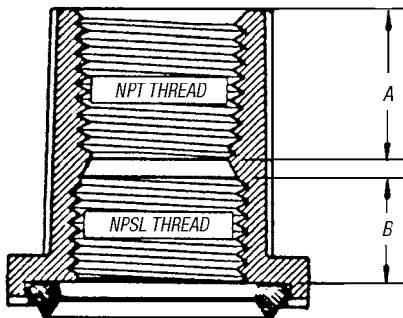
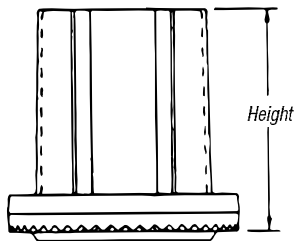
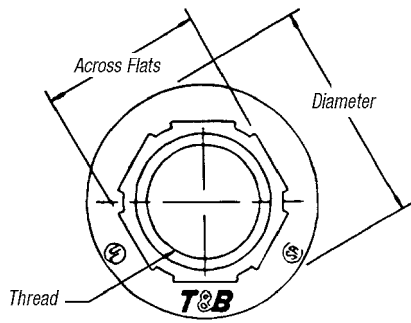

CAT. NO.	TRADE SIZE (IN.)
Bulkhead Fitting	
H050BHD	1/2
H075BHD	3/4
H100BHD	1
H125BHD	1 1/4
H150BHD	1 1/2
H200BHD	2
H250BHD	2 1/2
H300BHD	3
H350BHD	3 1/2
H400BHD	4
H500BHD	5
H600BHD	6
Thru Bulkhead Fitting	
H050TBF	1/2
H075TBF	3/4
H100TBF	1
H125TBF	1 1/4
H150TBF	1 1/2
H200TBF	2
Thru Bulkhead Hub	
H050TBH	1/2
H075TBH	3/4
H100TBH	1
H125TBH	1 1/4
H150TBH	1 1/2
H200TBH	2

TRADE SIZE	THREAD	HEIGHT	DIAMETER	ACROSS FLATS	A (IN.)	B (IN.)
1/2"	1/2"-14"	1 13/32"	1 1/16"	1"	3/4	1/2
3/4"	3/4"-14"	1 15/32"	1 1/16"	1 1/4"	25/32	17/32
1"	1"-11 1/2"	1 11/16"	2"	1 11/32"	29/32	19/32
1 1/4"	1 1/4"-11 1/2"	1 29/32"	2 3/8"	1 21/32"	29/32	21/32
1 1/2"	1 1/2"-11 1/2"	1 13/16"	2 3/4"	1 1/8"	29/32	21/32
2"	2"-11 1/2"	1 27/32"	3 1/4"	2 3/8"	15/16	21/32
2 1/2"	2 1/2"-8"	2 3/32"	3 3/4"	3 3/8"	1 1/32	1/8
3"	3"-8"	2 3/16"	4 3/8"	3 25/32"	1 3/16	29/32
3 1/2"	3 1/2"-8"	2 3/16"	5"	4 9/32"	1 3/8	7/8
4"	4"-8"	2 3/16"	5 1/2"	4 21/32"	1 1/8	1/8
5"	5"-8"	2 29/32"	6 3/8"	5 29/32"	1 15/32	1/8
6"	6"-8"	3"	7 11/16"	7 1/32"	1 1/2	31/32

Material — Hub, Body and Locknut: Zinc or copper-free aluminum
 Insulating Throat: Thermoplastic temp. rating - 105° C
 Flammability Rating - 94V-0
 Sealing Ring: Nitrile (BUNA "N")
 For Aluminum Bulkheads, add suffix A. UL File No. E-3060
 For Chrome-Plated Bulkheads, add suffix CP. CSA File No. 4484
 Meets NEMA sealing requirements for NEMA 3R, 4 & 13 enclosures.

Conduit & Fittings — T&B® Rigid Fittings

Hubs and Bulkhead Fittings

Offset Reducers

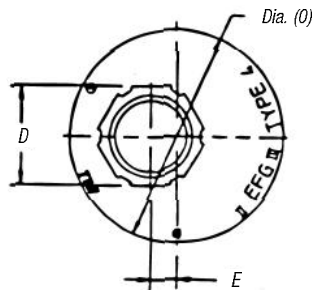
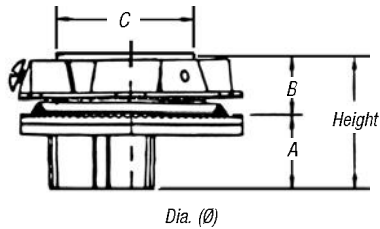

CAT. NO.	TRADE SIZE	HEIGHT	DIA. (Ø)	(IN.)				
				A DIA.	B	C	D	E
H150-TB075ORGR	1½"–¾"	1 ²⁹ / ₃₂ "	2¾	1 ¹⁵ / ₁₆	²³ / ₃₂	1 ²⁹ / ₃₂	1 ⁹ / ₃₂	1 ¹¹ / ₃₂
H150-TB100ORGR	1 ³ / ₃₂ "–1"	1 ²⁵ / ₃₂ "	2¾	1 ¹ / ₁₆	²³ / ₃₂	1 ²⁹ / ₃₂	1 ⁹ / ₁₆	⁷ / ₃₂
H150-TB125ORGR	1 ³ / ₃₂ "–1¼"	1 ²⁵ / ₃₂ "	2¾	1 ¹ / ₁₆	²³ / ₃₂	1 ²⁹ / ₃₂	1 ¹ / ₈	¹ / ₃₂
H250-TB200ORGR	2½"–2"	2½"	3¾	1 ³ / ₁₆	1 ¹⁵ / ₁₆	2 ²⁹ / ₃₂	2 ² / ₃₂	³ / ₃₂

Material — Offset Reducer and Locknut: Zinc or copper-free aluminum
 Insulating Throat: Thermoplastic Temp. Rating – 105° C
 Flammability Rating – 94V-0
 Sealing Ring: Nitrile (BUNA "N")

For Aluminum Offset Reducer, add suffix A.
 For Chrome-Plated Offset Reducer, add suffix CP.
 Meets NEMA sealing requirements for NEMA 3R, 4 & 13 enclosures.
 CSA Certified for hazardous locations Class II Groups E.F.G. Class III.
 UL File No. E-3060
 CSA File No. 4484

Capoffs

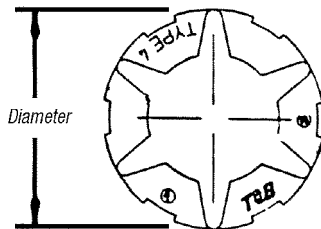
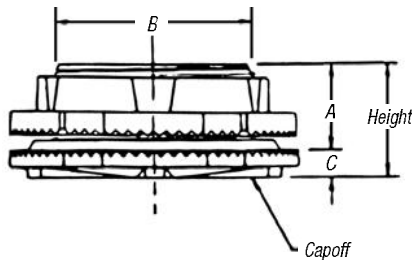

CAT. NO.	TRADE SIZE	HEIGHT	DIAMETER	(IN.)		
				A	B	C
H050CAP	½"	1 ¹³ / ₃₂ "	1 ¹ / ₁₆	¹³ / ₃₂	² / ₃₂	³ / ₁₆
H075CAP	¾"	1 ¹⁵ / ₃₂ "	1 ¹¹ / ₁₆	¹³ / ₃₂	1 ¹ / ₁₆	³ / ₁₆
H100CAP	1"	1 ¹¹ / ₁₆ "	2	1 ¹ / ₁₆	1 ¹ / ₁₆	¹ / ₄
H125CAP	1¼"	1 ²⁹ / ₃₂ "	2 ⁵ / ₈	²³ / ₃₂	1 ²¹ / ₃₂	¹ / ₄
H150CAP	1½"	1 ¹³ / ₁₆ "	2¾	²³ / ₃₂	1 ²⁹ / ₃₂	¹ / ₄
H200CAP	2"	1 ²⁷ / ₃₂ "	3¾	²³ / ₃₂	2 ⁵ / ₈	¹ / ₄
H250CAP	2½"	2 ³ / ₃₂ "	3¾	¹ / ₈	2 ²⁹ / ₃₂	¹ / ₄
H300CAP	3"	2 ³ / ₁₆ "	4 ³ / ₈	¹ / ₈	3 ³ / ₃₂	1 ¹¹ / ₃₂
H350CAP	3½"	2 ⁷ / ₁₆ "	5	²⁹ / ₃₂	4 ¹ / ₃₂	1 ¹¹ / ₃₂
H400CAP	4"	2 ⁷ / ₁₆ "	5½	²⁹ / ₃₂	4 ¹ / ₂	1 ¹¹ / ₃₂
H500CAP	5"	2 ²³ / ₃₂ "	6 ⁷ / ₈	²⁹ / ₃₂	5 ⁹ / ₁₆	1 ¹¹ / ₃₂
H600CAP	6"	3"	7 ⁷ / ₈	³¹ / ₃₂	6 ⁷ / ₈	1 ¹¹ / ₃₂

Material — Capoff and Locknut: Zinc or copper-free aluminum
 Insulating Throat: Thermoplastic temp. rating – 105° C
 Flammability Rating – 94V-0
 Sealing Ring: Nitrile (BUNA "N")

For Aluminum Capoff, add suffix A.
 For Chrome-Plated Capoff, add suffix CP.
 Meets NEMA sealing requirements for NEMA 3R, 4 & 13 enclosures.
 CSA Certified for hazardous locations Class II Groups E.F.G. Class III.
 UL File No. E-3060
 CSA File No. 4484