

TYPES YAV BOX AND YAV

HYLUG™

Seamless Uninsulated Compression Heavy Duty Ring Tongue Terminal

HYLUG™ type YAV is a seamless, heavy duty uninsulated compression ring tongue terminal manufactured from pure electrolytic copper tubing and is for use on copper commercial (code) cable, type AN aircraft cable and extra flexible conductors. Because of its seamless design, the YAV HYLUG™ also accommodates solid conductors.

The seamless tubing produces a double thick tongue and a strong connector for demanding applications that require high reliability. Applications include industrials, hospitals, electric utilities, aircraft, shipboard and marine, computers, steel mills, mining equipment and other equipment that is subject to vibration or requiring dependable electrical performance.

The YAV HYLUG™ terminals meet the requirements of SAE-AS7928.

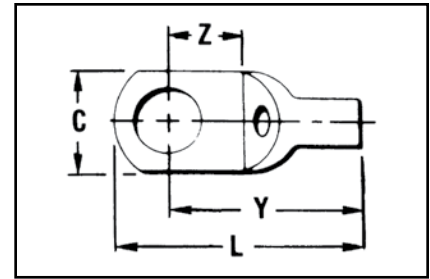
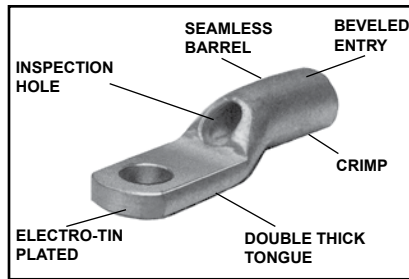

B-15

Features & Benefits

- Manufactured from seamless pure electrolytic copper tubing
- Provides maximum conductivity, low resistance and excellent ductility for crimping
- Seamless tubular crimp barrel design
- No seams to split resulting in a very high quality electrical connection, also can be used on solid conductor
- Double thick tongue
- Provides a very strong terminal tongue
- Produced from tubular copper
- Extra copper material assures the compression connector will operate cooler than the conductors it connects
- Internally bevelled barrel
- Provides easy cable entry, especially for flexible conductors
- Inspection hole
- Provides easy visual check for proper conductor insertion
- Electro-tin plated
- Provides long lasting durable corrosion resistance
- Nickel plating available, add "NK" suffix
- Nickel plated HYLUG™ provide high temperature applications up to 650° F continuous service and 750° F intermittent service



Catalog Number	Wire Range	Stud Size	Dimensions				Bulk Catalog Number	Installation Tooling	Wire Strip Length
			C	L Max.	Y Max.	Z Min.			
YAV18-T4BOX	22-18 Str. and Sol.	3/4	0.19	0.59	0.54	0.16	YAV18T4	Non-Ratchet: Y10D, Y10-22 Ratchet: MR8G98, MR8-9Q, Y8MRB-1, MR20, MRE1022B	9/32"
YAV18-L33BOX		4-6	0.25	0.63	0.55	0.18	YAV18L33		
YAV18-T5BOX		6-8	0.31	0.76	0.61	0.24	YAV18T5		
YAV18-T1BOX							YAV18T1		
YAV18BOX							YAV18		
YAV14-L33BOX	20-14 Str.	4-6	0.25	0.67	0.59	0.18	YAV14L33		
YAV14-T5BOX		6-8	0.31	0.79	0.64	0.24	YAV14T5		
YAV14-T1BOX							YAV14T1		
YAV14-L36BOX	20-12 Sol.	8-10	0.29	0.70	0.59	0.18	YAV14L36		
YAV14BOX		1/4	0.40	0.79	0.64	0.24	YAV14		
YAV14-T2BOX							YAV14T2		
YAV14-T3BOX							YAV14T3		
YAV12-G2BOX ■		† 14-12 Str.	8-10	0.30	0.78	0.67	0.24	YAV12G2	Y10D, Y8MRB-1, M8ND w/N14HT
YAV12-G3BOX ■		1/4	0.34	1.00	0.76	0.33	YAV12G3		
YAV10-T7BOX	14 Str. 12-10	4-6	0.28	0.93	0.78	0.24	YAV10T7*	Non-Ratchet: Y10D, Y10-22 Ratchet: MR8G98, MR8-9Q, Y8MRB-1, MR20, N10HT, N10HT-24, MRE1022B	7/16"
YAV10-T11BOX		6-8	0.38		0.79	0.26	YAV10T11		
YAV10-L36BOX		8-10	0.29	0.86	0.71	0.23	YAV10L36		
YAV10BOX			0.36	0.97	0.79	0.25	YAV10*		
YAV10-T3BOX			1/4	0.45	1.10	0.87	0.32		
YAV10-T2BOX		5/16	0.53	1.13	0.31		YAV10T2*		
YAV10-T4BOX		3/8		1.20	0.88	0.36	YAV10T4*		
YAV9C-L36BOX	10-9 Str.	8-10	0.31	0.94	0.83	0.15	YAV9CL36	Ratchet: MR8-9Q, Y8MRB-1	
YAV9C-T9BOX		1/4	0.44	1.15	0.95	0.31	YAV9CT9		
YAV9C-T4BOX		5/16	0.52	1.23	1.02	0.36	YAV9CT4		

■ Use #14 groove

† UL Listed for 14 Str. to #10 Sol. & Str. when installed with MR8G98 and Y8MRB-1 tools only.

* Class 1 & 2 connectors

Blue highlighted items are industry standard and most frequently ordered.