



Switches

B-2



Combination
Devices

B-12



USB
Receptacles

B-14



Receptacles

B-20



GFCIs

B-30



Power
Devices

B-36



Plugs &
Connectors

B-46



Lampholders



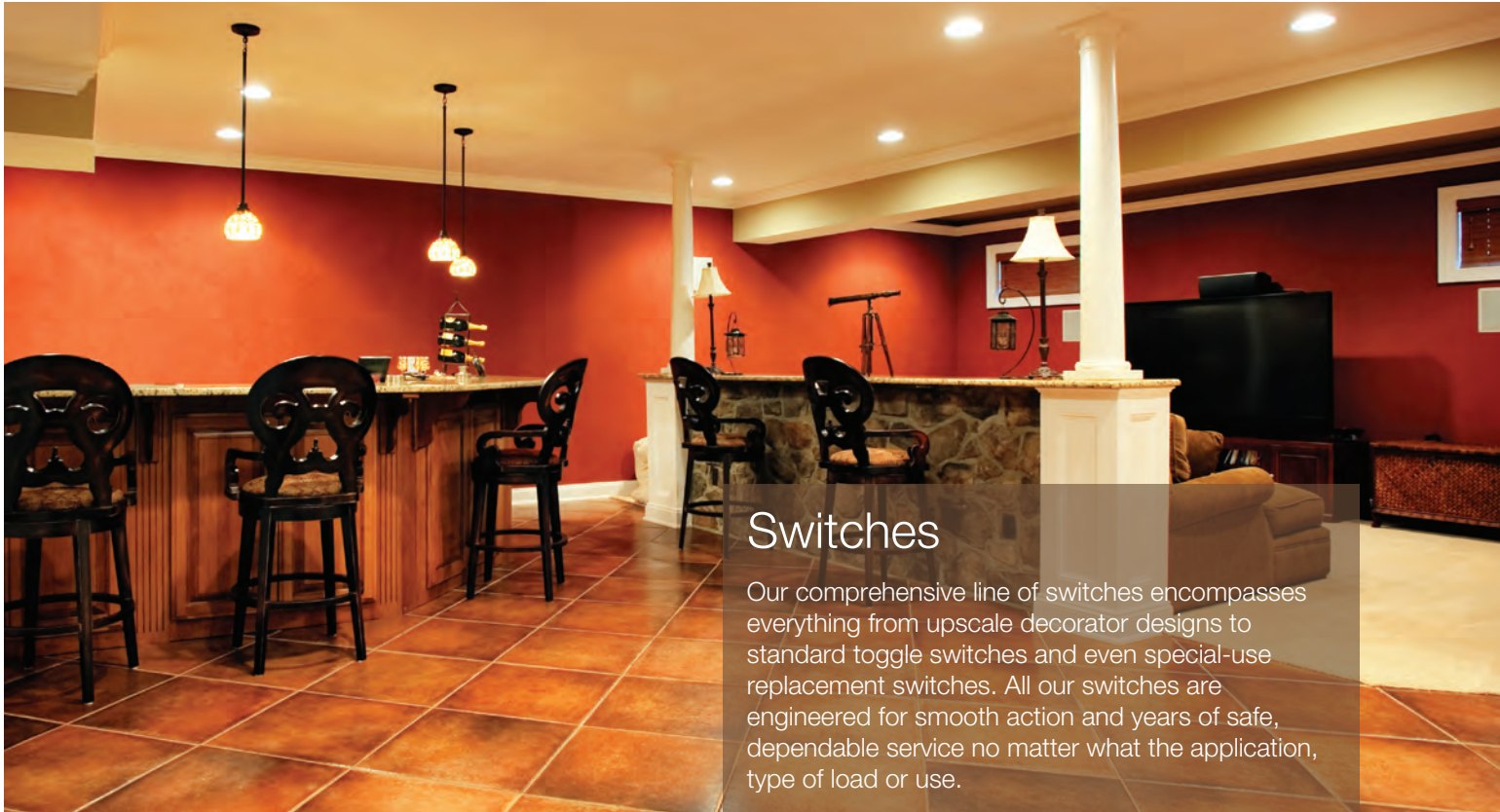

B-56



Switches

Our comprehensive line of switches encompasses everything from upscale decorator designs to standard toggle switches and even special-use replacement switches. All our switches are engineered for smooth action and years of safe, dependable service no matter what the application, type of load or use.

Switch Families

					
Decorator Standard Grade	Heavy Duty Grade Toggle	Standard Grade Toggle	Standard Grade CO/ALR Toggle	Heavy Duty Grade Canopy Switches	Miscellaneous Standard Grade Switches
B-4	B-5	B-6	B-7	B-8	B-11

Switch Colors

Almond (A)	Black (BK)	Brown (B)	Gray (GY)	Ivory (V)	Light Almond (LA)	White (W)
---------------	---------------	--------------	--------------	--------------	----------------------	--------------

The Cooper Wiring Devices Difference



- 1 Built-in wire stripper provides handy backup for misplaced tools
- 2 Longer, wider strap provides 40% more contact area to wallboard, virtually eliminating floating installations
- 3 Ultrasonic welded thermoplastic top and bottom housing eliminate call-backs due to job-site breakage
- 4 Cam action mechanism inside for quiet switch action
- 5 Built-in wire looper to speed termination of both #14 and #12 AWG wire
- 6 Slotted, Phillips and Robertson Tri-Combo screw heads offer greater installation flexibility



Specific Switch Solutions for Today's Needs



Aesthetic Upgrades

Complete the look of a beautiful redecoration, renovation or new home with decorator switches that provide contemporary styling to coordinate perfectly with today's décor.



Shown:
7503

See
page:
B-4



Device Locator Lighting

There are areas in every home where it is difficult to visually locate a switch in low-light or dark conditions. Lighted switches emit a soft glow that makes them easy to find without fumbling.



Shown:
1301-7LT

See
page:
B-6



Aluminum Wiring

There are many homes that still contain aluminum wiring. Using hybrid copper & aluminum compatible (CO/ALR) switches can reduce the hazards of aluminum wiring.



Shown:
5221-7

See
page:
B-7

Standard Grade Toggle Switches

Single-Pole, 3-Way, 4-Way
15A, 120V/AC



1303



1301-7



1301-73

Features

- 3-Way switches feature additional push-in common termination for feed-through tapping
- Push-in terminals accept #14 AWG solid wire only; side wire terminals accept up to #10 AWG solid wire
- Long, broad mounting strap virtually eliminates floating installations
- Patented built-in wire stripper for #12 and #14 AWG wire to speed installation
- Patented built-in wire looper for pre-looping
- Tri-Combo screws accept Slotted, Phillips, and Robertson-head tools for installation flexibility
- Lighted models' toggle glows in "OFF" position

Toggle Switches, Non-Grounding



Rating A	V/AC	Description	Color Suffix	Catalog No.	
15	120	Single-Pole, Side Wire & Push Wire	B, V, W	□ 1301__	•
		3-Way, Back Wire, Side Wire & Push Wire	B, V, W	□ 1303__	•

cULus Listed to UL20, file no. E18704; NOM certified

Toggle Switches, Grounding



Rating A	V/AC	Description	Color Suffix	Catalog No.	
15	120	Single-Pole, Side Wire & Push Wire	A, B, LA, V, W	□ 1301-7__	•
		3-Way, Back Wire, Side Wire & Push Wire	A, B, LA, V, W	□ 1303-7__	•
		4-Way, Side Wire & Push Wire	A, B, LA, V, W	□ 1242-7__	•
		Single-Pole, Less Ears, Side Wire & Push Wire	A, B, LA, W	□ 1301-73__	•
		Lighted, Single-Pole, Side Wire & Push Wire	V, W	□ 1301-7LT__	•
		Lighted, 3-Way, Side Wire & Push Wire	V, W	□ 1303-7LT__	•

cULus Listed to UL20, file no. E18704; NOM certified. Lighted models also CSA certified to C22.2, no. 111.

Color Ordering Information:

For ordering devices, include Catalog No. followed by the Color Suffix: A (Almond), B (Brown), LA (Light Almond), V (Ivory), W (White)

A	B	LA	V	W
(Almond)	(Brown)	(Light Almond)	(Ivory)	(White)

Dimensional Information: B-68 **Specification Information:** Please visit www.cooperwiringdevices.com.
Specifications and availability are subject to change without notice.



NAFTA Compliant - see page F-21

Switches

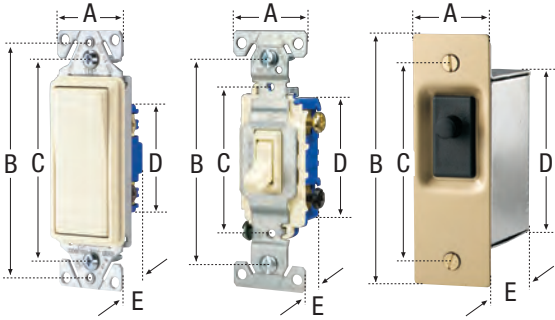

Family	A	B	C	D	E
Decorator Standard Grade, Single-Pole & 3-Way	1.44" (36.6mm)	3.81" (96.8mm)	3.28" (83.3mm)	2.74" (69.6mm)	0.97" (24.6mm)
Decorator Standard Grade, 4-Way	1.44" (36.6mm)	3.81" (96.8mm)	3.28" (83.3mm)	2.60" (66.1mm)	1.18" (30.0mm)
Heavy Duty Grade Toggle	1.31" (33.3mm)	3.28" (83.3mm)	2.38" (60.5mm)	2.00" (50.8mm)	1.05" (26.7mm)
Standard Grade Toggle	1.31" (33.3mm)	3.28" (83.3mm)	2.38" (60.5mm)	2.13" (54.1mm)	0.88" (22.4mm)
Standard Grade Toggle, Less Ears	0.75" (19.1mm)	3.28" (83.3mm)	2.38" (60.5mm)	2.13" (54.1mm)	0.88" (22.4mm)
CO/ALR Standard Grade Toggle	1.31" (33.3mm)	3.28" (83.3mm)	2.38" (60.5mm)	2.13" (54.1mm)	0.88" (22.4mm)
Door Operated Canopy Switch Assembly	1.25" (31.8mm)	3.94" (100.1mm)	3.13" (79.5mm)	2.63" (66.8mm)	1.25" (31.8mm)

Circuit Control Switches

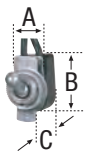

Cat. No.	A	B	C
452	0.50" (12.7mm)	0.88" (22.4mm)	0.53" (13.5mm)

Feed-Through Cord Switches

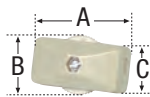

Cat. Nos.	A	B	C
410	1.35" (34.5mm)	0.91" (23.1mm)	0.55" (14.0mm)
933	2.49" (63.4mm)	1.47" (36.7mm)	1.25" (31.6mm)

Combination Devices

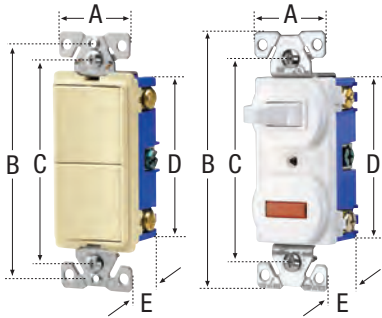

Family	A	B	C	D	E
Decorator Combination	1.30" (33.0mm)	3.81" (96.8mm)	3.28" (83.3mm)	2.65" (67.3mm)	1.08" (27.4mm)
Traditional Combination	1.30" (33.0mm)	4.19" (106.4mm)	3.28" (83.3mm)	2.65" (67.3mm)	1.08" (27.4mm)
Nightlight Combination	1.30" (33.0mm)	3.81" (96.8mm)	3.28" (83.3mm)	2.65" (67.3mm)	1.08" (27.4mm)

Duplex Receptacle

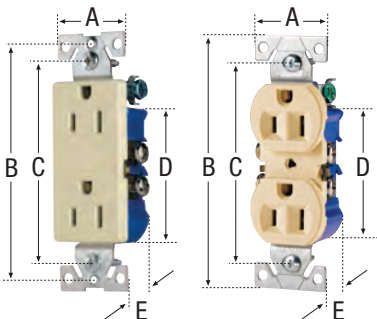

Family or Cat. No.	A	B	C	D	E
Heavy Duty Grade Tamper Resistant	1.24" (31.5mm)	4.00" (101.6mm)	3.23" (82.0mm)	2.63" (66.8mm)	1.04" (26.4mm)
Decorator Standard Grade	1.30" (33.0mm)	3.81" (96.8mm)	3.28" (83.3mm)	2.12" (53.8mm)	0.69" (17.5mm)
Standard Grade, except 298	1.31" (33.3mm)	4.19" (106.4mm)	3.28" (83.3mm)	2.63" (66.8mm)	0.69" (17.5mm)
298	1.31" (33.3mm)	4.19" (106.4mm)	3.28" (83.3mm)	2.63" (66.8mm)	0.74" (18.8mm)
CO/ALR Standard Grade	1.38" (35.1mm)	4.06" (103.1mm)	3.28" (83.3mm)	2.61" (66.3mm)	0.71" (18.0mm)