



# ELLIOTT ELECTRIC SUPPLY

We Deliver...Lower Cost, Quality Products, & Personal Service

3804 South Street  
75964-7263, TX Nacogdoches  
Phone: 936-569-7941  
Fax: 936-560-4685



## 71A5492001D 150W MH Multi-Tap Ballast

*Advance By Signify*

Catalog Number	71A5492001D
Manufacturer	Advance By Signify
Description	Magnetic Hid Kit, Magnetic Hid Ballast, Pulse, 150 W, 120/208/240/277 V Ac, 3.5 A;2.04 A;1.73 A;1.52 A, Non Dimmable, 1 Lamps, 3.9 In Length, 3.9 In Width, 2.8 In Height, 1 Ballast Factor, 0.90 Power Factor, 60 HZ, +105 °C (Ignitor) Operating Temperature, 3.502 KG
Weight per unit	7.8 (lbs/each)
Product Category	Hid Ballast Kits

### Features

ANSI Code	M102/142
dimnable	No
Lamp Type	METAL HALIDE
Power Rating	150 WTT
Wattage	150 WTT

### Descriptions

Description	150W MH MULTI-TAP BALLAST
Special Features	Suitable for Outdoor; UL Listed, CSA, RoHS

### Manufacturer Information

Brand	Signify Electronics
GTIN	00781087053249
UPC	781087053249

### Taxonomies, Classifications, and Categories

Category Description	HID BALLASTS
Type	Magnetic HID

### Packaging

Carton	1
Weight Per each	7.75

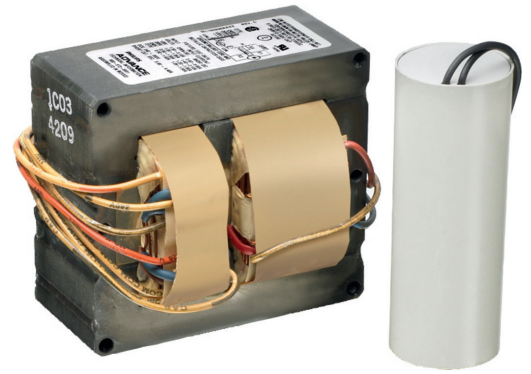

# Core & Coil (71A) MH ~LT~ 175W

## CORE & COIL HID 71A5492001D

The basic ballast is the open core and coil which is most often used as a component within a lighting luminaire. The core and coil also forms the nucleus of Philips Advance's five other ballast configurations.

### Product data

General Information		Input Frequency	
ANSI Code	M102-M142	Input Frequency	60 Hz
Lamp Type	150 MH	Input Current (Open Circuit)	3.5/2.04/1.73/1.52 A
Number of Lamps	1 piece/unit	Input Current (Starting)	1.75/1.3/0.85/0.77 A
Circuit Type	HX-HPF	Input Current (Short Circuit)	1.03-1.41/0.61-0.92/0.49-0.74/0.44-0.67 A
Ballast Type	Magnetic HID	Secondary Short Circuit Current	2.05-2.55 A
Base Model	71A5492	Constant Wattage Deviation	12%
Core Size	3 X 4 (2 LW)	Ballast Factor (Nom)	1
Suitable For Outdoor Use	Yes	Power Factor (Nom)	0.90
Ignitor Catalog Number	LI533-H4	Open Circuit Voltage	250 V
Ignitor Temperature Rating	105°C	Input Current (Nom)	1.6/0.96/0.8/0.7 A A
Capacitor Value	16 MFD	Input Power (Nom)	185 W
Capacitor Catalog Number	7C160M30RA	Rated Lamp Power	150 W
Capacitor Requirements	280V	<b>Wiring</b>	
Capacitor Temperature Rating	105°C	Wire Striplength	0.5 mm
Capacitor Diameter/Oval Dimensions	1.65 in	Wire Length by Color	12"
Capacitor Height	2.75 in	Wire Type	Stranded
Automatic Restart	No	Remote Wiring Configuration Allowed	Yes
<b>Operating and Electrical</b>		Max Ballast-Lamp Distance Remote Wiring	10'
Input Voltage	120/208/240/277 V	Recommended Fuse Value	10/5/5/4 A

## Core & Coil (71A) MH ~LT~ 175W

### Approval and Application

Open Circuit Voltage Test (Volts)	235-290 V
Approval Marks	ULR CSA certificate RoHS Compliant
Temperature Marking	C/B/B/A
UL Recognized	Yes
Hipot Test (1 Minute)	2000 V
Hipot Test (2 Seconds)	2500 V
UL Insulation Class	H(180°C)
UL Temperature Code	1029C

### Product Data

Order product name	CORE & COIL HID 71A5492001D
EAN/UPC - Product	781087053249
Order code	913710606201
Numerator - Quantity Per Pack	1
Numerator - Packs per outer box	1
Material Nr. (12NC)	913710606201
Net Weight (Piece)	3.502 kg

### Dimensional drawing

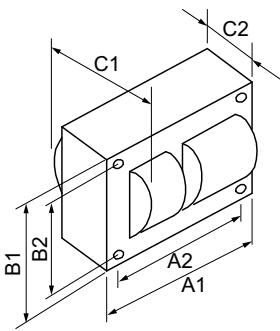

MH BAL 150W M102/142 QUAD KIT

Product	C1	C2	A1	A2	B1	B2
CORE & COIL HID 71A5492001D	3.90 in	2.25 in	3.9 in	3.5 in	2.8 in	2.4 in

