



Core & Coil (71A) MH 175W - 450W

CORE & COIL HID MH BAL 250W M58 QUAD KIT

The basic ballast is the open core and coil which is most often used as a component within a lighting luminaire. The core and coil also forms the nucleus of Philips Advance's five other ballast configurations.

Product data

General Information		Electrical	
ANSI Code	M58	Input Frequency	60 Hz
Lamp Type	250W MH	Input Current (Open Circuit)	2.6/1.5/1.3/1.1 A
Number of Lamps	1 piece/unit	Input Current (Starting)	1/0.6/0.5/0.45 A
Circuit Type	CWA	Input Current (Short Circuit)	1.2-1.8/0.7-1/0.6-0.9/0.5-0.75 A
Ballast Type	Magnetic HID	Secondary Short Circuit Current	2-3 A
Base Model	71A5771	Constant Wattage Deviation	8%
Core Size	3 X 4 (2 coil)	Ballast Factor (Nom)	1
Suitable For Outdoor Use	Yes	Power Factor (Nom)	0.90
Ignitor Catalog Number	NA	Open Circuit Voltage	300 V
Ignitor Temperature Rating	NA	Input Current (Nom)	2.6/1.5/1.3/1.1 A A
Capacitor Value	15 MFD	Input Power (Nom)	294 W
Capacitor Catalog Number	7C150P40R	Rated Lamp Power	250 W
Capacitor Requirements	400V	Wiring	
Capacitor Temperature Rating	105°C	Wire Striplength	0.5 mm
Capacitor Diameter/Oval Dimensions	1.75 in	Wire Length by Color	12"
Capacitor Height	3.75 in	Wire Type	Stranded
Automatic Restart	No	Remote Wiring Configuration Allowed	Yes
Operating and Electrical		Max Ballast-Lamp Distance Remote	Determined by AWG used
Input Voltage	120/208/240/277 V	Wiring	

Core & Coil (71A) MH 175W - 450W

Recommended Fuse Value	8/5/5/3 A
Approval and Application	
Open Circuit Voltage Test (Volts)	270-330 V
Approval Marks	ULR CSA certificate RoHS Compliant
Temperature Marking	C/C/D/D
UL Recognized	Yes
Hipot Test (1 Minute)	2000 V
Hipot Test (2 Seconds)	2500 V
UL Insulation Class	H(180°C)
UL Temperature Code	1029D

Product Data	
Order product name	CORE & COIL HID MH BAL 250W M58 QUAD KIT
EAN/UPC - Product	781087096475
Order code	913700534909
Numerator - Quantity Per Pack	1
Numerator - Packs per outer box	1
Material Nr. (12NC)	913700534909
Net Weight (Piece)	4.614 kg

Dimensional drawing

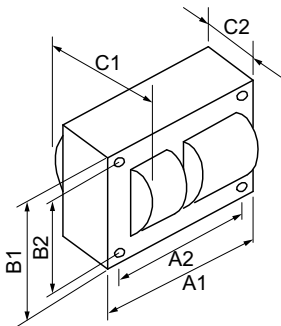

MH BAL 250W M58 QUAD KIT

Product	C1	C2	A1	A2	B1	B2
CORE & COIL HID MH BAL 250W M58 QUAD KIT	4.2 in	3 in	3.9 in	3.5 in	2.8 in	2.4 in

