



ELLIOTT ELECTRIC SUPPLY

We Deliver...Lower Cost, Quality Products, & Personal Service

3804 South Street
75964-7263, TX Nacogdoches
Phone: 936-569-7941
Fax: 936-560-4685



71A5892001D 320W Pulse Start Metal Halide Multi Tap M132/M154

Advance By Signify

Catalog Number	71A5892001D
Manufacturer	Advance By Signify
Description	Magnetic Hid Kit, Magnetic Hid Ballast, Pulse, 320 W, 120/208/240/277 V Ac, 2.3 A;1.35 A;1.15 A;1 A, Non Dimmable, 1 Lamps, 4.8 In Length, 3.65 In Width, 4.3 In Height, 1 Ballast Factor, 0.90 Power Factor, 60 HZ, -20 °F (Starting Temperature) Operating Temperature, +105 °C (Ignitor) Operating Temperature, 5.149 KG
Weight per unit	11.4 (lbs/each)
Product Category	Hid Ballast Kits

Features

ANSI Code	M132/154
dimnable	No
Lamp Type	METAL HALIDE
Power Rating	320 WTT
Wattage	320 WTT

Dimensions and Weight

Width	3.65 lm
-------	---------

Descriptions

Description	320W PULSE START METAL HALIDE MULTI TAP M132/M154
-------------	---

Manufacturer Information

Brand	Signify Electronics
GTIN	00781087096178
UPC	781087096178

Taxonomies, Classifications, and Categories

Category Description	HID BALLASTS
Type	Magnetic HID

Packaging

Carton	1
Weight Per each	11.38

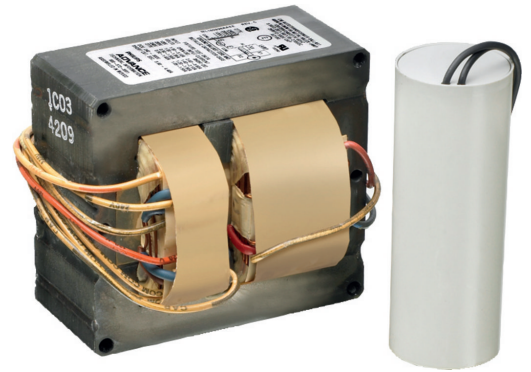

Core & Coil (71A) MH 175W - 450W

CORE & COIL HID 71A5892001D

The basic ballast is the open core and coil which is most often used as a component within a lighting luminaire. The core and coil also forms the nucleus of Philips Advance's five other ballast configurations.

Product data

General Information	
ANSI Code	M132-M154
Lamp Type	320W MH
Number of Lamps	1 piece/unit
Circuit Type	SUPER-CWA
Ballast Type	Magnetic HID
Base Model	71A5892A
Core Size	4 1/4 x 4 3/4 (2 coil)
Suitable For Outdoor Use	Yes
Ignitor Catalog Number	LI533-H4
Ignitor Temperature Rating	105°C
Capacitor Value	21 MFD
Capacitor Catalog Number	7C210P34R
Capacitor Requirements	345V
Capacitor Temperature Rating	105°C
Capacitor Diameter/Oval Dimensions	1.75 in
Capacitor Height	4.8 in
Automatic Restart	No
Operating and Electrical	
Input Voltage	120/208/240/277 V

Input Frequency	60 Hz
Input Current (Open Circuit)	2.3/1.35/1.15/1 A
Input Current (Starting)	1.8/1.05/0.9/0.8 A
Input Current (Short Circuit)	1.65-2.5/1-1.5/0.8-1.25/0.7-1.1 A
Secondary Short Circuit Current	2.9-3.6 A
Constant Wattage Deviation	10%
Ballast Factor (Nom)	1
Power Factor (Nom)	0.90
Open Circuit Voltage	270 V
Input Current (Nom)	3.25/1.9/1.65/1.4 A A
Input Power (Nom)	368 W
Rated Lamp Power	320 W
Wiring	
Wire Striplength	0.5 mm
Wire Length by Color	12"
Wire Type	Stranded
Remote Wiring Configuration Allowed	Yes
Max Ballast-Lamp Distance Remote Wiring	2'
Recommended Fuse Value	8/6/5/3 A

Core & Coil (71A) MH 175W - 450W

Approval and Application

Open Circuit Voltage Test (Volts)	250-300 V
Approval Marks	ULR CSA certificate RoHS Compliant
Temperature Marking	B/B/B/B
UL Recognized	Yes
Hipot Test (1 Minute)	2000 V
Hipot Test (2 Seconds)	2500 V
UL Insulation Class	H(180°C)
UL Temperature Code	1029B

Product Data

Order product name	CORE & COIL HID 71A5892001D
EAN/UPC - Product	781087096178
Order code	913700535309
Numerator - Quantity Per Pack	1
Numerator - Packs per outer box	1
Material Nr. (12NC)	913700535309
Net Weight (Piece)	5.149 kg

Dimensional drawing

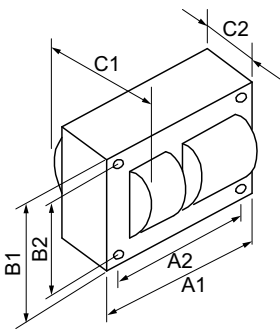

MH BAL 320W M132/154 QUAD KIT

Product	C1	C2	A1	A2	B1	B2
CORE & COIL HID 71A5892001D	3.65 in	1.8 in	4.8 in	4.4 in	4.3 in	3.9 in

