



# ELLIOTT ELECTRIC SUPPLY

We Deliver...Lower Cost, Quality Products, & Personal Service

3804 South Street  
75964-7263, TX Nacogdoches  
Phone: 936-569-7941  
Fax: 936-560-4685



## 71A6051001D 400W MH 5-Tap Ballast

*Advance By Signify*

Catalog Number	71A6051001D
Manufacturer	Advance By Signify
Description	Magnetic Hid Kit, Magnetic Hid Ballast, Probe, 400 W, 120/208/240/277/480 V, 2.86 A;1.45 A;1.29 A;1.1 A;0.62 A, Non Dimmable, 1 Lamps, 4.8 In Length, 4.45 In Width, 4.3 In Height, 1 Ballast Factor, 0.90 Power Factor, 60 HZ, +105 °C (Capacitor) Operating Temperature, 5.938 KG
Weight per unit	13.1 (lbs/each)
Product Category	Hid Ballast Kits

### Features

ANSI Code	M59
dimnable	No
Lamp Type	METAL HALIDE
Power Rating	400 WTT
Wattage	400 WTT

### Dimensions and Weight

Width	SVX02011DAK3L2P3
-------	------------------

### Descriptions

Description	400W MH 5-TAP BALLAST
-------------	-----------------------

### Manufacturer Information

Brand	Signify Electronics
GTIN	00781087110379
UPC	781087110379

### Taxonomies, Classifications, and Categories

Category Description	HID BALLASTS
Type	Magnetic HID

### Packaging

Carton	1
Weight Per each	13.12

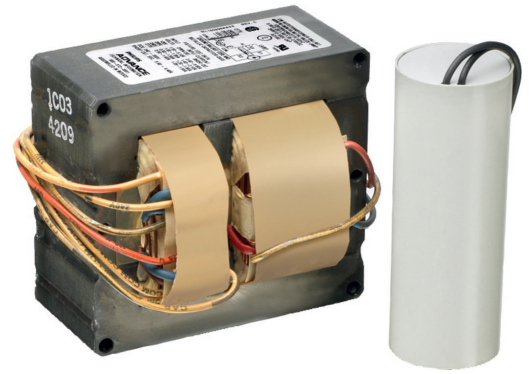

# Core & Coil (71A) MH 175W - 450W

## CORE & COIL HID 71A6051001D

The basic ballast is the open core and coil which is most often used as a component within a lighting luminaire. The core and coil also forms the nucleus of Philips Advance's five other ballast configurations.

### Product data

General Information		Input Frequency	
ANSI Code	M59	Input Frequency	60 Hz
Lamp Type	400W MH	Input Current (Open Circuit)	2.86/1.45/1.29/1.1/0.62 A
Number of Lamps	1 piece/unit	Input Current (Starting)	3.51/2.0/1.72/1.49/0.86 A
Circuit Type	CWA	Input Current (Short Circuit)	2.7-4.05/1.56-2.34/1.29-1.92/1.17-1.76/0.68-1.02 A
Ballast Type	Magnetic HID	Secondary Short Circuit Current	3.04-4.56 A
Base Model	71A6051	Constant Wattage Deviation	10%
Core Size	4 1/4 x 4 3/4 (2 coil)	Ballast Factor (Nom)	1
Suitable For Outdoor Use	Yes	Power Factor (Nom)	0.90
Ignitor Catalog Number	NA	Open Circuit Voltage	300 V
Ignitor Temperature Rating	NA	Input Current (Nom)	4.13/2.29/2.2/1.72/0.99 A A
Capacitor Value	24 MFD	Input Power (Nom)	455 W
Capacitor Catalog Number	7C240P40R	Rated Lamp Power	400 W
Capacitor Requirements	400V	<b>Wiring</b>	
Capacitor Temperature Rating	105°C	Wire Striplength	0.5 mm
Capacitor Diameter/Oval Dimensions	1.75 in	Wire Length by Color	12"
Capacitor Height	4.8 in	Wire Type	Stranded
Automatic Restart	No	Remote Wiring Configuration Allowed	Yes
<b>Operating and Electrical</b>		Max Ballast-Lamp Distance Remote Wiring	Determined by AWG used
Input Voltage	120/208/240/277/480 V	Recommended Fuse Value	10/7/5/5/3 A

## Core & Coil (71A) MH 175W - 450W

### Approval and Application

Open Circuit Voltage Test (Volts)	280-320 V
Approval Marks	ULR CSA certificate RoHS Compliant
Temperature Marking	C/C/D/C/D
UL Recognized	Yes
Hipot Test (1 Minute)	2000 V
Hipot Test (2 Seconds)	2500 V
UL Insulation Class	H(180°C)
UL Temperature Code	1029D

### Product Data

Order product name	CORE & COIL HID 71A6051001D
EAN/UPC - Product	781087110379
Order code	913710414201
Numerator - Quantity Per Pack	1
Numerator - Packs per outer box	1
Material Nr. (12NC)	913710414201
Net Weight (Piece)	5.938 kg

### Dimensional drawing

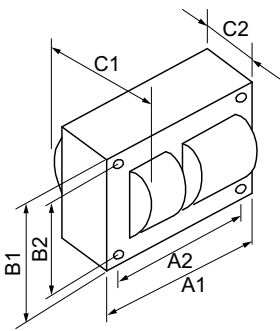

MH BAL 400W M59 5-TAP KIT

Product	C1	C2	A1	A2	B1	B2
CORE & COIL HID 71A6051001D	4.45 in	2.34 in	4.8 in	4.4 in	4.3 in	3.9 in

