



# ELLIOTT ELECTRIC SUPPLY

We Deliver...Lower Cost, Quality Products, & Personal Service

3804 South Street  
75964-7263, TX Nacogdoches  
Phone: 936-569-7941  
Fax: 936-560-4685



## AL500N Comp Conn 500 Alu *Nsi Industries*

|                  |  |
|------------------|--|
| Catalog Number   | AL500N   |
| Manufacturer     | Nsi Industries   |
| Description      | Compression Connector, 250 MCM Conductor Size, 500 MCM Conductor Size, Non-Insulated, Aluminum Conductor Material, Pink Insulation Color, +90 °C Operating Temperature, 6.5 In Overall Length, 35 KV, 0.52 LB/Ea |
| Weight per unit  | 0.5200 (lbs/each)  |
| Product Category | Large Terminals & Connectors   |

### Features

|                 |               |
|-----------------|---------------|
| Cable Size      | 500 MCM (STR) |
| Material        | ALUMINUM      |
| Number of Holes | 2 in          |
| Stud Size       | 0.5 in        |
| Voltage Rating  | 600 VAC       |

### Material, Color, and Finish

|       |      |
|-------|------|
| Color | PINK |
|-------|------|

### Dimensions and Weight

|      |                                     |
|------|-------------------------------------|
| Size | L=6.50 - W=1.78 - OD=1.32 - ID=.840 |
|------|-------------------------------------|

### Descriptions

|             |                   |
|-------------|-------------------|
| Description | COMP CONN 500 ALU |
|-------------|-------------------|

### Manufacturer Information

|      |                |
|------|----------------|
| GTIN | 00662381031082 |
| UPC  | 662381031082   |

### Taxonomies, Classifications, and Categories

|                      |                                   |
|----------------------|-----------------------------------|
| Category Description | Comp & Mech Lugs and Butt Splices |
| Type                 | Standard Barrel - Two Hole        |

### Packaging

|                 |      |
|-----------------|------|
| Carton          | 1    |
| Weight Per each | 0.52 |

### Uses, Certifications, and Standards

|                          |   |
|--------------------------|---|
| Application              | Terminate, Splice, Tap Power Connectors |
| environmental conditions | 90 WTT                                  |
| Mounting                 | 1/2 Mounting Holes IN                   |
| standard                 | UL486                                   |

# CONNECTORS

## Compression Connectors

### Aluminum, Dual Rated, Two Hole Standard Barrel AL-N Series



#### FEATURES

- Produced from high conductivity aluminum tubing.
- Electro-tin plated for corrosion resistance.
- Color coded and marked with die index information.
- Pre-filled with oxide inhibitor and capped with color coded cap.
- Listed for 35KV maximum when properly installed to cable manufactures specifications.

#### SPECIFICATIONS

- cULus Listed for Wire Connector.
- UL486A/B Listed for Wire Connector.
- UL Listed to 35kV when properly installed to cable manufactures specifications.
- **Temperature Rating:** 90 °C. AL9CU
- **Crimp Tool:** N1240, N121D.
- **Voltage:** 600V max. (2000V max. per UL486B).

CONNECTORS

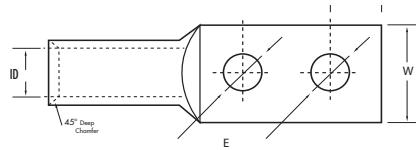
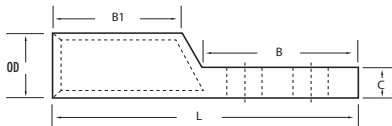

**\*EXPANDED WIRE RANGE** when installed with NSI N121D dieless compression tool.  
UL Listed with other tools:  
**FOR TOOL/DIE CRIMPING INFORMATION, PLEASE SEE TABLE ON PAGE 90**

| CAT. NO. | WIRE RANGE | EXPANDED WIRE RANGE* | COLOR CODE | BOLT SIZE | MTG. HOLE SPACING | O.D.  | I.D.  | LENGTH (L) | WIDTH (W) | TANG LENGTH (A) | TANG LENGTH (B) | BARREL LENGTH (B1) | TANG THICKNESS (C) | MTG. HOLE DIA. (E) | STD. CTN. QTY. |
|----------|------------|----------------------|------------|-----------|-------------------|-------|-------|------------|-----------|-----------------|-----------------|--------------------|--------------------|--------------------|----------------|
| AL1/ON   | 1/0 AWG    | 1/0-6 AWG            | Tan        | 1/2       | 1.750             | 0.630 | 0.390 | 4.748      | 0.847     | 0.630           | 3.118           | 1.201              | 0.240              | 0.508              | 12             |
| AL2/ON   | 2/0 AWG    | 2/0-4 AWG            | Olive      | 1/2       | 1.750             | 0.690 | 0.440 | 4.799      | 0.937     | 0.630           | 3.118           | 1.299              | 0.240              | 0.508              | 12             |
| AL3/ON   | 3/0 AWG    | 3/0-2 AWG            | Ruby       | 1/2       | 1.750             | 0.760 | 0.480 | 5.000      | 1.028     | 0.630           | 3.118           | 1.402              | 0.280              | 0.508              | 12             |
| AL4/ON   | 4/0 AWG    | 4/0-1 AWG            | White      | 1/2       | 1.750             | 0.840 | 0.550 | 5.248      | 1.150     | 0.630           | 3.118           | 1.402              | 0.287              | 0.508              | 12             |
| AL250N   | 250 MCM    | 250 MCM-1/0 AWG      | Red        | 1/2       | 1.750             | 0.920 | 0.590 | 5.307      | 1.260     | 0.630           | 3.118           | 1.500              | 0.319              | 0.508              | 12             |
| AL300N   | 300 MCM    | 300 MCM-2/0 AWG      | Blue       | 1/2       | 1.750             | 1.010 | 0.650 | 5.500      | 1.370     | 0.630           | 3.118           | 1.598              | 0.347              | 0.508              | 6              |
| AL350N   | 350 MCM    | 350MCM-3/0 AWG       | Brown      | 1/2       | 1.750             | 1.120 | 0.720 | 5.870      | 1.520     | 0.630           | 3.118           | 1.902              | 0.390              | 0.508              | 6              |
| AL400N   | 400 MCM    | 400MCM-4/0 AWG       | Green      | 1/2       | 1.750             | 1.190 | 0.760 | 6.429      | 1.606     | 0.630           | 3.118           | 2.299              | 0.417              | 0.508              | 6              |
| AL500N   | 500 MCM    | 500-250 MCM          | Pink       | 1/2       | 1.750             | 1.320 | 0.840 | 6.500      | 1.787     | 0.630           | 3.118           | 2.500              | 0.469              | 0.508              | 6              |
| AL600N   | 600 MCM    | 600-250 MCM          | Black      | 1/2       | 1.750             | 1.440 | 0.920 | 6.748      | 1.779     | 0.630           | 3.118           | 2.598              | 0.508              | 0.508              | 3              |
| AL750N   | 750 MCM    | 750-500 MCM          | Yellow     | 1/2       | 1.750             | 1.598 | 1.030 | 7.370      | 1.744     | 0.630           | 3.118           | 3.201              | 0.547              | 0.508              | 3              |
| AL1000N  | 1000 MCM   | —                    | Brown      | 1/2       | 1.750             | 1.831 | 1.170 | 7.437      | 2.500     | 0.750           | 3.219           | 2.562              | 0.687              | 0.508              | 1              |