



# ELLIOTT ELECTRIC SUPPLY

We Deliver...Lower Cost, Quality Products, & Personal Service

3804 South Street  
75964-7263, TX Nacogdoches  
Phone: 936-569-7941  
Fax: 936-560-4685



## AMP1H6 (1)-350 to (6)-#4 Power Dist Block

*Nsi Industries*

Catalog Number	AMP1H6
Manufacturer	Nsi Industries
Description	
Weight per unit	0.5900 (lbs/each)
Product Category	Terminal Blocks & Accessories

### Features

amperage rating	310 WTT
Material	Aluminum/Glass/Polyester
Number of Terminals	7 MFD
Voltage Rating	600 VAC
Wire Size	(1) 350 MCM-6 AWG(Line) - (6) 4-14 AWG(Load)

### Material, Color, and Finish

Color	BLACK
-------	-------

### Dimensions and Weight

Size	L=4.00 - H=2.62 - W=1.71 IN
------	-----------------------------

### Descriptions

Description	(1)-350 TO (6)-#4 POWER DIST BLOCK
Product Type	1X350-6 Line 6X4-14 Load
Special Features	(1) 350 MCM-6 AWG (Line Side) - (6) 4-14 AWG (Load Side) - 310 Amps Per Pole

### Manufacturer Information

Brand	NSi
GTIN	00662381165374
Manufacturers Part Number	AM-P1-H6
sub brand	Connector Blocks
UPC	662381165374

### Taxonomies, Classifications, and Categories

Category Description	TERMINAL BLOCKS POWER DIST BLOCKS
Type	Single Primary

### Packaging

Carton	1
Package	3
Weight Per each	0.59



# ELLIOTT ELECTRIC SUPPLY

We Deliver...Lower Cost, Quality Products, & Personal Service

3804 South Street  
75964-7263, TX Nacogdoches  
Phone: 936-569-7941  
Fax: 936-560-4685

## Uses, Certifications, and Standards

Application .....	Terminate, Splice, Tap Power Connectors .....
Mounting .....	2 Mounting Holes .....
standard .....	Recognized to UL1059 .....



# Connector Bloks™

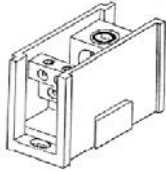

Drawn - SD  
Approved - KM

Title - Connector Bloks™

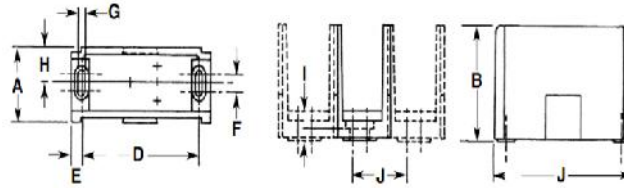

Dual Rated Connector Bloks

Insulator Cat. No	A	B	C	D	E	F	G	H	I	J	
S	1.04	2.34	2.90	2.25	0.18	0.35	0.20	0.46	0.19	0.63	1.25
M	1.71	2.62	4.00	3.50	0.25	0.37	0.20	0.79	0.20	1.25	1.87
L	2.90	3.25	5.50	5.00	0.25	0.50	0.27	1.38	0.29	2.25	3.25

Part Number	Temp Rating	Line Side	Load Side	Amps Per Pole	Insulator Block			Insulator Block Size
					L	W	H	
AS-K1-H4	90 C	 2/0-14 AWG	 4-14 AWG	175	2.90	1.04	2.34	S
AS-K1-H6	90 C	 2/0-14 AWG	 4-14 AWG	175	2.90	1.04	2.34	S
AM-P1-H6	90 C	 350MCM-6AWG	 4-14 AWG	310	4.00	1.71	2.62	M
AM-P1-H12	90 C	 350MCM-6AWG	 4-14 AWG	310	4.00	1.71	2.62	M
AM-R1-H12	90 C	 500MCM-4AWG	 4-14 AWG	380	4.00	1.71	2.62	M
AL-R1-M4	90 C	 500MCM-4AWG	 4/0-6 AWG	380	5.50	2.90	3.25	L
AL-P1-K6	90 C	 350MCM-6AWG	 2/0-14 AWG	310	5.50	2.90	3.25	L
AL-R1-K6	90 C	 500MCM-4AWG	 2/0-14 AWG	380	5.50	2.90	3.25	L
AL-V1-K6	90 C	 1000-250 MCM	 2/0-14 AWG	545	5.50	2.90	3.25	L