

Beams

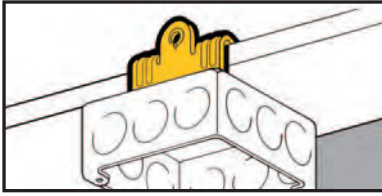

- Suspend boxes or fixtures from beam flanges 1/8" to 3/4" thick.
- Provided with 1/4"-20 thread impression for quick and secure attachment.
- Simply installed with a hammer.

Universal Beam Fasteners



UPC/Part Number	Catalog Number	Flange Thickness	Box Qty.
781011 19600	BU-2-4	1/8" - 1/4"	100
781011 19605	BU-5-8	5/16" - 1/2"	100
781011 19610	BU-9-12	9/16" - 3/4"	100

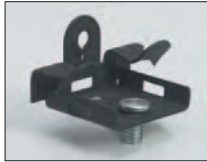

1/4"-20 x 3/8"
Staked Stud

UPC/Part Number	Catalog Number	Flange Thickness	Box Qty.
781011 19615	BU-2-4-S	1/8" - 1/4"	100
781011 19620	BU-5-8-S	5/16" - 1/2"	100
781011 19625	BU-9-12-S	9/16" - 3/4"	100

Beams

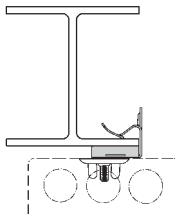
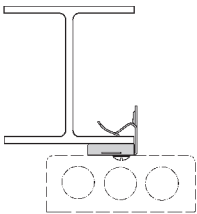

Static Load Capacity

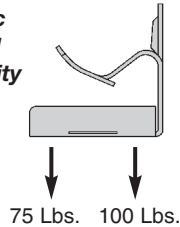

Read safety/installation instruction sheets in packages before use. These products are designed for positioning only. No load rating.