

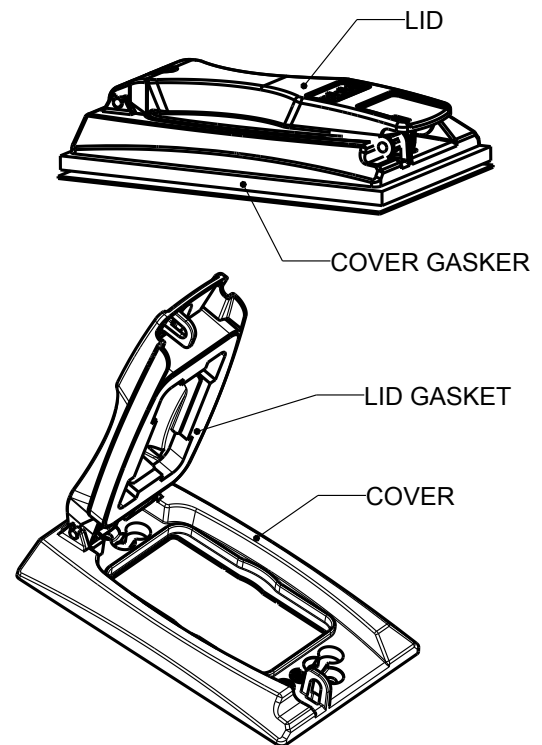

Red-Dot

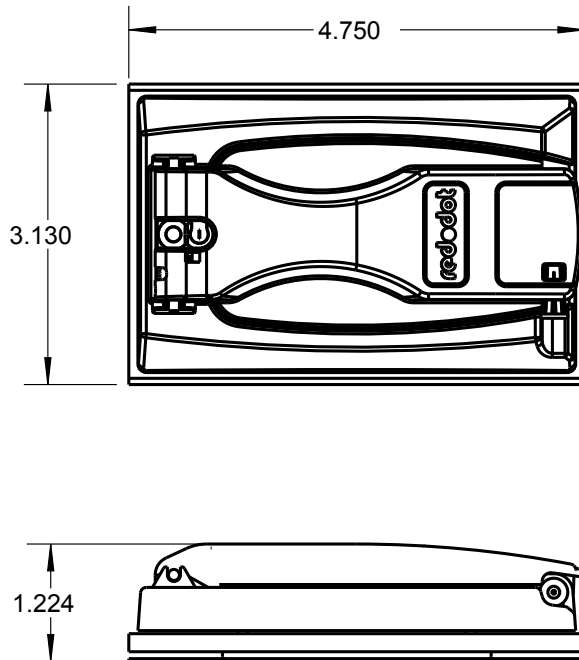

NOTES:

1. COVER & LID: DIE CAST ZINC, POWDER COAT FINISH.
2. COVER & LID GASKET: CROSS-LINKED POLYETHYLENE FOAM.
3. MOUNTING HARDWARE, DUPLEX AND SWITCH ADAPTER PLATES PROVIDED.

CAT. NO.		DESCRIPTION			
CCU		SINGLE-GANG COVER (INSTALLS VERTICALLY OR HORIZONTALLY)-SILVER			
DCCU		D-PAK -SINGLE-GANG COVER, SILVER			
DCCU-BR		D-PAK -SINGLE-GANG COVER, BRONZE			
DCCU-WH		D-PAK -SINGLE-GANG COVER, WHITE			
GENERAL NOTES		<div>www.tnb.com</div> <div>Thomas & Betts A Member of the ABB Group</div>			
1. ALL DIMENSIONS ARE FOR REFERENCE ONLY. 2. DIMENSIONS IN BRACKETS [] ARE IN METRIC UNITS.					
REVISIONS		DESCRIPTION: SINGLE-GANG UNIVERSAL FLIP-LID COVER			
0 SEE ERN (****) FOR APPROVAL SIGNATURES & RELEASE DATE. PROJECT NO: ****					
		ORIGINAL PROJECT NO / (ERN NO) 002V000686 / (2017563)	SHEET NO: 1 OF 1	REV. NO: 0	DRAWING NO: WSD-001717

THIS DRAWING IS INTENDED FOR DESCRIPTIVE PURPOSES ONLY. AND THE RIGHT IS RESERVED TO DEVIATE FROM ANY OF THE DETAILS SHOWN HEREON.
COPYRIGHT THOMAS & BETTS CORPORATION. ALL RIGHTS RESERVED. PROPRIETARY AND CONFIDENTIAL.



Red-Dot

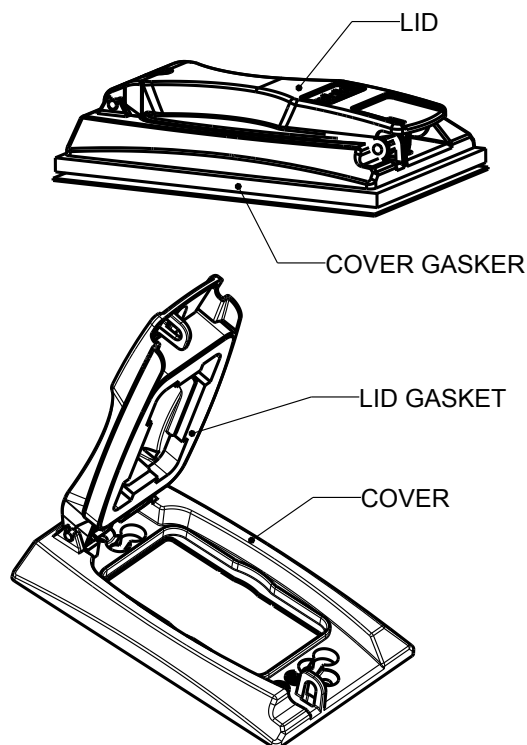
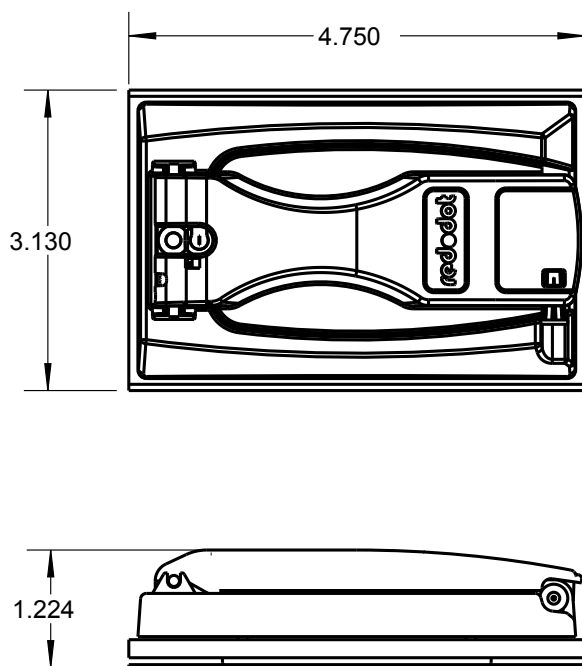

NOTES:

1. COVER & LID: DIE CAST ZINC, POWDER COAT FINISH.
2. COVER & LID GASKET: CROSS-LINKED POLYETHYLENE FOAM.
3. MOUNTING HARDWARE, DUPLEX AND SWITCH ADAPTER PLATES PROVIDED.

CAT. NO.		DESCRIPTION			
CCU		SINGLE-GANG COVER (INSTALLS VERTICALLY OR HORIZONTALLY)-SILVER			
DCCU		D-PAK -SINGLE-GANG COVER, SILVER			
DCCU-BR		D-PAK -SINGLE-GANG COVER, BRONZE			
DCCU-WH		D-PAK -SINGLE-GANG COVER, WHITE			
GENERAL NOTES		<div>www.tnb.com</div> <div>Thomas&Betts A Member of the ABB Group</div>			
1. ALL DIMENSIONS ARE FOR REFERENCE ONLY. 2. DIMENSIONS IN BRACKETS [] ARE IN METRIC UNITS.					
REVISIONS		DESCRIPTION: SINGLE-GANG UNIVERSAL FLIP-LID COVER			
0	SEE ERN (****) FOR APPROVAL SIGNATURES & RELEASE DATE. PROJECT NO: ****	ORIGINAL PROJECT NO / (ERN NO) 002V000686 / (2017563)	SHEET NO: 1 OF 1	REV. NO: 0	DRAWING NO: WSD-001717

THIS DRAWING IS INTENDED FOR DESCRIPTIVE PURPOSES ONLY. AND THE RIGHT IS RESERVED TO DEViate FROM ANY OF THE DETAILS SHOWN HEREON.
COPYRIGHT THOMAS & BETTS CORPORATION. ALL RIGHTS RESERVED. PROPRIETARY AND CONFIDENTIAL.