

Catalog Number
Notes
Type

## FEATURES & SPECIFICATIONS

**INTENDED USE** — The CLX is a linear lighting solution that is available in multiple lengths, lumen packages and distributions. Designed for versatility, the CLX can address virtually any indoor lighting need. The CLX is capable of being continuous row mounted or installed as a stand-alone fixture. Ideal for uplight and downlight in commercial, retail, manufacturing, warehouse, and display applications. CLX Tunable White is perfect for operational spaces where there is little natural light as it allows the light color temperature to be adjusted based on time of day. Also great for settings where work is being done 24 hours a day. **Certain airborne contaminants can diminish the integrity of acrylic and/or polycarbonate.** [Click here for Acrylic/Polycarbonate Compatibility table for suitable uses.](#)

**CONSTRUCTION** — Channel and cover are formed from code-gauge cold-rolled steel.

Finish: Paint options include high-gloss, baked white polyester (WH), galvanized (GALV), matte black (MB) and smoke gray (SKGY). Five-stage iron phosphate pre-treatment ensures superior paint adhesion and rust resistance. Housing and lens endcaps are injection molded plastic to provide a more architectural look and feel. The endcaps come standard with a knock out but can be ordered without.

**OPTICS** — Offered in lens and less lens configurations. Provides a choice of optical distributions including, wide, narrow, and aisle.

**ELECTRICAL** — Utilizes high-output LEDs integrated on a two-layer circuit board, ensuring cool-running operation. Optional internal pluggable wiring harness for reduced labor cost in row mounting applications. (See PLR ordering information on page 6.) This fixture is designed to withstand a maximum line surge of 2.5kV at 0.75kA combination wave for indoor locations, for applications requiring higher level of protection additional surge protection must be provided.

LEDs provide nominal 80 CRI or 90CRI.

Lumen output up to 1,250 lumens per foot.

**Mainstream Dynamic Tunable White with nTune Technology:** This fixture is nLight-enabled, meaning it has the ability to communicate over an nLight network. When wired, using CAT-5 cabling, with other nLight-enabled sensors, power packs, or WallPods, an nLight control zone is created. Once linked to a Gateway, directly or via a Bridge, the zone becomes capable of remote status monitoring and control via SensorView software. See page 2 for the nLight sensor options.

**Integrated Sensor (nLight Wired Networking):** Tunable white nTune™ is an all digital light color temperature control within an nLight enabled luminaire. This brings tunable white lighting control into the mainstream with repeatable, consistent results in an economical luminaire form and system already familiar to schools. Designers and facility operators are granted the freedom to tie scenes to specific activities or to complement colors or materials within a visual environment. nTune™ allows color temperature settings through the Productivity Range of 3000K-5000K or RHYR, the Rhythm range of 2700K to 6500K. Refer to the Programming User's Guide for instructions on customizing to your application with SensorView. Settings from factory will ship with the lowest CCT color and 100% lumen output.

**INSTALLATION** — Fixture may be ceiling or wall mounted (with or without THCLX hanger or angle mounted with CLXANGBRT), pendant or stem mounted with appropriate mounting options.

**LISTINGS** — CSA certified to US and Canadian safety standards. For use in damp locations between -4°F (-20°C) and 104°F (40°C).

**BUY AMERICAN ACT** — Product with the BAA option is assembled in the USA and meets the Buy America(n) government procurement requirements under FAR, DFARS and DOT regulations. Please refer to [www.acuitybrands.com/buy-american](http://www.acuitybrands.com/buy-american) for additional information

**WARRANTY** — 5-year limited warranty. This is the only warranty provided and no other statements in this specification sheet create any warranty of any kind. All other express and implied warranties are disclaimed. Complete warranty terms located at: [www.acuitybrands.com/support/warranty/terms-and-conditions](http://www.acuitybrands.com/support/warranty/terms-and-conditions)

**Note:** Actual performance may differ as a result of end-user environment and application.

All values are design or typical values, measured under laboratory conditions at 25 °C.

Specifications subject to change without notice.

LED Linear

# CLX TUNABLE WHITE

24", 36", 48" and 96" Lengths

Flat Diffuse Lens

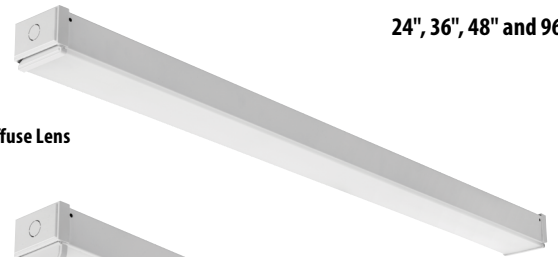

Round Diffuse Lens



Wide Diffuse Lens

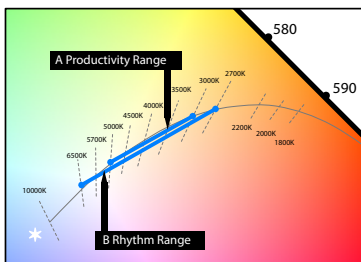
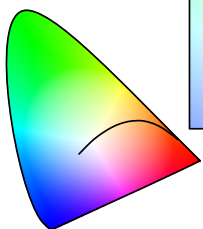

- Ⓐ Productivity Range 3000K to 5000K
- Ⓑ Rhythm Range 2700K to 6500K

## A+ Capable Luminaire

This item is an A+ capable luminaire, which has been designed and tested to provide consistent color appearance and out-of-the-box control compatibility with simple commissioning.

- All configurations of this luminaire meet the Acuity Brands' specification for chromatic consistency
- This luminaire is part of an A+ Certified solution for nLight® control networks marked by a shaded background\*

To learn more about A+, visit [www.acuitybrands.com/aplus](http://www.acuitybrands.com/aplus).

\*See ordering tree for details

# CLX TUWH LED Linear

## ORDERING INFORMATION

Lead times will vary depending on options selected. Consult with your sales representative.

**Example:** CLX L48 5000LM SEF WDL MVOLT EDAB TUWH PROR NLT 80CRI WH

Series	Length	Nominal lumens	Performance package	Louver	Lens
CLX LED linear	L24 24" <sup>1</sup>	1500LM 1,500 lumens 2000LM 2,000 lumens 2500LM 2,500 lumens	SEF Standard efficiency	(Blank) Less louver SBLW Straight blade louver, white <sup>2</sup> SBLMB Straight blade louver, matte black <sup>2</sup> SBLGV Straight blade louver, galvanized <sup>2</sup> SBLSKGY Straight blade louver, smoke gray <sup>2</sup>	L/Lens Less lens FDL Flat diffuse <sup>3</sup> RDL Round diffuse <sup>3</sup> WDL Wide diffuse <sup>3</sup>
	L36 36"	2250LM 2,250 lumens 3000LM 3,000 lumens 3750LM 3,750 lumens			
	L48 48"	3000LM 3,000 lumens 4000LM 4,000 lumens 5000LM 5,000 lumens			
	L96 96"	6000LM 6,000 lumens 8000LM 8,000 lumens 10000LM 10,000 lumens			

Distribution	Voltage	Driver	Dynamic Feature	Dynamic Range	Control Interface Type	Coloring rendering index
(Blank) General	MVOLT 120-277V	EDAB EldoLED dim to black	TUWH Tunable white	PROR Productivity Range 3000K - 5000K RHYR Rhythm range 2700K - 6000K	NLT (nLight nTune interface)	80CRI 80 CRI 90CRI 90 CRI
ND Narrow <sup>4</sup>	120 120V					
WD Wide <sup>4</sup>	208 208V					
AD2 Aisle, 24° off center <sup>4</sup>	240 240V 277 277V 347 347V <sup>6,7</sup> 480 480V					

Options	Finish
PS1050 Emergency battery pack, <a href="#">10W</a> , CA Title 20 Noncompliant <sup>7,8,9</sup>	WH White
E10WLCP Emergency battery pack, <a href="#">10W</a> Linear Constant Power, Certified in CA Title 20 MAEDBS <sup>7,8,9</sup>	GALVW Galvanized with white lens end caps
OCS 5', 18/3 Reloc selectable One Pass cable <sup>8</sup> (fixture will bear dry location label)	GALVB Galvanized with black lens end caps
EPNKO Decorative endplate, no knock out <sup>9</sup>	MB Matte black
OUTCTR Wiring leads pulled through back center of fixture <sup>13,14</sup>	SKGYW Smoke gray with white lens end caps
OUTEND Wiring leads pulled through end of fixture <sup>15</sup>	SKGYB Smoke gray with black lens end caps
6' CS1W Straight blade plug, 120V, ships white <sup>5,8,11</sup>	
CS3W NEMA twist-lock plug, 120V, ships white <sup>5,8,11</sup>	
CS7W Straight blade plug, 277V, ships white <sup>5,8,11</sup>	
CS11W NEMA twist-lock plug, 277V, ships white <sup>5,8,11</sup>	
CS25W NEMA twist-lock plug, 347V, ships white <sup>5,8,11</sup>	
CS97W NEMA twist-lock plug, 480V, ships white <sup>5,8,11</sup>	
CS93W 600V SE00W white cord, no plug (no voltage required) <sup>8,11</sup>	
PLR ___ Plug-in wiring, see page 6 for ordering information	
RRL ___ RELOC <sup>®</sup> -ready luminaire. See page 5 for ordering information	
SPD Surge protection device, provides up to 6kV protection <sup>8,12</sup>	
BAA Buy America(n) Act Compliant	
<b>nLight<sup>®</sup> Wired Networking:</b>	
NES7 nLight <sup>®</sup> nES 7 PIR integral occupancy sensor	
NESPDT7 nLigh <sup>®</sup> nES PDT 7 dual technology integral occupancy control	
NES7ADCX nLight <sup>®</sup> nES 7 ADCX PIR integral occupancy sensor with automatic dimming photocell	
NESPDT7ADCX nLight <sup>®</sup> nES PDT 7 dual technology integral occupancy sensor with automatic dimming photocell	

See Accessories and footnotes on next page

Accessories: Order as separate catalog number.			
ZACVH M100	Adjustable 10' aircraft cable with Y hanger (1 pair)	HC36 M12	Hanger chain, 36" (1 pair)
ZAC120	One adjustable aircraft cable with canopy 120"	THCLX ___	Tong hanger (Must specify color) (one pair) <sup>13</sup>
ZACFP120	One adjustable aircraft cable with feed (3 conductor) and canopy, 120"	CLXANGBKT ____	Angle bracket, (one pair) <sup>13</sup>
ZACFPD120	One adjustable aircraft cable with feed (5 conductor) and canopy 120"	WGCLX24	24" wire guard, XX <sup>14</sup>
ZAC240	One adjustable aircraft cable with canopy 240"	WGCLX36	36" wire guard, XX <sup>14</sup>
ZACFP240	One adjustable aircraft cable with feed (3 conductor) and canopy, 240"	WGCLX48	448" wire guard, XX, 96" fixture requires two <sup>14</sup>
ZACFPD240	One adjustable aircraft cable with feed (5 conductor) and canopy 240"		
SQ_	Swivel stem hanger (specify length in 2" increments up to 48")		

## Notes

- |   |  |
|---|--|
| 1 Not available with OUTCTR option.   | 8 Must specify voltage.  |
| 2 Not for use with THCLX, CLXANGBKT or WGCLX accessories. Not available L24 or with RDL lens options. | 9 Not available with L24, L36, or L48.   |
| 3 Only available with general distribution.   | 10 Not available with OUTEND.  |
| 4 Available L/Lens only.  | 11 Not available with PLR.   |
| 5 Not available with PS1050 or E10WLCP.   | 12 Required with E10WLCP option.   |
| 6 Voltage selected utilizes a step-down transformer. Not available with L24, PS1050, or E10WLCP.      | 13 Not available with louvers, wireguards, or wide reflectors.                           |
| 7 Requires SPD option.  | 14 Not for use with CLX reflector accessories. XX denotes paint finish (EX. WGCLX48 WH). |

## POWER SENTRY EMERGENCY BATTERY PACKS

PS1050	<a href="https://www.acuitybrands.com/products/detail/369448/Power-Sentry/PS1050/Reduced-Profile-LED-Emergency-Battery-Pack">https://www.acuitybrands.com/products/detail/369448/Power-Sentry/PS1050/Reduced-Profile-LED-Emergency-Battery-Pack</a>	Factory installable
E10WLCP	<a href="https://www.acuitybrands.com/products/detail/755258/Power-Sentry/PS1055LCP-Battery-Pack/Constant-Power-Field-Installable-LED-Emergency-Driver">https://www.acuitybrands.com/products/detail/755258/Power-Sentry/PS1055LCP-Battery-Pack/Constant-Power-Field-Installable-LED-Emergency-Driver</a>	Field installable
PS1555LCP	<a href="https://www.acuitybrands.com/products/detail/755258/Power-Sentry/PS1055LCP-Battery-Pack/Constant-Power-Field-Installable-LED-Emergency-Driver">https://www.acuitybrands.com/products/detail/755258/Power-Sentry/PS1055LCP-Battery-Pack/Constant-Power-Field-Installable-LED-Emergency-Driver</a>	Field installable, remote mount only

## EMERGENCY LUMENS

Efficiency Package	SEF
PS1050	1400
PS1055LCP	1400
PS1555LCP	2000

**Note:** For emergency lumen output of specific model, please consult factory.

### How to Estimate Delivered Lumens in Emergency Mode

Use the formula below to estimate the delivered lumens in emergency mode.

Delivered Lumens = 1.25 x P x LPW

P = Output power of emergency driver. P = 10W for PS1050

LPW = Lumen per watt rating of the luminaire. This information is available on the ABL luminaire spec sheet.

The LPW rating is also available at [Designlight Consortium](#).

## DIMENSIONS

All dimensions are in inches (centimeters) unless otherwise indicated.  
Dimensions may vary with options or accessories.

## PALLET DIMENSIONS

Length	Approx Weight	Fixtures per pallet	Pallet Dims (L X W X H)
L24	4 lb	100	54x46x37
L36	5 lb	80	54x46x37
L48	7.5 lb	64	54x46x37
L96	14 lb	64	98x46x37

THCLX - SHIPS TWO PER ORDER,  
UTILIZES A #8 HEX HEAD SCREW AND NUT  
FIXTURE SITS 1.3 INCHES FROM STRUCTURE WHEN MOUNTED

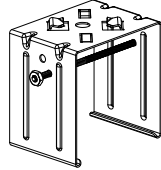

CLXANGBKT - SHIPS TWO PER ORDER  
HOLES TO MOUNTING STRUCTURE ARE 0.175" DIA, 2.5" APART  
FIXTURE SITS APPROXIMATELY 3.5" FROM STRUCTURE  
WHEN MOUNTED HORIZONTAL TO STRUCTURE

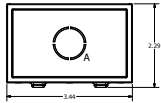
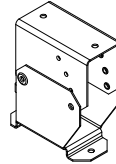

INTEGRATED SENSOR ADDS 4.75 INCHES TO STANDALONE FIXTURE LENGTH  
HOUSING END CAP ADDS 0.236 INCHES TO FIXTURE LENGTH PER SIDE

A - 7/8" KNOCK OUT  
B - 0.5" by 0.16" SLOT  
C - 0.3" DIA HOLE

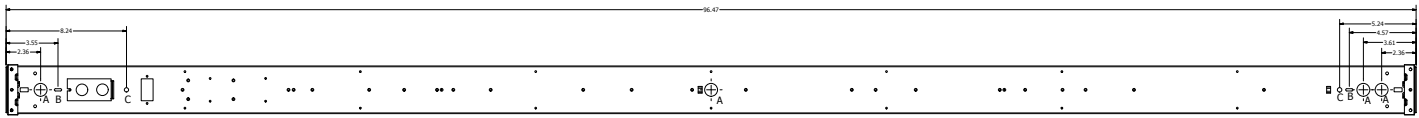

L96

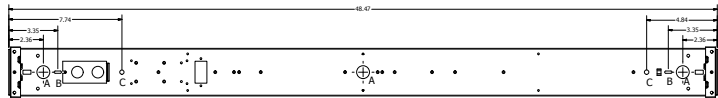

L48

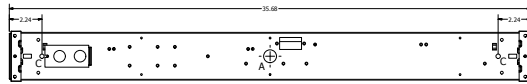

L36

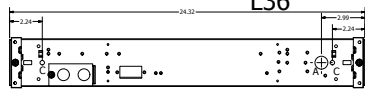

L24

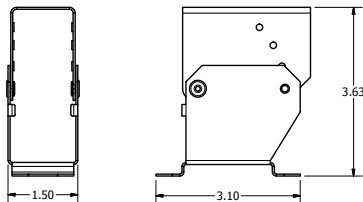
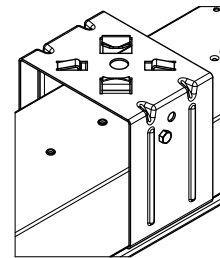
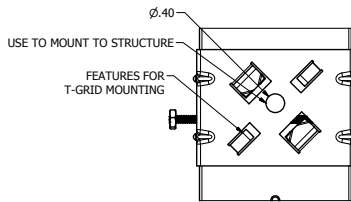
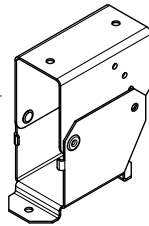
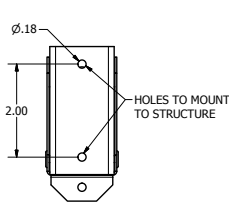

CLX ANGLE BRACKET  
(SHOWN IN THE 0 DEG POSITION)

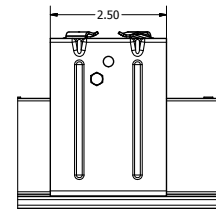
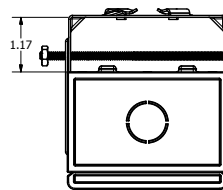

CLX MOUNTING BRACKET ASSEMBLED

## PHOTOMETRICS

See [www.lithonia.com](http://www.lithonia.com).

## RRL - RELOC®-Ready Luminaire

- RRL connectors can be used with Quick-Flex®, System 820 and OnePass® systems.
- Load side of connector factory installed to luminaire.
- 4-pole mating connector with push-in terminations allows for simple installation.
- Touch-safe design on both halves meets UL/CSA requirement.
- Wiping contact design allows safe disconnect under load.



### ORDERING INFORMATION

Lead times will vary depending on options selected. Consult with your sales representative.

**Example: RRLA**

Series	Wiring instructions
RRL RELOC®-ready luminaire	A Hot conductor wired to position #1 (phase A) B Hot conductor wired to position #2 (phase B) C Hot conductor wired to position #3 (phase C) <sup>1</sup>

### Compatible RELOC® Cables for Industrial Luminaires (ordered and shipped separately)

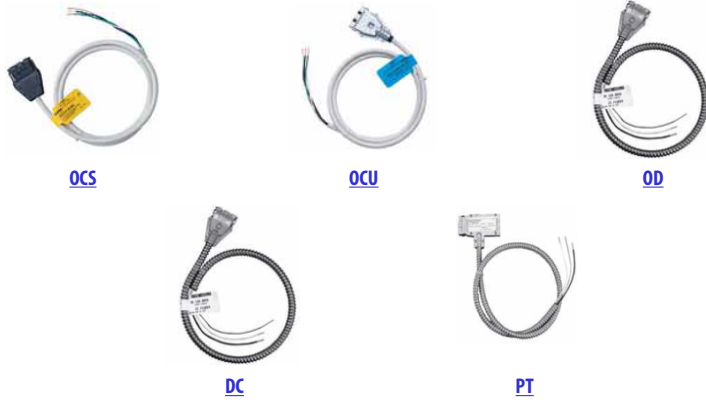

#### Notes

- <sup>1</sup> C, ABE, and C12S options are not used with Quick-Flex QFC, QSFC, QPT, and QD.

## PLUG-IN WIRING INFORMATION

Advanced plug-in system with two-circuit capability. Available on industrial and strip products and a variety of architectural products mounted in continuous rows. PLR22 (2-circuit) and crossover harness switches hot circuit serving next fixture in row. Reduces fixture types on job for alternating circuit applications (see example below.)

Easy one-step installation, saves up to 35% on labor costs. Expanded switching flexibility helps save energy.

Rows can be 50% longer with two-circuit systems. Polarized, lock-together nylon connectors prevent miswiring in the field. #12 THHN conductor, rated 600V, 90°C. White neutral wire included. Grounding accomplished by fixture in-row connectors.

CSA certified systems available with up to 2 circuits. G ground required.

Not for use with dedicated emergency circuits.

Note: Specifications subject to change without notice.



Wiring

# PLR

Advanced 1 or 2-Circuit Plug-In

**ORDERING INFORMATION** Lead times will vary depending on options selected. Consult with your sales representative.

Series	Number of hot wires	Branch circuits (PLR2A / PLR2B Only)	Dimming	Ground
PLR22	(blank) Not required for PLR22	(blank) Not required for PLR22	(blank) No Dimming	G Ground (required)
PLR	1 Black	(blank) Not required for PLR1		
	2 Black and red	<b>Circuits to which driver is connected</b> (blank) Not required for PLR22 A Black wire B Red wire  <b>Battery charging circuit (must be unswitched)</b> (blank) No battery charging circuit ELA Battery pack wired to black wire ELB Battery pack wired to red wire	LV Low-voltage Dimming	

### Typical Applications

#### Notes:

When specifying PLR1, you will not specify A or B as there is only a single hot wire which would be black in color.

- Multiple-circuit and single-circuit for longer continuous rows
- Multiple-circuit with alternating fixtures on separate circuits and 2-circuit PLR22
- Multiple circuit with night-lights located along row as desired

## LSXR PRODUCT INFORMATION

A standard occupancy time delay is also present to ensure lights turn off (once minimum on timer has also elapsed) if no occupancy is detected.

This timer is factory set at 10 minutes to promote energy savings, but is adjustable between 30 seconds and 30 minutes. These adjustments may be done through the unit's push-button.

#### FEATURES

- Four interchangeable lenses - high mount 360°, low mount 360°, high mount aisleway, and small motion 360°.
- Integrated mounting bracket drops lens down 3" from chase nipple - no bracket accessory required.
- 100% digital PIR detection - provides excellent RF immunity

Note: Specifications subject to change without notice.

Passive Infrared Indoor Occupancy Sensor



# LSXR

Single Relay

AcuityControls  
Sensor Switch

**ORDERING INFORMATION** Lead times will vary depending on options selected. Consult with your sales representative.

Example: LSXR 10 ADC HVOLT 30M

Series	Lens option	Dimming/photocell
LSXR Passive Infrared Indoor Occupancy Sensor	(blank) No lens 610 High and low mount 360° 6 High mount, 360° 650 High mount 360° and aisleway 10 Low mount, 360° 3PK High and low mount 360° and aisleway 50 High mount aisleway 4PK All lenses 9 Small motion, 360°	(blank) None HL High/low occupancy operation P Switching photocell (on/off) ADC Dimming and switching photocell ANL Dimming and switching photocell with high/low occupancy operation

Voltage	Max dim level	Min dim level	Lead length	Temp humidity	Default time delay
(blank) 120-277 VAC (MVOLT)	(blank) 10 VDC	(blank) Minimum dimming level of ballast	(blank) 14"	(blank) None	(blank) 10 minutes (with minimum 15 minutes on time)
HVOLT 347-480 VAC	9H 9 VDC	1V 1 VDC	42L 42"	LT Low temperature	5M 5 minutes (LED only)
	8H 8 VDC	2V 2 VDC			15M 15 minutes
	7H 7 VDC	3V 3 VDC			20M 20 minutes
		4V 4 VDC			30M 30 minutes
		5V 5 VDC			
		6V 6 VDC			

For additional information see [www.lithonia.com](http://www.lithonia.com)

## OPTIONS AND ACCESSORIES



**Wide decorative reflector**  
Ships separately from fixture.  
Order as:  
CLXRW24  
CLXRW36  
CLXRW48  
CLXRW96

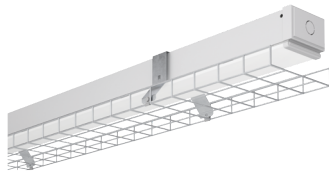

**Wireguard**  
Ships separately from fixture:  
96" fixture requires two WGCLX48.  
Order as:  
WGCLX24  
WGCLX36  
WGCLX48



**Aircraft Cable with Canopy**  
Available in 120" or 240"  
Order as:  
ZAC120  
ZAC240

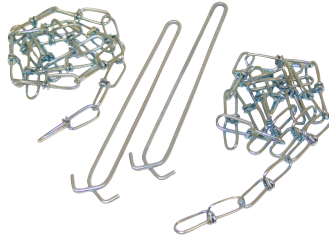

**HANGER CHAIN**  
36" chain with Y hanger. ships as a pair  
Order as:  
HC36



**ZACVH HANGER**  
10' Aircraft cable with Y hanger.  
Order as:  
ZACVH

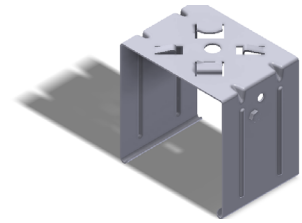

**Tong hanger**  
Ships as a pair  
Order As:  
THCLX