

CVN CABLOFIL COVER

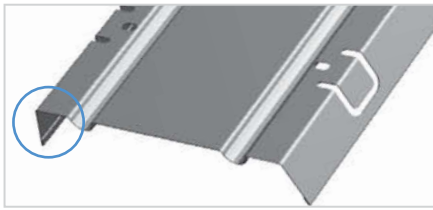

ASSEMBLY

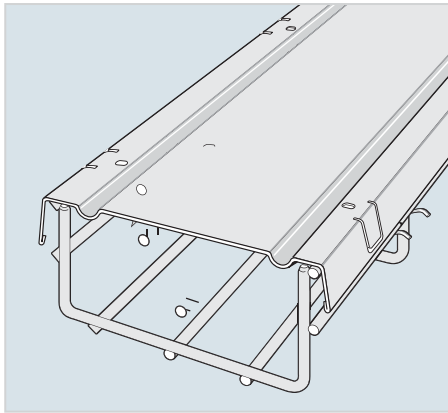
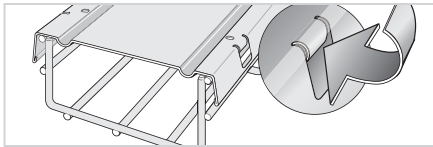

- Cover eliminates dirt and dust build-up on cable.
- Field fabricate on-site to fit changes in levels.
- Use built-in tabs for permanent attachment to tray.
- 3- 3.3' covers are included in each package to cover 1-10' section of tray.

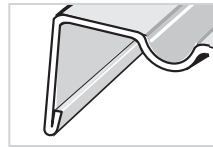

	PKG. QTY.	WIDTH		LENGTH		WEIGHT		PG	GC	316L	BL	PE
		INCHES	MM	FEET	M	LBS	KG					
CVN 50	3	2"	71	3.3'	1	2.6	1.2	629 050	629 053	629 054	941 332	934 071
CVN 100	3	4"	121	3.3'	1	4.6	2.1	629 100	629 103	629 104	941 333	934 073
CVN 150	3	6"	171	3.3'	1	7.3	3.3	629 150	629 153	629 154	941 334	934 075
CVN 200	3	8"	221	3.3'	1	9.3	4.2	629 200	629 203	629 204	941 335	934 077
CVN 300	3	12"	322	3.3'	1	13.2	6.0	629 300	629 303	629 304	941 336	934 079
CVN 450	3	18"	475	3.3'	1	22.5	10.2	629 450	629 453	*	941 338	934 083
CVN 500	3	20"	525	3.3'	1	28.4	12.9	629 500	629 503	629 504	941 339	934 085
CVN 600	3	24"	625	3.3'	1	33.1	15.0	629 600	629 603	629 604	941 340	934 087

*Product number was not available at time of print.

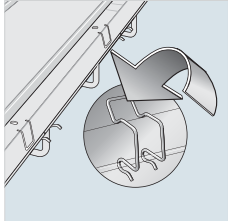

- Use CLIP F02 for installations where cover is removed frequently.

	PKG. QTY.	WEIGHT		PG	316L	BL	PE
		LBS	KG				
CLIP F02	25	2.2	1.0	646 200	646 204	942 807	942 808

COT F FLEXIBLE DIVIDER

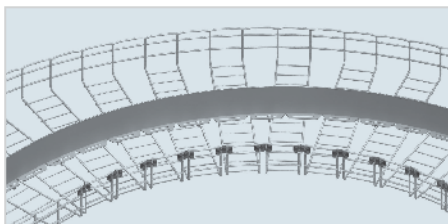

- Separates cables on sweeps and bends.
- Allows for installation of power cables and data cables within the same pathway.
- Attaches to tray using three sets of EZ BN 1/4 and CE 25.

	PKG QTY	HEIGHT		WEIGHT		PG	GC	BL	PE	304L	316L
		INCHES	MM	LBS	KG						
COTF54 KIT	1	2	54	1.07	0.49	943 423	943 424	943 426	943 427	*	943 425
COTF105 KIT	1	4	105	2.14	0.97	943 428	943 429	943 431	943 432	*	943 430
COTF150 KIT	1	6	150	3.21	1.46	943 433	943 434	943 436	943 437	*	943 435

* Product number not available at time of print

All dimensions are nominal. See product cut sheets at www.legrand.us/cablofil.

Cablofil

Finishes and Product Features

Cablofil wire cable tray and accessories are available in a variety of finishes to meet any industry need, from decorative to extreme environments. Use this chart to help you determine the best finish for your application and its availability.

FINISHES										
SYMBOL	MATERIAL	FINISH & STANDARD	<i>Interior installations</i>	<i>Exterior installations</i>	<i>Petroleum Plants Chemical Plants</i>	<i>Marine/salt, Weak sulphurous environments</i>	<i>Acidic, alkaline environments</i>	<i>Food Production, Wash-down, Clean rooms</i>	<i>Halogen environments</i>	
PG	Carbon Steel ASTM A653	Pre-Galvanized: Continuous Galvanization Before Fabrication ASTM A 653	●							
EZ	Carbon Steel ASTM A510 Grade 1008	Electrozinc: Electrozinc plating ASTM B 633	●							
GC	Carbon Steel ASTM A510 Grade 1008	Hot Dipped Galvanized: After Fabrication ASTM A 123		●	●	●	●			
DC	Carbon Steel ASTM A510 Grade 1008	Geomet: Zinc and Aluminum Protection Equivalent to Hot Dip Galvanization ASTM F 1136		●	●	●	●			
304L	Stainless Steel AISI Type 304L	Stainless Steel 304L: Cleaned and Passivated ASTM 380		●	●	●	●	●	●	●
316L	Stainless Steel AISI Type 316L	Stainless Steel 316L: Cleaned and Passivated ASTM A 380		●	●	●	●	●	●	●
BL	Carbon Steel ASTM A510 Grade 1008	Black Painted: Black Powder Coated ASTM D 3451	●							
PE	Carbon Steel ASTM A510 Grade 1008	Custom Painted: Custom Color Powder Coated ASTM D 3451	●							

For a more detailed explanation of finish standards and compatibility, visit www.legrand.us/cablofil.

● recommended ● possible

Galvanic Corrosion

Galvanic corrosion is the result of an electrochemical phenomenon due to the potential difference between different metals, or between a metal and the impurities it contains, when they are in electrical contact. Be aware of this phenomenon when selecting supports, splices and accessories. The results listed below are based on laboratory conditions and testing. However, in actual installations other conditions need to be considered to determine if significant galvanic reactions will occur.

RECOMMENDED COMPATIBILITY

Cable Tray	Accessories
EZ/PG	EZ/PG
GC	GC/DC
304 L	316 L
316 L	316 L

RECOMMENDED FOR TYPICAL CABLE TRAY

TRAY MATERIAL/FINISH	HARDWARE FINISH			
	Zinc-Plated	Geomet	GC	SS316
Steel/EZ (Electro-zinc)	●	●	●	●
Steel/GC (HDGAF)		●	●	●
Steel/BL (Painted)	●	●	●	●
Steel/PE (Painted)	●	●	●	●
Stainless-steel 304 (passive)		●	●	●
Stainless-steel 316 (passive)		●	●	●
Aluminum	●	●		●

● recommended ● acceptable

GALVANIC CORROSION TEST RESULTS:

SECONDARY MATERIAL (HARDWARE)	PRIMARY MATERIAL (TRAY)							
	Stainless 304L	Nickel	Copper	Brass	Carbon Steel	Aluminum	Chromium	Zinc
Stainless304L	0							
Nickel	180	0						
Copper	320	140	0					
Brass	400	220	80	0				
Carbon Steel	750	570	430	350	0			
Aluminum	840	660	520	440	90	0		
Chromium	950	770	630	550	200	110	0	
Zinc	1150	970	830	750	400	310	200	0

The potential differences are expressed in millivolts. Yellow shaded secondary materials in combination with primary materials listed above is not recommended.

Conditions

- | | |
|--|---|
| Lab Tests <ul style="list-style-type: none"> Submerged in seawater Equal mass materials Great connection | Typical Cable Tray Installation <ul style="list-style-type: none"> Wet/dry cycles not constant immersion Primary material may be 100 times greater Electrical current/connector |
|--|---|

CABLOFIL PRODUCT CODE

Our part number makes it easy to identify part type, size and finish. Please use this code whenever ordering or specifying any Cablofil product.

FOR TRAY:







CF	54	/	100	EZ
TYPE OF TRAY	DEPTH IN MM		WIDTH IN MM	FINISH CODE

FOR SUPPORTS AND OTHER PRODUCTS:

FASC	300	PG
PRODUCT CODE	SIZE IN MM	FINISH CODE

SYMBOLS LEGEND

Use these symbols to guide you through our catalog of innovative cable management products.

 ASSEMBLY WITHOUT NUTS AND BOLTS	 ASSEMBLY WITH NUTS AND BOLTS	 FAST ASSEMBLY	 NEW PRODUCT INNOVATION
 SAFE EDGE™	 PATENTED CABLOFIL PRODUCTS	 PATENTED FAST ASSEMBLY SYSTEM™ FAST ASSEMBLY SYSTEM	