

**Description**

The E27RTAT is a compact and efficient shallow recessed remodel Non-IC shallow housing optimized and listed for EISA compliant tungsten-halogen, CFL and LED lamps as well as incandescent. Housing is suitable for residential or light commercial applications. Installation in non-insulated ceilings. If ceiling insulation is present, it must be kept 3" from all sides of housing. Housing features Air-Tite code compliant construction. Use with a variety of trims and finishes to create different lighting effects or to match any decor. May be retrofit with compatible HALO LED lighting systems.

<b>Catalog #</b>		<b>Type</b>
<b>Project</b>		
<b>Comments</b>		<b>Date</b>
<b>Prepared by</b>		

**Specification Features**

**Housing**

- Single wall die-formed housing
- Housing features a precision rolled interlocking collar which maintains aperture geometry for greater assurance of installation results
- Integral Air-Tite gasket for code-required gasket between fixture and finished ceiling
- Shipped with socket overspray protector installed
- May be removed from the plaster frame to provide access to junction box
- Remodel Retention System - Speed Clamps
- Exclusive two integral speed clamps securely lock housing to ceiling, accommodating 3/8" to 2" ceiling materials

**Socket Plate**

- Rigid socket plate adjusts and locks without tools for various lamp sizes.
- Socket plate and bracket may be removed when using socket supporting trims

**Includes:**

**Remodel Speed Clamps**

- (2) Exclusive integral speed clamps
- Speed clamp tabs securely lock to ceiling
- Speed clamps can be loosened for easy repositioning
- Speed clamps feature internal drive screws – a power screwdriver speeds installation
- Two-tier tabs adjust for 3/8" to 2" of various ceiling materials

**Attached-Arm Design**

- Attached arm gets into tight spaces
- Ease of installing through the ceiling aperture
- Smaller footprint for packing and distributor shelf space

**Hinged junction box w/**

**Slide-N-Side™**

- (4) 1/2" conduit pry-outs
- (2) Slide-N-Side™ Non-Metallic (NM) wire traps, allow wiring outside the box
- For 14-2, 14-3, 2-2, 12-3 U.S. and 14-2, 14-3, 12-2 Canadian
- Hinged door for easy access

**Quick Connect™ Wiring Tray**

- (3) Color coded push wire nuts in captive tray for one-handed connection
- Aids in speed & reliability
- Clear caps for wire connection visibility

**cULus Listed**

- Compact 10 in³ box volume
- Listed for maximum (6) No. 12 AWG or (8) No. 14 AWG 90° C splice conductors in box

**Remodel Flange**

- Die formed flange maintains precise whole circumference
- Integral flange secures fixture against the ceiling

**Air-Tite™ code compliant**

- Certified under ASTM E283
- Exclusive gasket seals aperture, frame & ceiling
- No additional caulk required

**Socket**

- Porcelain socket with nickel plated brass screw shell
- Snap-in springs secure socket to socket plate, and may be detached when using socket supporting trims

**Thermal Protector**

- Self resetting thermal protector deactivates fixture if overheating occurs due to improper lamping or misapplied insulation

**Trims**

- Halo Fit-All concept offers multiple trim options in a variety of design styles, and functional beam distributions to control beam angle and lumen delivery in accommodating various lamp types including Halogen, CFL and LED

**Compliance**

- cULus Listed 1598 Luminaire
- cULus Listed Damp Location
- cULus Listed for Wet Location, covered ceiling, with select trims
- Air-Tite code compliant. Certified under ASTM E283; not exceeding 2.0 cfm (0.944 L/s) air leakage rate tested at a 1.57 psf (75 Pa) pressure differential
- RoHS compliant
- Options to meet Trade Agreements Act requirements



**E27RTAT**

**6" Non-IC, Air-Tite, Shallow Remodel Housing**

**E26 Screw base housing**

**Dimensions**

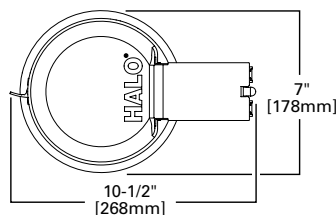
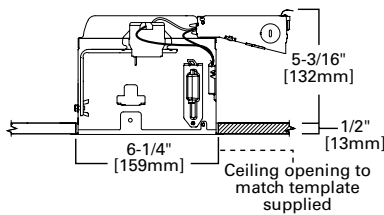

**Special Features**

- Hinged J-Box with Slide-N-Side™
- Quick Connect™ push wire nuts
- Air-Tite™ code compliant

## Ordering Information

**Sample Number:** E27RTAT 6110WB  
Order housing, trim and lamp (by others) separately for a complete luminaire.

### Domestic Preferences<sup>(1)</sup>

[Blank] = Standard  
TAA = Trade Agreements Act

### Housing

E27RTAT= 6" non-insulated ceiling, airtight recessed housing, shallow remodel, 120V

### Trims

	<p><b>Reflectors</b></p> <p><b>426 Reflector Cone</b> OD: 7-1/4" [184mm] 426=Clear Specular Reflector Cone, White Trim 426MB=Black Specular Reflector Cone, White Trim 426H=Haze Reflector Cone, White Trim 426SN=Satin Nickel Reflector Cone and Trim 426TBZ=Tuscan Bronze Reflector Cone and Trim</p>		<p><b>6109 Coilex® Tapered Baffle, Self-flange</b> OD: 7-3/4" [197mm] 6109WB=White Tapered Coilex Baffle, White Trim 6109BB=Black Tapered Coilex Baffle, White Trim 6109BKBB=Black Tapered Coilex Baffle, Black Trim</p>		<p><b>Lenses &amp; Wet Location Showerlights</b></p> <p><b>70 Albalite Lens</b> OD: 8" [203mm] 70P=Albalite Glass Lens, White Plastic Trim 70PS=Albalite Glass Lens, White Plastic Trim, Showerlight, Air-Tite</p>
	<p><b>4261 White Reflector Cone, Self-flange</b> OD: 7-1/4" [184mm] 4261P=White Reflector and Trim</p>		<p><b>6110 Perfex Baffle, Self-flange</b> OD: 7-3/4" [197mm] 6110WB=White Perfex Baffle and Trim 6110BB=Black Perfex Baffle, White Trim 6110BKBB=Black Perfex Baffle and Trim</p>		<p><b>71 Drop Opal Glass Lens</b> OD: 8" [203mm] 71P=Drop Opal Glass Lens, White Plastic Trim 71PS=Drop Opal Glass Lens, White Plastic Trim, Showerlight, Air-Tite</p>
	<p><b>6106 Straight Reflector Cone, Self-flange</b> OD: 7-3/4" [197mm] 6106SC=Specular Reflector, White Trim</p>		<p><b>6126 Shallow Full Cone Baffle, Self-flange</b> OD: 7-3/4" [197mm] 6126WB=White Baffle and Trim 6126BB=Black Baffle, White Trim</p>		<p><b>73 Fresnel Glass Lens</b> OD: 8" [203mm] 73P=Fresnel Glass Lens, White Plastic Trim 73PS=Fresnel Glass Lens, White Plastic Trim, Showerlight, Air-Tite</p>
	<p><b>6107 Tapered Reflector, Self-flange</b> OD: 7-3/4" [197mm] 6107SC=Specular Reflector, White Trim</p>		<p><b>Adjustable - Eyeballs &amp; Gimbals</b></p> <p><b>74 PAR30 Eyeball 30° Tilt, Self-flange</b> OD: 8" [203mm] 74P=White Eyeball and Trim</p>		<p><b>170 Albalite Lens with Reflector</b> OD: 8" [203mm] 170P=Frosted Albalite Glass Lens, White Trim 170PS=Frosted Albalite Glass Lens, White Plastic Trim, Showerlight, Air-Tite</p>
	<p><b>6121 Shallow Full Cone Reflector, Self-flange</b> OD: 7-3/4" [197mm] 6121WH=White Reflector and Trim</p>		<p><b>78 BR/PAR30 Eyeball 30° Tilt, Self-flange</b> OD: 8" [203mm] 78P=White Eyeball and Trim 78PAT=White Eyeball and Trim, Air-Tite 78SN=Satin Nickel Eyeball and Trim 78TBZ=Tuscan Bronze Eyeball and Trim</p>		<p><b>171 Drop Opal Lens with Reflector</b> OD: 8" [203mm] 171P=Drop Opal Glass Lens, White Trim 171PS=Drop Opal Glass Lens, White Plastic Trim, Showerlight, Air-Tite</p>
	<p><b>Baffles</b></p> <p><b>310 Coilex® Baffle</b> OD: 7-1/4" [184mm] 310W=White Coilex Baffle and Trim 310P=Black Coilex Baffle, White Trim 310SN=Black Coilex Baffle, Satin Nickel Trim 310TBZ=Black Coilex Baffle, Tuscan Bronze Trim</p>		<p><b>376 PAR30 Regressed Gimbal 30° Tilt, Self-flange</b> OD: 7-1/4" [184mm] 376W=White Baffle and Trim 376P=Black Baffle and White Trim</p>		<p><b>172 Dome Lens with Reflector</b> OD: 7-3/4" [197mm] 172PS=Frosted Glass Dome, White Plastic Trim 172SNS=Frosted Glass Dome, Satin Nickel Plastic Trim 172TBZ=Frosted Glass Dome, Tuscan Bronze Plastic Trim</p>
	<p><b>312 Coilex® Baffle</b> OD: 7-1/4" [184mm] 312W=White Coilex Baffle and Trim 312P=Black Coilex Baffle, White Trim</p>		<p><b>378 PAR30 Regressed Gimbal with Splay 25° Tilt, Self-flange</b> OD: 7-1/4" [184mm] 378P=White Splay and Trim 378=Clear Specular Splay and White Trim</p>		<p><b>173 Fresnel Lens with Reflector</b> OD: 8" [203mm] 173P=Fresnel Glass Lens, White Trim 173PS=Fresnel Glass Lens, White Plastic Trim, Showerlight, Air-Tite</p>
	<p><b>353 Metal Baffle</b> OD: 7-1/4" [184mm] 353SN=Satin Nickel Baffle and Trim 353TBZ=Tuscan Bronze Baffle and Trim</p>		<p><b>419 Regressed Eyeball with Splay 25° Tilt</b> OD: 7-1/4" [184mm] 419P=White Eyeball and Splay, White Trim</p>		<p><b>6145 Open Wet Location, Shallow Reflector, Self-flange*</b> OD: 7-3/4" [197mm] 6145WH=White Reflector and Trim 6145SN=Satin Nickel Reflector and Trim 6145TBZ=Tuscan Bronze Reflector and Trim</p>
	<p><b>6100 Tapered Metal Baffle with (2) Trim Rings</b> OD: 7-1/8" [181mm] 6100WB=White Baffle, Narrow and Wide White Trims (included) 6100BB=Black Baffle, Narrow and Wide White Trims (included)</p>		<p><b>420 BR/PAR30 Regressed Eyeball 30° Tilt, Self-flange</b> OD: 7-1/4" [184mm] 420W=White Eyeball, Baffle and Trim 420P=White Eyeball, Black Baffle, White Trim</p>		<p><b>6150 Frost Dome Glass Lens, Self-flange</b> OD: 7-3/4" [197mm] 6150WH=Frost Dome Glass Lens with Reflector, White Plastic Trim 6150SN=Frost Dome Glass Lens with Reflector, Satin Nickel Plastic Trim 6150TBZ=Frost Dome Glass Lens with Reflector, Tuscan Bronze Plastic Trim</p>
	<p><b>6101 Straight Metal Baffle with (2) Trim Rings</b> OD: 7-1/8" [181mm] 6101WB=White Baffle, Narrow and Wide White Trims (included) 6101BB=Black Baffle, Narrow and Wide White Trims (included)</p>		<p><b>6130 BR/PAR30 Eyeball 35° Tilt, Self-flange</b> OD: 7-3/4" [197mm] 6130WH=White Eyeball and Trim</p>		<p><b>6160 Drop Opal Plastic Lens, Self-flange</b> OD: 7-3/4" [197mm] 6160WH=Drop Opal Plastic Lens, White Plastic Trim</p>
	<p><b>6102 Tapered Metal Baffle, Self-flange</b> OD: 7-3/4" [197mm] 6102WB=White Baffle and Trim 6102BB=Black Baffle, White Trim</p>		<p><b>6215 PAR30 Double Gimbal 35°-50° Tilt, Self-flange</b> OD: 7-3/4" [197mm] 6215WH=White Gimbal and Trim 6215BK=Black Gimbal and Trim 6215SN=Satin Nickel Gimbal and Trim 6215TBZ=Tuscan Bronze Gimbal and Trim</p>		
	<p><b>6103 Straight Metal Baffle, Self-flange</b> OD: 7-3/4" [197mm] 6103WB=White Baffle and Trim 6103BB=Black Baffle, White Trim</p>				
	<p><b>6108 Coilex® Straight Plastic Baffle, Self-flange</b> OD: 7-3/4" [197mm] 6108WB=White Plastic Straight Coilex Baffle, White Trim 6108BB=Black Plastic Straight Coilex Baffle, White Trim 6108BKBB=Black Plastic Straight Coilex Baffle, Black Trim</p>				

**Notes:** (1) Only product configurations with this designated prefix are built to be compliant with the Trade Agreements Act of 1979 (TAA). Please refer to [DOMESTIC PREFERENCES](#) website for more information. Components shipped separately may be separately analyzed under domestic preference requirements. Accessories sold separately will be separately analyzed under domestic preference requirements. Consult factory for further information.

\*Outdoor rated lamp only (purchase separately)

## Ordering Information

**Sample Number:** E27RTAT 6110VB

Order housing, trim and lamp (by others) separately for a complete luminaire.

### Domestic Preferences<sup>(1)</sup>

[Blank] = Standard

TAA = Trade Agreements Act

### Housing

E27RTAT= 6" insulated ceiling, airtight recessed housing, remodel, 120V

## Trims



### Lenses & Wet Location Showerlights

#### 6230 Squircle Frost Curve Glass Lens.

##### Metal Trim - Showerlight

OD: 7-1/4" [183mm]

**6230AH**=Frost Curve Glass Lens, Aluminum Haze Squircle Trim

**6230PN**=Frost Curve Glass Lens, Polished Nickel Squircle Trim

**6230SN**=Frost Curve Glass Lens, Satin Nickel Squircle Trim

**6230TBZ**=Frost Curve Glass Lens, Tuscan Bronze Squircle Trim



#### 6255 Soft Square, Frost Curve Glass Lens.

##### Self-flange - Showerlight

OD: 7-1/4" [183mm]

**6255WH**=Frost Curve Glass Lens with Reflector, White Plastic Trim

**6255SN**=Frost Curve Glass Lens with Reflector, Satin Nickel Plastic Trim

**6255TBZ**=Frost Curve Glass Lens with Reflector, Tuscan Bronze Plastic Trim



### Open, Splay & Wall Wash

#### 79 Pinhole Trim

OD: 8" [203mm]

**79**=Pinhole White Trim



#### 301 Open Trim

OD: 7-1/4" [183mm]

**301P**=White Open Trim

**301SN**=Satin Nickel Open Trim

**301TBZ**=Tuscan Bronze Open Trim



#### 328 White Splay Trim

OD: 7-3/4" [197mm]

**328P**=White Splay Trim



LISTED

For use in Halo listed housings.



Select trims are classified for use in others housings.  
See [www.cooperlighting.com](http://www.cooperlighting.com)

**Notes:** (1) Only product configurations with this designated prefix are built to be compliant with the Trade Agreements Act of 1979 (TAA). Please refer to [DOMESTIC PREFERENCES](http://www.cooperlighting.com/US/Products/Accessories/Trade-Agreements-Act) website for more information. Components shipped separately may be separately analyzed under domestic preference requirements. Accessories sold separately will be separately analyzed under domestic preference requirements. Consult factory for further information.

\*Outdoor rated lamp only (purchase separately)