



# ELLIOTT ELECTRIC SUPPLY

We Deliver...Lower Cost, Quality Products, & Personal Service

3804 South Street  
75964-7263, TX Nacogdoches  
Phone: 936-569-7941  
Fax: 936-560-4685



## E4ICATSBELL 4" Ic A-T NC HSNG 120V W/SCKT BRKT *Eaton Lighting*

Catalog Number	E4ICATSBELL
Manufacturer	Eaton Lighting
Description	Remodel Housing, 120 V Ac, 420 Ma, 50 W, Aluminum, 13.75 In Width
Weight per unit	2.6 (lbs/each)
Product Category	Lighting Accessories

### Features

amperage rating	420m A
Ballast Type	N/A INCH
Lamp Included	N/A IN
Lamp Type	Halogen, Incandescent, LED, CFL (Not Included)

### Dimensions and Weight

Height	COUPLING FITTING, 316/316L STAINLESS STEEL MATERIAL; 1 INCH SIZE A; 1 INCH SIZE B; 1 SIZE A - DECIMAL; 1 SIZE B - DECIMAL; 1 SIZE A - FRACTIONAL; 1 SIZE B - FRACTIONAL; 25.4 SIZE A IN MM; 25.4 SIZE B IN MM; HOT ROLLED FORGED PROCESS
Length	7012

### Descriptions

Description	4" IC A-T NC HSNG 120V W/SCKT BRKT
Special Features	For use in insulated ceilings

### Manufacturer Information

Brand	HALO
GTIN	00080083751525
sub brand	E4ICATSB
UPC	080083751525

### Taxonomies, Classifications, and Categories

Category Description	All Recessed Cans & Trims
Type	4" E4 Housing

### Packaging

Carton	1
Package	144
Weight Per each	2.63

### Uses, Certifications, and Standards

Mounting	Recessed
----------	----------

**Description**

The E4ICATSB is an IC Air-Tite™ housing optimized and listed for EISA compliant tungsten-halogen lamps, CFL and LED lamps as well as incandescent. Housing features an adjustable socket bracket, and is suitable for residential or commercial applications. Installation in insulated ceilings\* and non-insulated ceilings with Air-Tite code compliant construction. May be retrofit with compatible Halo LED lighting systems.

Catalog #		Type
Project		
Comments		Date
Prepared by		

**Specification Features**

**Housing**

- Outer Housing - Aluminum construction
- Inner Housing - Double wall aluminum construction helps dissipate heat.
- The inner housing can be removed from the plaster frame to provide access to the junction box.
- For insulated ceilings in direct contact with insulation.\* (May also be installed in non-insulated ceilings.)

**Plaster Frame**

- Plaster frame includes locking screw for hanger bars and cutouts for crimping hanger bars in position.
- Air-Tite gasket is pre-installed.

**Junction Box**

- Positioned to accommodate straight conduit runs
- Seven conduit knockouts are uniform 1/2" size with true pry-out slots
- Four pry-outs with integral strain relief simplify "NM" non-metallic sheathed cable installation
- Three quick connect wire connectors included

**Includes:**

- **All Nail!™**
  - Integral precisely positioned nail for engineered and natural framing
  - Mini-foot leveling flange
  - Integral T-Grid Clip, no accessory clips required

**Quick Connect™**

- (3) Push wire nuts included, for speed & reliability
- Clear caps for wire connection visibility

**Air-Tite™ code compliant**

- ASTM E283 compliant

**Socket**

- Adjustable position bracket with porcelain socket and nickel plated brass screw shell provides flexibility in lamp positioning.

**Thermal Protector**

- Self resetting thermal protector deactivates fixture if overheating occurs due to improper lamping or misapplied insulation.

**Trims**

- Halo Fit-All concept offers multiple trim options in a variety of design styles, and functional beam distributions to control beam angle and lumen delivery in accommodating various lamp types

**Compliance**

- cULus Listed 1598 Luminaire
- cULus Damp Location Listed
- cULus Listed for Wet Location, covered ceiling, with select trims
- cULus listed for direct contact with insulation and combustible material\*
- RoHS Compliant
- Air-Tite code compliant. Certified under ASTM E283; not exceeding 2.0 cfm (0.944 L/s) air leakage rate tested at a 1.57 psf (75 Pa) pressure differential

\*Not to be used in direct contact with spray foam insulation (consult NEMA LSD57-2013)



**E4ICATSB**

**4" Insulated Ceiling AIR-TITE Recessed Housing with Adjustable Socket Bracket**

**4" Trims**

**FOR USE IN INSULATED CEILINGS**

**FOR DIRECT CONTACT WITH INSULATION\***

**AIR-TITE HOUSING RESTRICTS AIRFLOW BETWEEN CONDITIONED AND UNCONDITIONED AREAS**

**Dimensions**

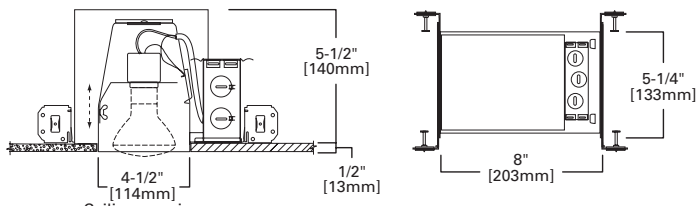

**Special Features**

- All-Nail!™ bar hangers
- Quick Connect™ push wire nuts
- Air-Tite™ code compliant

## Ordering Information

Sample Number: E4ICATSB 4003SC

Order housing, trim and lamp (by others) separately for a complete luminaire.

## Housing

E4ICATSB = 4" insulated ceiling AIR-TITE housing with adjustable socket bracket

## Trims

### Reflectors



#### 999 Reflector Cone

OD: 5-1/16" [129mm]

999P=Specular Clear, White Trim Ring  
 999RG=Residential Gold, White Trim Ring  
 999W=White Reflector, White Trim Ring  
 999H=Haze Reflector, White Trim Ring  
 999MB=Specular Black Reflector,  
 White Trim Ring  
 999SN=Satin Nickel Reflector with Satin  
 Nickel Trim Ring  
 999TBZ=Tuscan Bronze Reflector with  
 Tuscan Bronze Trim Ring



#### 4003 Reflector Cone

OD: 4-3/4" [120mm]

4003SC=Specular Clear Reflector, White Trim Ring

### Baffles



#### 953 Metal Baffle

OD: 5-1/16" [129mm]

953P=Black Baffle with White Trim Ring  
 953W=White Baffle with White Trim Ring  
 953SN=Satin Nickel Baffle with Satin Nickel  
 Trim Ring  
 953TBZ=Tuscan Bronze Baffle with Tuscan  
 Bronze Trim Ring



#### 993 Coiled Baffle

OD: 5-1/16" [129mm]

993P=Black Baffle with White Trim Ring  
 993W=White Baffle with White Trim Ring  
 993SN=Black Baffle with Satin Nickel  
 Trim Ring  
 993TBZ=Black baffle with Tuscan  
 Bronze Trim Ring



#### 4001 Step Baffle

OD: 4-3/4" [120mm]

4001BB=Black Plastic Baffle, White Trim Ring  
 4001WB=White Plastic Baffle, White Trim Ring



#### 4010 Metal Baffle

OD: 5" [127mm]

4010BB=Black Metal Baffle, White Trim Ring  
 4010WB=White Metal Baffle, White Trim Ring



#### 4013 Metal Baffle

OD: 5" [127mm]

4013BB=Black Metal Baffle, White Trim Ring  
 4013WB=White Metal Baffle, White Trim Ring

### Adjustable



#### 996 Eyeball 15° Tilt

OD: 5-1/16" [129mm]

996P=White Eyeball  
 996SN=Satin Nickel Eyeball  
 996TBZ=Tuscan Bronze Eyeball



#### 998 Eyeball 30° Tilt

OD: 5-1/16" [129mm]

998P=White Eyeball  
 998SN=Satin Nickel Eyeball  
 998TBZ=Tuscan Bronze Eyeball



#### 4002 Eyeball

OD: 4-3/4" [120mm]

4002WH=White Eyeball

### Lens / Wet Location Listed



#### 951 Prismatic Glass Lens with Full Cone Reflector

951PS=Full Reflector and Glass Lens,  
 White Trim  
 951SNS=Full Reflector and Glass Lens,  
 Satin Nickel Trim  
 951TBZS=Full Reflector and Glass Lens,  
 Tuscan Bronze Trim



#### 952 Cone Reflector

952PS=White Trim Ring, Dome Lens  
 Shower Light



#### 945 Metropolitan Ice Light

OD: 5-5/16" [135mm]

945=Clear Frosted  
 945Blue=Blue Frosted



#### 4055 Prismatic Glass Lens Shower Light

OD: 4-3/4" [120mm]

4055WH=Shower Light, White Trim Ring,  
 Prismatic Flat Glass Lens



LISTED

For use in Halo listed housings.