

Description

The E4ICATSB is an IC Air-Tite™ housing optimized and listed for EISA compliant tungsten-halogen lamps, CFL and LED lamps as well as incandescent. Housing features an adjustable socket bracket, and is suitable for residential or commercial applications. Installation in insulated ceilings* and non-insulated ceilings with Air-Tite code compliant construction. May be retrofit with compatible Halo LED lighting systems.

Catalog #		Type
Project		
Comments		Date
Prepared by		

Specification Features

Housing

- Outer Housing - Aluminum construction
- Inner Housing - Double wall aluminum construction helps dissipate heat.
- The inner housing can be removed from the plaster frame to provide access to the junction box.
- For insulated ceilings in direct contact with insulation.* (May also be installed in non-insulated ceilings.)

Plaster Frame

- Plaster frame includes locking screw for hanger bars and cutouts for crimping hanger bars in position.
- Air-Tite gasket is pre-installed.

Junction Box

- Positioned to accommodate straight conduit runs
- Seven conduit knockouts are uniform 1/2" size with true pry-out slots
- Four pry-outs with integral strain relief simplify "NM" non-metallic sheathed cable installation
- Three quick connect wire connectors included

Includes:

- **All Nail!™**
 - Integral precisely positioned nail for engineered and natural framing
 - Mini-foot leveling flange
 - Integral T-Grid Clip, no accessory clips required

Quick Connect™

- (3) Push wire nuts included, for speed & reliability
- Clear caps for wire connection visibility

Air-Tite™ code compliant

- ASTM E283 compliant

Socket

- Adjustable position bracket with porcelain socket and nickel plated brass screw shell provides flexibility in lamp positioning.

Thermal Protector

- Self resetting thermal protector deactivates fixture if overheating occurs due to improper lamping or misapplied insulation.

Trims

- Halo Fit-All concept offers multiple trim options in a variety of design styles, and functional beam distributions to control beam angle and lumen delivery in accommodating various lamp types

Compliance

- cULus Listed 1598 Luminaire
- cULus Damp Location Listed
- cULus Listed for Wet Location, covered ceiling, with select trims
- cULus listed for direct contact with insulation and combustible material*
- RoHS Compliant
- Air-Tite code compliant. Certified under ASTM E283; not exceeding 2.0 cfm (0.944 L/s) air leakage rate tested at a 1.57 psf (75 Pa) pressure differential

*Not to be used in direct contact with spray foam insulation (consult NEMA LSD57-2013)



E4ICATSB

**4" Insulated Ceiling
AIR-TITE Recessed
Housing with Adjustable
Socket Bracket**

4" Trims



**FOR USE IN INSULATED
CEILING**

**FOR DIRECT CONTACT
WITH INSULATION***

**AIR-TITE HOUSING
RESTRICTS AIRFLOW
BETWEEN CONDITIONED
AND UNCONDITIONED
AREAS**

Dimensions

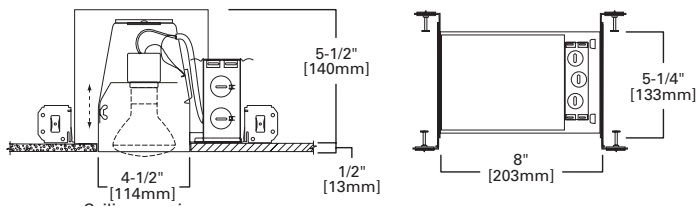

Special Features

- All-Nail!™ bar hangers
- Quick Connect™ push wire nuts
- Air-Tite™ code compliant

Ordering Information

Sample Number: E4ICATSB 4003SC

Order housing, trim and lamp (by others) separately for a complete luminaire.

Housing

E4ICATSB = 4" insulated ceiling AIR-TITE housing with adjustable socket bracket

Trims

Reflectors



999 Reflector Cone

OD: 5-1/16" [129mm]

999P=Specular Clear, White Trim Ring
 999RG=Residential Gold, White Trim Ring
 999W=White Reflector, White Trim Ring
 999H=Haze Reflector, White Trim Ring
 999MB=Specular Black Reflector,
 White Trim Ring
 999SN=Satin Nickel Reflector with Satin
 Nickel Trim Ring
 999TBZ=Tuscan Bronze Reflector with
 Tuscan Bronze Trim Ring



4003 Reflector Cone

OD: 4-3/4" [120mm]

4003SC=Specular Clear Reflector, White Trim Ring

Baffles



953 Metal Baffle

OD: 5-1/16" [129mm]

953P=Black Baffle with White Trim Ring
 953W=White Baffle with White Trim Ring
 953SN=Satin Nickel Baffle with Satin Nickel
 Trim Ring
 953TBZ=Tuscan Bronze Baffle with Tuscan
 Bronze Trim Ring



993 Coiled Baffle

OD: 5-1/16" [129mm]

993P=Black Baffle with White Trim Ring
 993W=White Baffle with White Trim Ring
 993SN=Black Baffle with Satin Nickel
 Trim Ring
 993TBZ=Black baffle with Tuscan
 Bronze Trim Ring



4001 Step Baffle

OD: 4-3/4" [120mm]

4001BB=Black Plastic Baffle, White Trim Ring
 4001WB=White Plastic Baffle, White Trim Ring



4010 Metal Baffle

OD: 5" [127mm]

4010BB=Black Metal Baffle, White Trim Ring
 4010WB=White Metal Baffle, White Trim Ring



4013 Metal Baffle

OD: 5" [127mm]

4013BB=Black Metal Baffle, White Trim Ring
 4013WB=White Metal Baffle, White Trim Ring

Adjustable



996 Eyeball 15° Tilt

OD: 5-1/16" [129mm]

996P=White Eyeball
 996SN=Satin Nickel Eyeball
 996TBZ=Tuscan Bronze Eyeball



998 Eyeball 30° Tilt

OD: 5-1/16" [129mm]

998P=White Eyeball
 998SN=Satin Nickel Eyeball
 998TBZ=Tuscan Bronze Eyeball



4002 Eyeball

OD: 4-3/4" [120mm]

4002WH=White Eyeball

Lens / Wet Location Listed



951 Prismatic Glass Lens with Full Cone Reflector

951PS=Full Reflector and Glass Lens,
 White Trim
 951SNS=Full Reflector and Glass Lens,
 Satin Nickel Trim
 951TBZS=Full Reflector and Glass Lens,
 Tuscan Bronze Trim



952 Cone Reflector

952PS=White Trim Ring, Dome Lens
 Shower Light



945 Metropolitan Ice Light

OD: 5-5/16" [135mm]

945=Clear Frosted
 945Blue=Blue Frosted



4055 Prismatic Glass Lens Shower Light

OD: 4-3/4" [120mm]

4055WH=Shower Light, White Trim Ring,
 Prismatic Flat Glass Lens



LISTED

For use in Halo listed housings.