



CATALOG NUMBER:

JOB NAME:

CUSTOMER NAME:

NOTES:

TYPE:

DATE:

FEATURES AND SPECIFICATIONS

FLOOD LIGHTING

FLDX16 SERIES

16" DIE CAST COMPACT FLOOD LIGHT

Wattages:

Pulse Start: 250w - 400w ⓔ

High Pressure Sodium: 250w - 400w

Construction:

Die Cast Aluminum Housing

Hinged Face Frame

Optics:

Uses Standard Size Lamp

Electrical:

Pre-wired with Cord

Easy Access Wiring Compartment

Wiring Compartment

UL Listed for Wet Locations

Mounting:

UL Listed for Ground Mounting

Trunion Mount

Specifications:

Overall height: 10.27" (26.09 cm)

Width: 16.25" (41.28 cm)

Weight: 29 lbs / 13.15 kg.

Warranty:

Atlas Lighting Products provides a 3 year limited warranty for this product.

A full warranty can be found at www.alpinc.com.

ACCESSORIES

320-001	Glare Shield for FLDX - Bronze
320-002	Wireguard for FLDX
320-004	Large Trunion for FLDX - Bronze
320-035BZ	Slipfitter for FLDX - Bronze
210-002	Face Frame Assembly for FLDX - Bronze

ORDERING INFORMATION

Choose the boldface catalog nomenclature that best suits your needs and write it on the appropriate line. Order accessories as separate catalog numbers (shipped separately).

example:

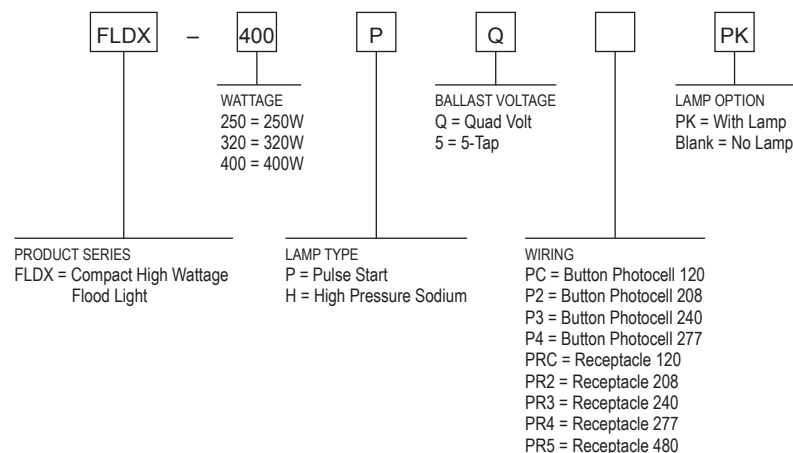

Actual performance can vary depending on operating conditions. Specifications are subject to change without notice.

ATLAS LIGHTING PRODUCTS, INC.

PO BOX 2348 | BURLINGTON, NC 27216

800-849-8485 | FAX: 336-227-0110 | www.atlaslightingproducts.com



FLOOD LIGHTING
FLDX16 SERIES
16" DIE CAST COMPACT FLOOD LIGHT

DIMENSIONS

Specifications:

Overall height:
10.27" (26.09 cm)

Width:
16.25" (41.28 cm)

Weight:
29 lbs /13.15 kg.

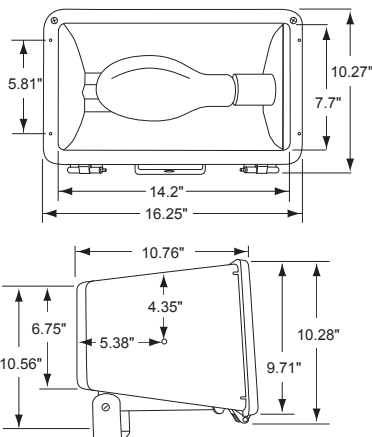

PHOTOMETRICS

400W PS @ 25' Mounting Height

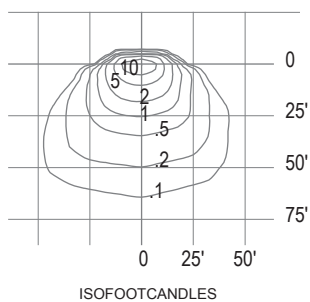

MOUNTING DETAILS

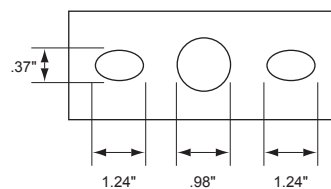

Actual performance can vary depending on operating conditions. Specifications are subject to change without notice.

ATLAS LIGHTING PRODUCTS, INC.

PO BOX 2348 | BURLINGTON, NC 27216

800-849-8485 | FAX: 336-227-0110 | www.atlaslightingproducts.com



CATALOG NUMBER:

JOB NAME:

CUSTOMER NAME:

NOTES:

TYPE:

DATE:

FEATURES AND SPECIFICATIONS

FLOOD LIGHTING

FLDX16 SERIES

16" DIE CAST COMPACT FLOOD LIGHT

Wattages:

Pulse Start: 250w - 400w ⓔ

High Pressure Sodium: 250w - 400w

Construction:

Die Cast Aluminum Housing

Hinged Face Frame

Optics:

Uses Standard Size Lamp

Electrical:

Pre-wired with Cord

Easy Access Wiring Compartment

Wiring Compartment

UL Listed for Wet Locations

Mounting:

UL Listed for Ground Mounting

Trunion Mount

Specifications:

Overall height: 10.27" (26.09 cm)

Width: 16.25" (41.28 cm)

Weight: 29 lbs / 13.15 kg.

Warranty:

Atlas Lighting Products provides a 3 year limited warranty for this product.

A full warranty can be found at www.alpinc.com.

ACCESSORIES

320-001	Glare Shield for FLDX - Bronze
320-002	Wireguard for FLDX
320-004	Large Trunion for FLDX - Bronze
320-035BZ	Slipfitter for FLDX - Bronze
210-002	Face Frame Assembly for FLDX - Bronze

ORDERING INFORMATION

Choose the boldface catalog nomenclature that best suits your needs and write it on the appropriate line. Order accessories as separate catalog numbers (shipped separately).

example:

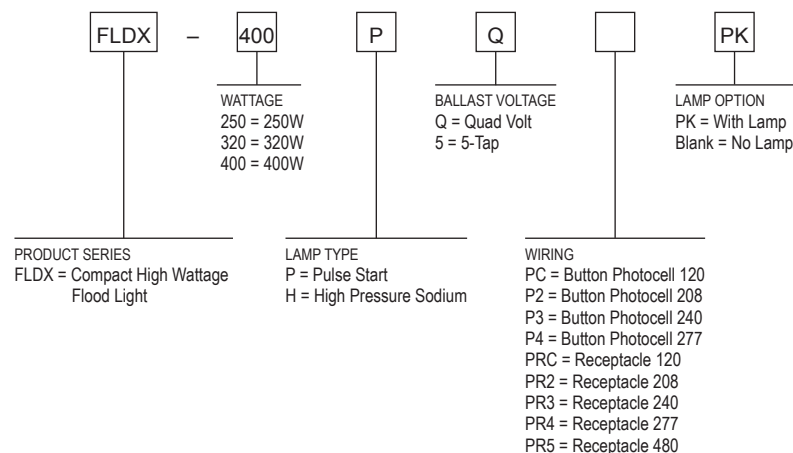

Actual performance can vary depending on operating conditions. Specifications are subject to change without notice.

ATLAS LIGHTING PRODUCTS, INC.

PO BOX 2348 | BURLINGTON, NC 27216

800-849-8485 | FAX: 336-227-0110 | www.atlaslightingproducts.com



FLOOD LIGHTING
FLDX16 SERIES
16" DIE CAST COMPACT FLOOD LIGHT

DIMENSIONS

Specifications:

Overall height:
10.27" (26.09 cm)

Width:
16.25" (41.28 cm)

Weight:
29 lbs /13.15 kg.

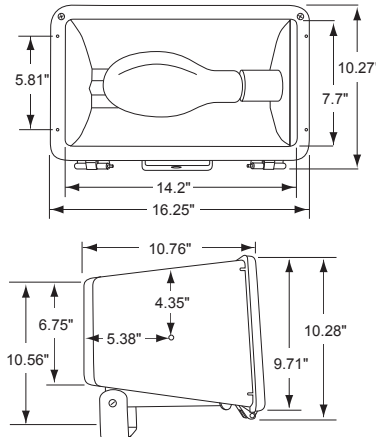

PHOTOMETRICS

400W PS @ 25' Mounting Height

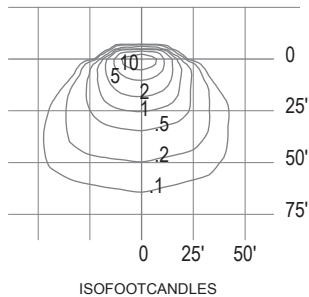

MOUNTING DETAILS

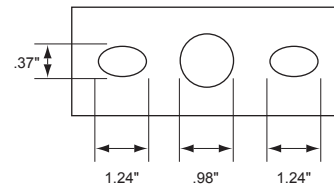

Actual performance can vary depending on operating conditions. Specifications are subject to change without notice.

ATLAS LIGHTING PRODUCTS, INC.

PO BOX 2348 | BURLINGTON, NC 27216

800-849-8485 | FAX: 336-227-0110 | www.atlaslightingproducts.com