

Description

The Halo H995RICAT is a dedicated LED remodel small aperture IC Air-Tite housing for use with Halo RA4, RL4, LT4, ML4 series LED modules and may be used with SLD4 series with the SLD spring kit. It is designed for installation into existing insulated ceilings where it will be in direct contact with insulation*. It is an Air-Tite housing designed to restrict air flow between conditioned spaces and unconditioned areas. The LED connection is non-screw base to preserve the high efficacy rating of the luminaire.

Catalog #	Type
Project	
Comments	Date
Prepared by	

Specification Features

Housing

- Single wall formed aluminum construction. Openings are gasketed for Air-Tite installation
- 5-1/2" height allows use in shallow joist construction
- Air-Tite aperture gasket is pre-installed

Remodel Arm

Spring steel construction designed for ease of installation and ceiling support

Remodel Springs

Four remodel clips secure housing and accommodate 1/2" and 5/8" ceiling material

Includes:

Slide-N-Side™

- (3) Slide-N-Side™ wire traps allow non-metallic (NM) sheathed cable to be installed without tools or without removing knockouts
 - Allows wiring connections to be made outside the junction box
 - Simply insert the cable directly into the trap after connections are made
- Accommodates the following standard non-metallic (NM) sheathed cable types for both U.S. and Canada:
 - (US) #14/2, #14/3, #12/2, #12/3
 - (Canada) #14/2, #14/3, #12/2

- (7) 1/2" conduit pry-outs positioned to accommodate straight conduits runs [(4) 1/2" conduit pry-outs in Non-IC housing]
- cULus Listed 24 in³ box volume, listed for through-branch (8) No. 12 AWG branch circuit 90 °C conductors through the box

Quick Connect™

- (3) Push wire nuts included, for speed & reliability
- Clear caps for wire connection visibility

Air-Tite™ code compliant

- ASTM E283 compliant

LED Module Connection

Compatible Halo LED modules simply install with a plug-in line voltage wiring connector (UL and CSA Listed Luminaire Disconnect). This non-screw base LED connection preserves the high efficacy rating of the luminaire (see also LED Module specifications).

Compliance

- cULus Listed 1598 Luminaire
- cULus Damp Location Listed
- cULus Listed for Wet Location, covered ceiling, with select trims
- cULus listed for direct contact with insulation and combustible material*
- Use with designated Halo LED

systems for ENERGY STAR® certification

- Can be used for State of California Title 24 high efficacy compliance with designated Halo LED lighting systems
- Can be used for International Energy Conservation Code (IECC) high efficacy compliance with designated Halo LED lighting systems
- Air-Tite code compliant. Certified under ASTM E283; not exceeding 2.0 cfm (0.944 L/s) air leakage rate tested at a 1.57 psf (75 Pa) pressure differential
- Options to meet Trade Agreements Act requirements

*Not to be used in direct contact with spray foam insulation (consult NEMA LSD57-2013)



H995RICAT

**4" Insulated Ceiling
AIR-TITE, Remodel
LED Housing**

**For Halo LED
Modules and Trims**

- RA4 Series
- RL4 Series
- RSQ4 Series
- SLD4 Series
- SMD4 Series
- LA4 Series
- LT4 Series
- ML4 Series



Dimensions

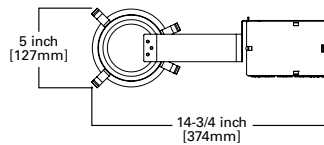
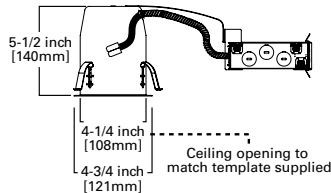

**FOR USE IN INSULATED
CEILING**

**FOR DIRECT CONTACT
WITH INSULATION***

**AIR-TITE HOUSING
RESTRICTS AIRFLOW
BETWEEN CONDITIONED
AND UNCONDITIONED
AREAS**

Special Features

Slide-N-Side™ junction box
Quick Connect™ push wire nuts
Air-Tite™ code compliant

Ordering Information

Sample Number: H995RICAT RL460VWH
Order housing, trim and lamp (by others) separately for a complete luminaire.

Domestic Preferences⁽¹⁾

[Blank] = Standard
TAA = Trade Agreements Act

Housing

H995RICAT = 4"insulated ceiling AIR-TITE LED remodel housing

LED Compatibility

Can also be used with the following LED Modules:

- LT4 = 4" LED retrofit module
- LA4 = 4" LED adjustable retrofit module
- RL4 = 4" all-purpose retrofit LED retrofit module
- RA4 = 4" adjustable gimbal all-purpose LED retrofit module
- RSQ4 = 4" all-purpose square retrofit LED retrofit module
- ML4 = 4" LED module (see ML4 spec sheets for trim options)
- SLD4 = 4" surface LED downlight
- SMD4 = 4" surface LED downlight

Notes: (1) Only product configurations with this designated prefix are built to be compliant with the Trade Agreements Act of 1979 (TAA). Please refer to [DOMESTIC PREFERENCES](#) website for more information. Components shipped separately may be separately analyzed under domestic preference requirements. Accessories sold separately will be separately analyzed under domestic preference requirements. Consult factory for further information.
*Outdoor rated lamp only (purchase separately)