

**COUPLINGS, TYPE KC**

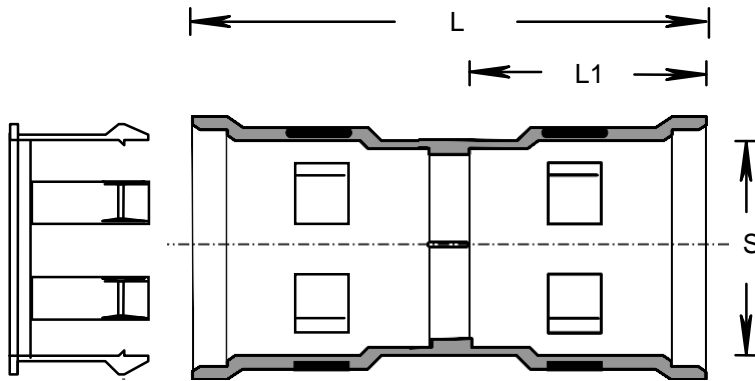

**CONNECTOR (WITH OR W/O LOCKNUT), TYPE KTA**

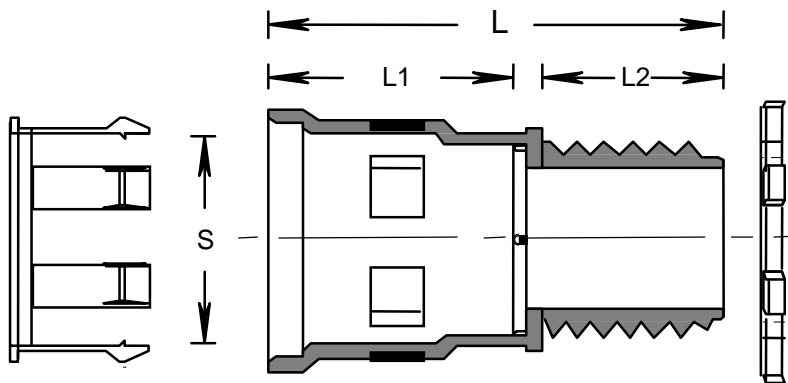

**SNAP-IN CONNECTOR, TYPE KTS**

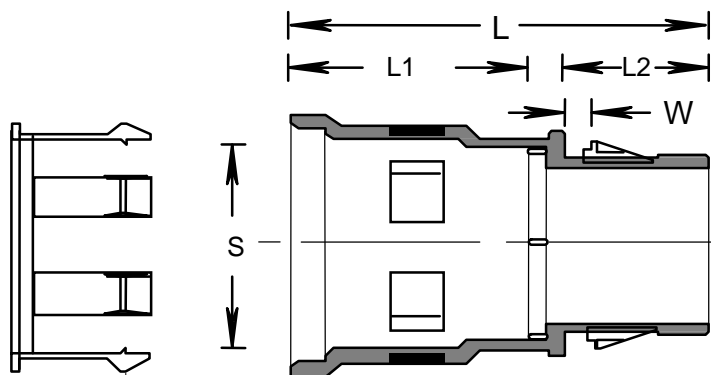

RIGID PVC CONDUIT FITTINGS

KWIKON FITTINGS

ISSUE DATE:  
DATE D'EMISSION: 2014 05 20

SUPERCEDES:  
REPLACE: 2014 02 11

**TRANSITION COUPLING, TYPE KTC**

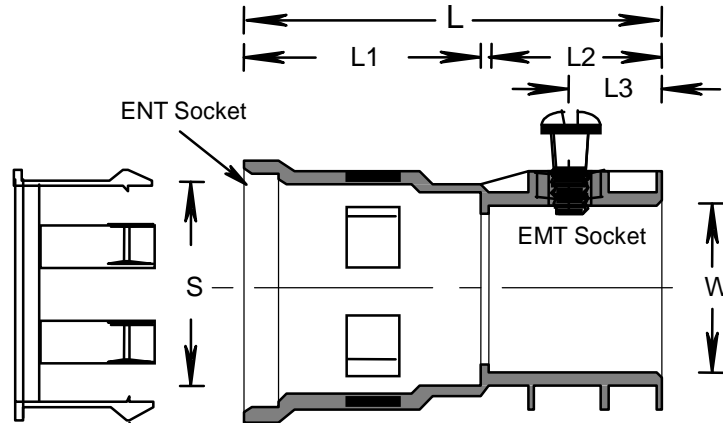

**DIMENSIONS:**

PRODUCT CODE	PART NUMBER	NOMINAL SIZE		L		L1		L2	
		(in)	(mm)	(in)	(mm)	(in)	(mm)	(in)	(mm)
089000	KC10	1/2	16	1.980	50.3	0.930	23.6	-	-
089001	KC15	3/4	21	2.035	51.7	0.945	24.0	-	-
089002	KC20	1	27	2.335	59.3	1.080	27.4	-	-
189670*	KC25	1 ¼	35	2.935	74.5	1.370	74.5	-	-
189671*	KC30	1 ½	41	2.495	63.4	1.150	63.4	-	-
189672*	KC35	2	53	2.350	59.7	1.065	59.7	-	-
089006	KTA10	1/2	16	1.490	37.8	0.930	23.6	0.450	11.4
089007	KTA15	3/4	21	1.770	45.0	0.960	24.4	0.680	17.3
089008	KTA20	1	27	1.885	47.9	1.060	26.9	0.660	16.8
089009	KTA10	1/2	16	1.490	37.8	0.930	23.6	0.450	11.4
089010	KTA15	3/4	21	1.770	45.0	0.960	24.4	0.680	17.3
089011	KTA20	1	27	1.885	47.9	1.060	26.9	0.660	16.8
189680*	KTA25	1 ¼	35	2.190	55.6	1.440	36.6	0.650	16.5
189681*	KTA30	1 ½	41	1.965	49.9	1.140	29.0	0.655	16.6
189682*	KTA35	2	53	1.895	48.1	1.065	27.1	0.655	16.6
089146	KTS10	1/2	16	1.980	50.3	0.950	24.1	0.950	24.1
089147	KTS15	3/4	21	1.760	44.0	0.880	22.9	0.980	24.9
089148	KTS20	1	27	1.900	48.3	0.950	24.1	0.950	28.6
089012	KTC10	1/2	16	1.965	49.9	0.960	24.4	0.945	24.0
089013	KTC15	3/4	21	2.035	51.7	0.980	24.9	0.975	24.8
089014	KTC20	1	27	2.335	59.5	1.125	28.6	1.120	28.5

RIGID PVC CONDUIT FITTINGS

ISSUE DATE:  
DATE D'EMISSION: 2014 05 20

KWIKON FITTINGS

SUPERCEDES:  
REPLACE: 2014 02 11

4

PRODUCT CODE	PART NUMBER	NOMINAL SIZE		L3		W		S	
		(in)	(mm)	(in)	(mm)	(in)	(mm)	(in)	(mm)
089000	KC10	1/2	16	-	-	-	-	0.860	21.8
089001	KC15	3/4	21	-	-	-	-	1.060	26.9
089002	KC20	1	27	-	-	-	-	1.330	33.8
189670*	KC25	1 ¼	35	-	-	-	-	1.690	42.9
189671*	KC30	1 ½	41	-	-	-	-	1.930	49.0
189672*	KC35	2	53	-	-	-	-	2.410	61.2
089006	KTA10	1/2	16	-	-	-	-	0.860	21.8
089007	KTA15	3/4	21	-	-	-	-	1.060	26.9
089008	KTA20	1	27	-	-	-	-	1.330	33.8
089009	KTA10	1/2	16	-	-	-	-	0.860	21.8
089010	KTA15	3/4	21	-	-	-	-	1.060	26.9
089011	KTA20	1	27	-	-	-	-	1.330	33.8
189680*	KTA25	1 ¼	35	-	-	-	-	1.690	42.9
189681*	KTA30	1 ½	41	-	-	-	-	1.930	49.0
189682*	KTA35	2	53	-	-	-	-	2.405	61.1
089146	KTS10	1/2	16	-	-	0.105	2.67	0.860	21.8
089147	KTS15	3/4	21	-	-	0.105	2.67	1.060	26.9
089148	KTS20	1	27	-	-	0.105	2.67	1.330	33.8
089012	KTC10	1/2	16	0.560	14.2	0.700	17.8	0.860	21.8
089013	KTC15	3/4	21	0.560	14.2	0.960	24.4	1.060	26.9
089014	KTC20	1	27	0.560	14.2	1.200	30.5	1.330	33.8

**RIGID PVC CONDUIT FITTINGS**

**ISSUE DATE:**  
**DATE D'EMISSION:** 2014 05 20

**KWIKON FITTINGS**

**SUPERCEDES:**  
**REPLACE:** 2014 02 11

4

PRODUCT CODE	PART NUMBER	NOMINAL SIZE		BODY CODE	RETAINER CODE	LOCKNUT CODE
		(in)	(mm)			
089000	KC10	1/2	16	091500	091987 (2)	-
089001	KC15	3/4	21	091501	091988 (2)	-
089002	KC20	1	27	091502	091989 (2)	-
189670*	KC25	1 ¼	35	091670	091992 (2)	-
189671*	KC30	1 ½	41	091671	091993 (2)	-
189672*	KC35	2	53	091672	091994 (2)	-
089006	KTA10	1/2	16	091506	091987 (1)	072531 (1)
089007	KTA15	3/4	21	091507	091988 (1)	072532 (1)
089008	KTA20	1	27	091508	091989 (1)	072533 (1)
189680*	KTA25	1 ¼	35	091980	091992 (1)	178285 (1)
189681*	KTA30	1 ½	41	091981	091993 (1)	178286 (1)
189682*	KTA35	2	53	091982	091994 (1)	178287 (1)
089009	KTA10	1/2	16	091506	091987 (1)	-
089010	KTA15	3/4	21	091507	091988 (1)	-
089011	KTA20	1	27	091508	091989 (1)	-
089146	KTS10	1/2	16	091515	091987 (1)	-
089147	KTS15	3/4	21	091516	091988 (1)	-
089148	KTS20	1	27	091517	091989 (1)	-
089012**	KTC10	1/2	16	091512	091987 (1)	-
089013**	KTC15	3/4	21	091513	091988 (1)	-
089014**	KTC20	1	27	091514	091989 (1)	-

\*\* COMES WITH ONE 8 X 7/16 PAN COMB TYPE B STEEL ZINC PLATED SCREW

**COUPLINGS, TYPE KC**

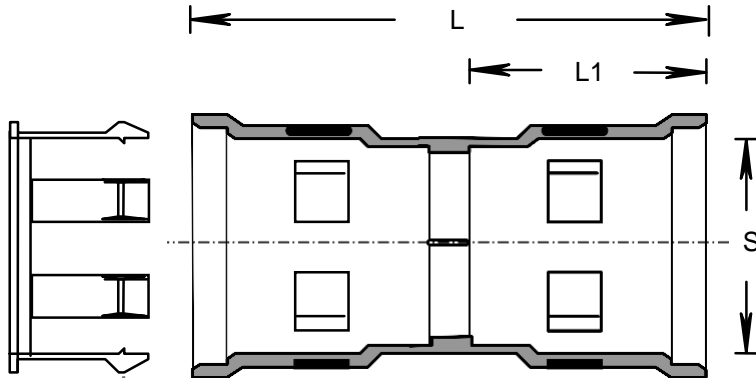

**CONNECTOR (WITH OR W/O LOCKNUT), TYPE KTA**

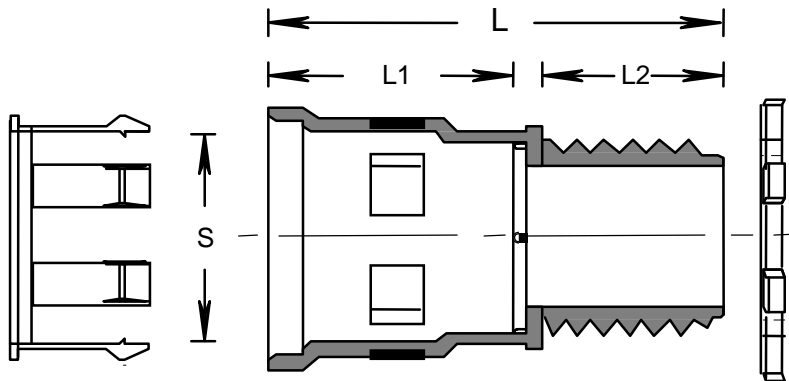

**SNAP-IN CONNECTOR, TYPE KTS**

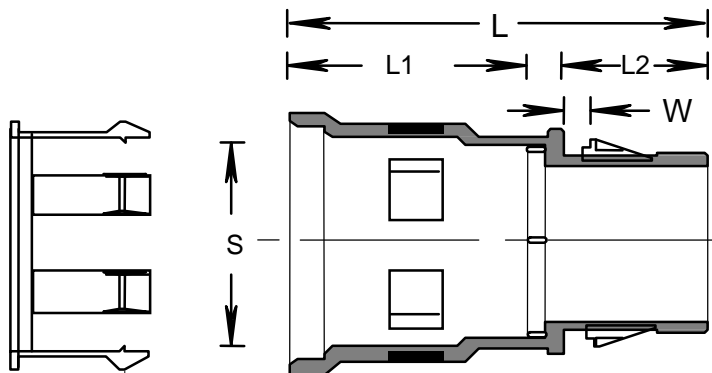

RIGID PVC CONDUIT FITTINGS

KWIKON FITTINGS

ISSUE DATE:  
DATE D'EMISSION: 2014 05 20

SUPERCEDES:  
REPLACE: 2014 02 11

TRANSITION COUPLING, TYPE KTC

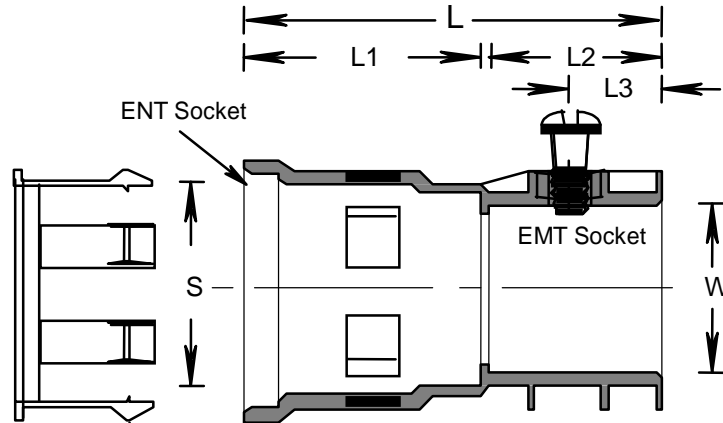

DIMENSIONS:

PRODUCT CODE	PART NUMBER	NOMINAL SIZE		L		L1		L2	
		(in)	(mm)	(in)	(mm)	(in)	(mm)	(in)	(mm)
089000	KC10	1/2	16	1.980	50.3	0.930	23.6	-	-
089001	KC15	3/4	21	2.035	51.7	0.945	24.0	-	-
089002	KC20	1	27	2.335	59.3	1.080	27.4	-	-
189670*	KC25	1 ¼	35	2.935	74.5	1.370	74.5	-	-
189671*	KC30	1 ½	41	2.495	63.4	1.150	63.4	-	-
189672*	KC35	2	53	2.350	59.7	1.065	59.7	-	-
089006	KTA10	1/2	16	1.490	37.8	0.930	23.6	0.450	11.4
089007	KTA15	3/4	21	1.770	45.0	0.960	24.4	0.680	17.3
089008	KTA20	1	27	1.885	47.9	1.060	26.9	0.660	16.8
089009	KTA10	1/2	16	1.490	37.8	0.930	23.6	0.450	11.4
089010	KTA15	3/4	21	1.770	45.0	0.960	24.4	0.680	17.3
089011	KTA20	1	27	1.885	47.9	1.060	26.9	0.660	16.8
189680*	KTA25	1 ¼	35	2.190	55.6	1.440	36.6	0.650	16.5
189681*	KTA30	1 ½	41	1.965	49.9	1.140	29.0	0.655	16.6
189682*	KTA35	2	53	1.895	48.1	1.065	27.1	0.655	16.6
089146	KTS10	1/2	16	1.980	50.3	0.950	24.1	0.950	24.1
089147	KTS15	3/4	21	1.760	44.0	0.880	22.9	0.980	24.9
089148	KTS20	1	27	1.900	48.3	0.950	24.1	0.950	28.6
089012	KTC10	1/2	16	1.965	49.9	0.960	24.4	0.945	24.0
089013	KTC15	3/4	21	2.035	51.7	0.980	24.9	0.975	24.8
089014	KTC20	1	27	2.335	59.5	1.125	28.6	1.120	28.5

RIGID PVC CONDUIT FITTINGS

ISSUE DATE:  
DATE D'EMISSION: 2014 05 20

KWIKON FITTINGS

SUPERCEDES:  
REPLACE: 2014 02 11

4

PRODUCT CODE	PART NUMBER	NOMINAL SIZE		L3		W		S	
		(in)	(mm)	(in)	(mm)	(in)	(mm)	(in)	(mm)
089000	KC10	1/2	16	-	-	-	-	0.860	21.8
089001	KC15	3/4	21	-	-	-	-	1.060	26.9
089002	KC20	1	27	-	-	-	-	1.330	33.8
189670*	KC25	1 ¼	35	-	-	-	-	1.690	42.9
189671*	KC30	1 ½	41	-	-	-	-	1.930	49.0
189672*	KC35	2	53	-	-	-	-	2.410	61.2
089006	KTA10	1/2	16	-	-	-	-	0.860	21.8
089007	KTA15	3/4	21	-	-	-	-	1.060	26.9
089008	KTA20	1	27	-	-	-	-	1.330	33.8
089009	KTA10	1/2	16	-	-	-	-	0.860	21.8
089010	KTA15	3/4	21	-	-	-	-	1.060	26.9
089011	KTA20	1	27	-	-	-	-	1.330	33.8
189680*	KTA25	1 ¼	35	-	-	-	-	1.690	42.9
189681*	KTA30	1 ½	41	-	-	-	-	1.930	49.0
189682*	KTA35	2	53	-	-	-	-	2.405	61.1
089146	KTS10	1/2	16	-	-	0.105	2.67	0.860	21.8
089147	KTS15	3/4	21	-	-	0.105	2.67	1.060	26.9
089148	KTS20	1	27	-	-	0.105	2.67	1.330	33.8
089012	KTC10	1/2	16	0.560	14.2	0.700	17.8	0.860	21.8
089013	KTC15	3/4	21	0.560	14.2	0.960	24.4	1.060	26.9
089014	KTC20	1	27	0.560	14.2	1.200	30.5	1.330	33.8

**RIGID PVC CONDUIT FITTINGS**

**ISSUE DATE:**  
**DATE D'EMISSION:** 2014 05 20

**KWIKON FITTINGS**

**SUPERCEDES:**  
**REPLACE:** 2014 02 11

4

PRODUCT CODE	PART NUMBER	NOMINAL SIZE		BODY CODE	RETAINER CODE	LOCKNUT CODE
		(in)	(mm)			
089000	KC10	1/2	16	091500	091987 (2)	-
089001	KC15	3/4	21	091501	091988 (2)	-
089002	KC20	1	27	091502	091989 (2)	-
189670*	KC25	1 ¼	35	091670	091992 (2)	-
189671*	KC30	1 ½	41	091671	091993 (2)	-
189672*	KC35	2	53	091672	091994 (2)	-
089006	KTA10	1/2	16	091506	091987 (1)	072531 (1)
089007	KTA15	3/4	21	091507	091988 (1)	072532 (1)
089008	KTA20	1	27	091508	091989 (1)	072533 (1)
189680*	KTA25	1 ¼	35	091980	091992 (1)	178285 (1)
189681*	KTA30	1 ½	41	091981	091993 (1)	178286 (1)
189682*	KTA35	2	53	091982	091994 (1)	178287 (1)
089009	KTA10	1/2	16	091506	091987 (1)	-
089010	KTA15	3/4	21	091507	091988 (1)	-
089011	KTA20	1	27	091508	091989 (1)	-
089146	KTS10	1/2	16	091515	091987 (1)	-
089147	KTS15	3/4	21	091516	091988 (1)	-
089148	KTS20	1	27	091517	091989 (1)	-
089012**	KTC10	1/2	16	091512	091987 (1)	-
089013**	KTC15	3/4	21	091513	091988 (1)	-
089014**	KTC20	1	27	091514	091989 (1)	-

\*\* COMES WITH ONE 8 X 7/16 PAN COMB TYPE B STEEL ZINC PLATED SCREW