



KT-LED94P-H-8XX-S

4-PIN LED LAMP



DESCRIPTION

9W | 4-Pin LED Lamp | 2700K, 3000K, 3500K, 4000K, 5000K | >80CRI | CFL Ballast Compatible

| |
|---------------------------------------|
| LAMP TYPE: Compact |
| BULB TYPE: 4-Pin LED |
| BASE TYPE: G24q/GX24q |
| LAMP WATTAGE: 9W |
| INPUT TYPE: Ballast Compatible |
| WARRANTY: 5 Years |



PRODUCT FEATURES

- **Plug and Play: Directly Compatible with Most Existing CFL Ballasts. Contact Keystone for Ballast Compatibility List.**
- Replacement for Conventional 13W, 18W, 26W, and 42W G24q Lamps
- Last Up to 5x Longer for Traditional CFL Lamps
- UL Classified and UL Recognized Component
- Operating Temperature: -20°C/-4°F to 45°C /113°F
- Listed on DLC QPL
- Non-Dimmable, and Not for Use in Fully Enclosed Fixtures.

OPERATING SPECIFICATIONS

| Catalog Number | Color | Base Type | Orientation | CRI | Power Factor | Input Voltage | Lamp Wattage | System Wattage* | Lumens* | Rated Life |
|-------------------|-------|-----------|-------------|-----|----------------------|---------------|--------------|-----------------|---------|-------------|
| KT-LED94P-H-827-S | 2700K | G24q | Horizontal | >80 | Ballast Dependent | | 9 | 11 | 920 | 50,000 Hrs. |
| KT-LED94P-H-830-S | 3000K | G24q | Horizontal | >80 | | | 9 | 11 | 980 | 50,000 Hrs. |
| KT-LED94P-H-835-S | 3500K | G24q | Horizontal | >80 | | | 9 | 11 | 980 | 50,000 Hrs. |
| KT-LED94P-H-840-S | 4000K | G24q | Horizontal | >80 | | | 9 | 11 | 1050 | 50,000 Hrs. |
| KT-LED94P-H-850-S | 5000K | G24q | Horizontal | >80 | | | 9 | 11 | 1050 | 50,000 Hrs. |

* Values based off of typical 2x26W CFL Ballast.

PERFORMANCE SPECIFICATIONS

| Original Best Wattage | System Wattage Per Lamp | Lumens Per Lamp (at 3000K) |
|-----------------------|-------------------------|----------------------------|
| 13W | 6.5 | 415 |
| 18W | 7.5 | 480 |
| 26W | 11 | 980 |
| 42W | 12 | 1000 |

* Values based off of typical 2x26W CFL Ballast.



KT-LED94P-H-8XX-S

4-PIN LED LAMP

PHYSICAL CHARACTERISTICS

LAMP DIMENSIONS

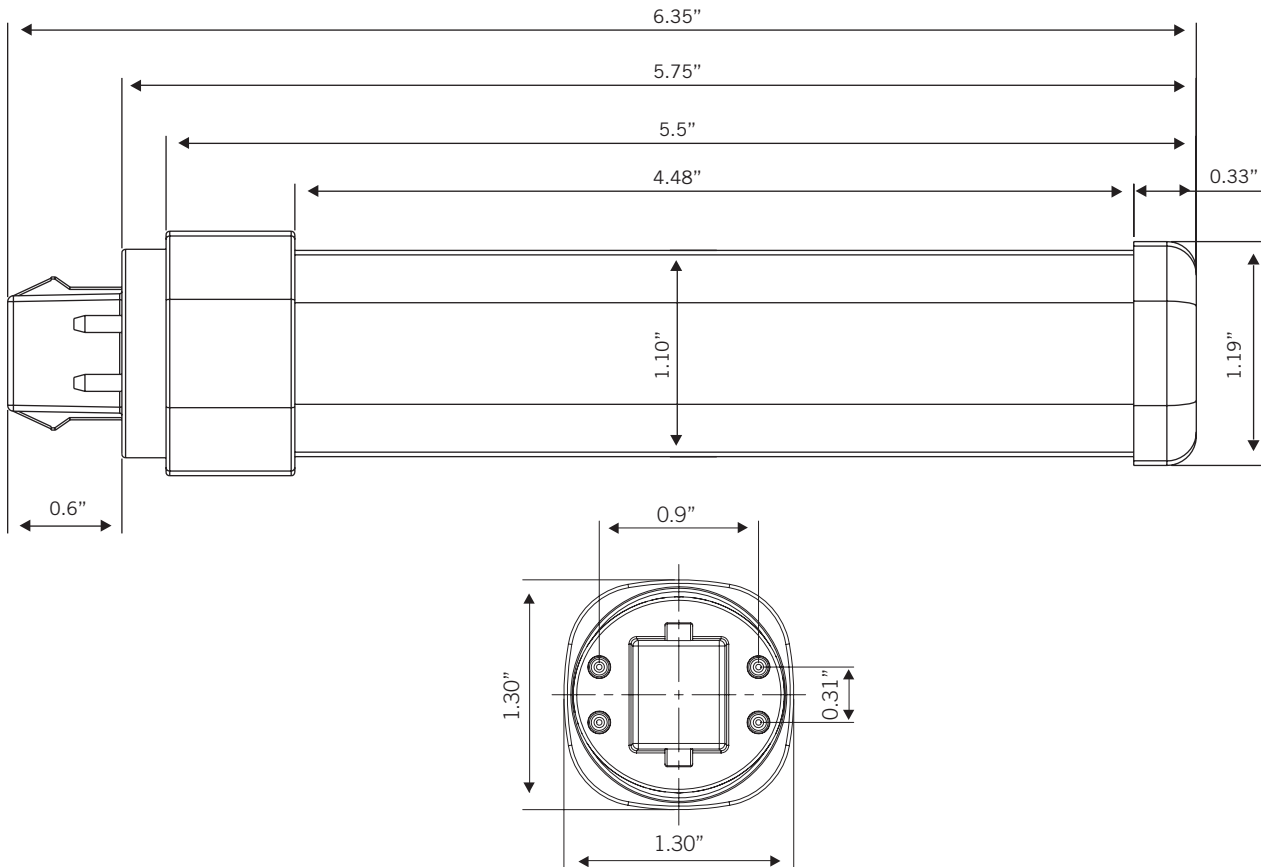

ORDERING INFORMATION

| ORDER CODE | PACKAGING STYLE | PACK QTY. | ITEM STATUS |
|----------------------|------------------|-----------|-------------|
| KT-LED94P-H-8xx-S-DP | Distributor Pack | 6 | Active |

CATALOG NUMBER BREAKDOWN

KT-LED94P-H-8XX-S-DP

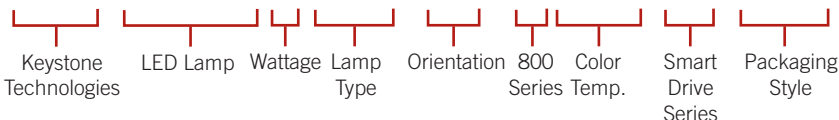



KT-LED94P-H-8XX-S

4-PIN LED LAMP



DESCRIPTION

9W | 4-Pin LED Lamp | 2700K, 3000K, 3500K, 4000K, 5000K | >80CRI | CFL Ballast Compatible

| |
|---------------------------------------|
| LAMP TYPE: Compact |
| BULB TYPE: 4-Pin LED |
| BASE TYPE: G24q/GX24q |
| LAMP WATTAGE: 9W |
| INPUT TYPE: Ballast Compatible |
| WARRANTY: 5 Years |



PRODUCT FEATURES

- **Plug and Play:** Directly Compatible with Most Existing CFL Ballasts. Contact Keystone for Ballast Compatibility List.
- Replacement for Conventional 13W, 18W, 26W, and 42W G24q Lamps
- Last Up to 5x Longer for Traditional CFL Lamps
- UL Classified and UL Recognized Component
- Operating Temperature: -20°C/-4°F to 45°C /113°F
- Listed on DLC QPL
- Non-Dimmable, and Not for Use in Fully Enclosed Fixtures.

OPERATING SPECIFICATIONS

| Catalog Number | Color | Base Type | Orientation | CRI | Power Factor | Input Voltage | Lamp Wattage | System Wattage* | Lumens* | Rated Life |
|-------------------|-------|-----------|-------------|-----|----------------------|---------------|--------------|-----------------|---------|-------------|
| KT-LED94P-H-827-S | 2700K | G24q | Horizontal | >80 | Ballast Dependent | | 9 | 11 | 920 | 50,000 Hrs. |
| KT-LED94P-H-830-S | 3000K | G24q | Horizontal | >80 | | | 9 | 11 | 980 | 50,000 Hrs. |
| KT-LED94P-H-835-S | 3500K | G24q | Horizontal | >80 | | | 9 | 11 | 980 | 50,000 Hrs. |
| KT-LED94P-H-840-S | 4000K | G24q | Horizontal | >80 | | | 9 | 11 | 1050 | 50,000 Hrs. |
| KT-LED94P-H-850-S | 5000K | G24q | Horizontal | >80 | | | 9 | 11 | 1050 | 50,000 Hrs. |

* Values based off of typical 2x26W CFL Ballast.

PERFORMANCE SPECIFICATIONS

| Original Best Wattage | System Wattage Per Lamp | Lumens Per Lamp (at 3000K) |
|-----------------------|-------------------------|----------------------------|
| 13W | 6.5 | 415 |
| 18W | 7.5 | 480 |
| 26W | 11 | 980 |
| 42W | 12 | 1000 |

* Values based off of typical 2x26W CFL Ballast.



KT-LED94P-H-8XX-S

4-PIN LED LAMP

PHYSICAL CHARACTERISTICS

LAMP DIMENSIONS

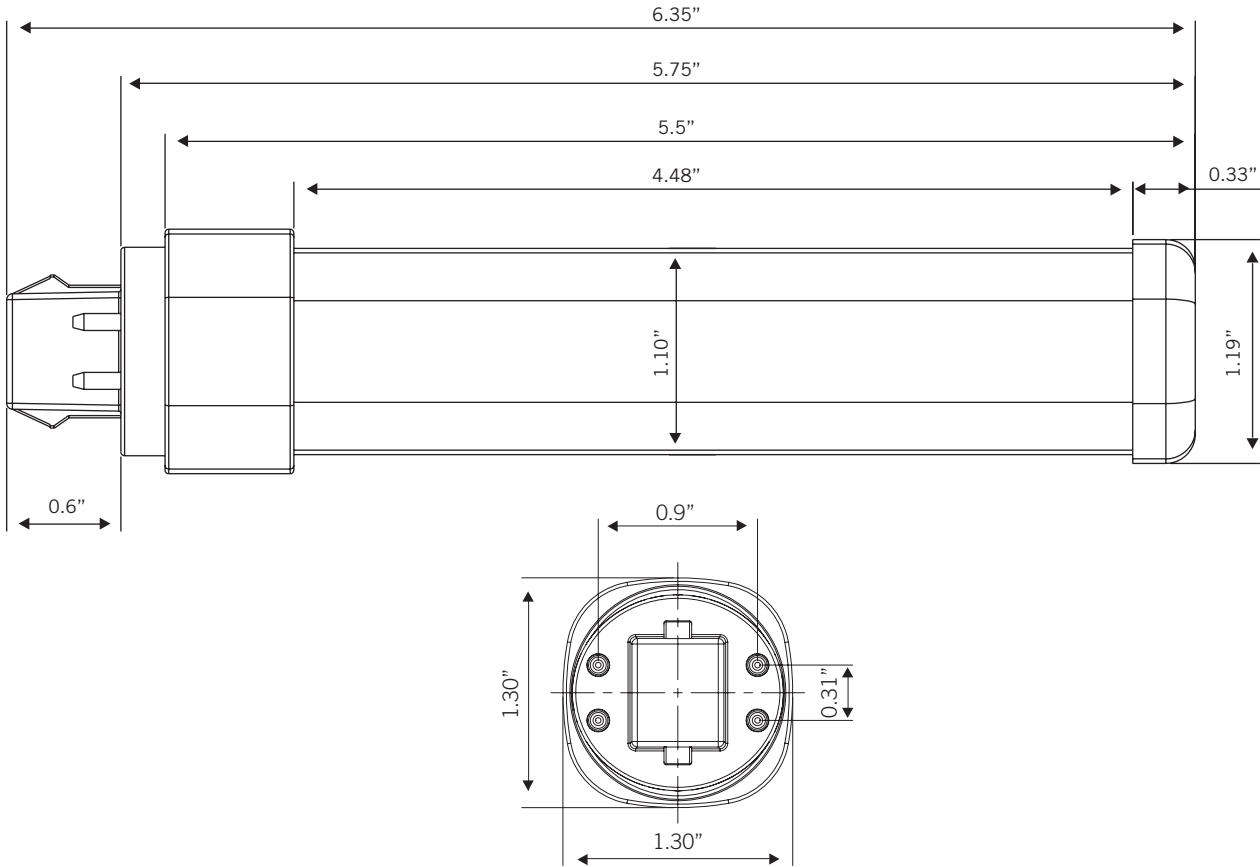

ORDERING INFORMATION

| ORDER CODE | PACKAGING STYLE | PACK QTY. | ITEM STATUS |
|----------------------|------------------|-----------|-------------|
| KT-LED94P-H-8xx-S-DP | Distributor Pack | 6 | Active |

CATALOG NUMBER BREAKDOWN

KT-LED94P-H-8XX-S-DP

