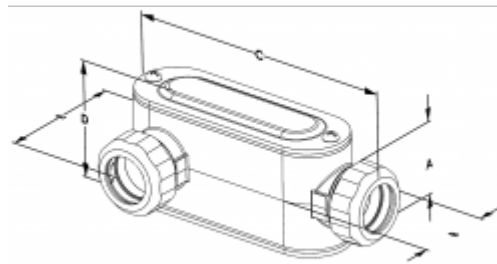
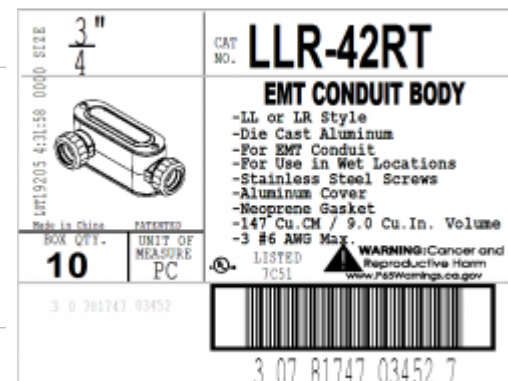

EMT Conduit Body With Integral Raintight Connector, Type LLR, Set Screw, Aluminum, Size 3/4 Inch

Bridgeport's LLR Conduit Bodies are Type LL/LR Combination conduit bodies with Integral Raintight Connectors. These allows access to the interior of a conduit system for inspection, pulling and maintenance, without needing to thread connectors into a conduit body entry. These conduit bodies come with stainless steel screws, an aluminum cover, and a neoprene gasket. 147 cubic cm / 9.0 cubic in volume 3 #6 AWG Max Wire Size

[Download Photo](#)

[Download Drawing](#)

[Download Drawing](#)

Product details

Catalog Number:	LLR-42RT
UPC Number:	78174703452
Primary Materials:	Aluminum
Trade Size:	3/4"
Unit Quantity:	100
Standard Package Quantity:	60

Dimensions

Trade Size:	3/4"
Dimensions A:	1.467
Dimensions B:	1.567
Dimensions C:	5.483
Dimensions D:	2.364

Certifications & Codes

Federal Specification Number: A-A-50552

UL File Number: E11077

UNSPSC: 39131708

Nema Standard: FB-1

UL Standard: UL-514B