

## DESCRIPTION

The Lumark Nighthawk III utilizes a soft-cornered aerodynamic design to provide excellent EPA ratings and an aesthetically pleasing appearance. Dark bronze polyester powder coat finish assures corrosion resistance and long-lasting aesthetics. U.L. listed and CSA certified for wet locations. The Nighthawk III uses an innovative die-cut optical design which delivers maximum beam control for storage areas, rail yards, loading docks and building perimeters.

Catalog #	Type
Project	
Comments	Date
Prepared by	

## SPECIFICATION FEATURES

### Construction

**LATCHES:** Formed aluminum flush draw-action latches offer easy access to lamp compartment without tools and maintain integrity of seal when closed.  
**HOUSING:** Aerodynamically designed die-cast aluminum housing has low EPA rating. **DOOR:** Die-cast aluminum with integral cast hinges for removal without tools. **GASKET:** Door gasket is foam-in-place silicone, providing maximum protection of interior components from the elements.

### Electrical

**BALLAST:** Ballast components are hard mounted to fixture housing for maximum heat dissipation and extended component and lamp life.

### Optical

**LENS:** Heat- and impact-resistant tempered glass. Lens is mounted flush with door surface to reduce wind drag and prevent dirt or moisture from accumulating.  
**REFLECTOR:** Computer designed die-cut reflector system delivers superior beam control and efficiency.

### Mounting

**Slipfitter:** Die-cast aluminum integral slipfitter mounts on nominal 2 3/8" or 3" O.D. tenons. A degree-marked quadrant is cast in for easy and accurate aiming.  
**Yoke:** Heavy-duty steel yoke provides flexibility in mounting from a variety of surfaces. **Trunnion:** Die-formed steel trunnion is easily adapted to many areas and allows easy fixture aiming.



## NK NIGHTHAWK III

150 - 1000W

Pulse Start Metal Halide

Metal Halide

High Pressure Sodium

SLIPFITTER-, YOKE-, TRUNNION-MOUNT FLOODLIGHT

## DIMENSIONS

### SLIPFITTER-MOUNT

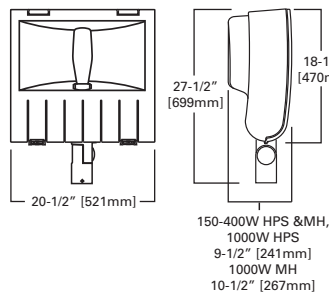

### YOKE-MOUNT

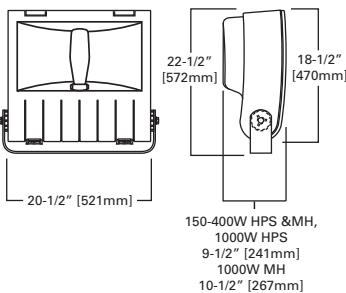

### TRUNNION-MOUNT

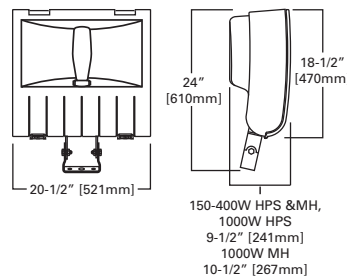

## DRILLING PATTERN FOR YOKE- AND TRUNNION-MOUNT

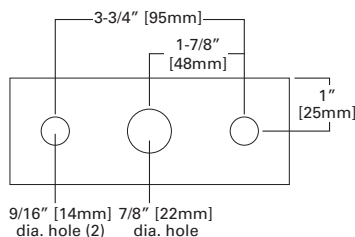

LAMP TYPE	WATTAGE
Pulse Start Metal Halide (MP)	150, 250, 320, 400, 450, 750, 1000W
Metal Halide (MH)	175, 250, 400, 750, 1000W
High Pressure Sodium (HP)	150, 250, 400, 600, 750, 1000W

## TECHNICAL DATA

U.L. Wet Location Listed  
 CSA Certified  
 EISA Compliant ©

## EPA

Effective Projected Area: 2.7

## SHIPPING DATA

Approximate Net Weight:  
 59 lbs. (27 kgs.)

PHOTOMETRICS

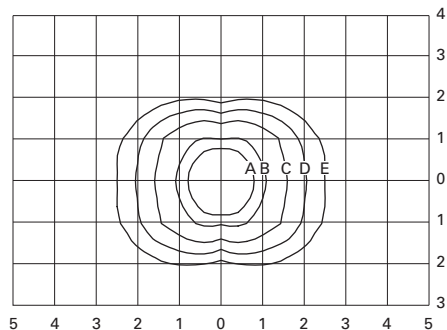

**HPNK-X76-400**  
400-Watt HP  
50,000-Lumen Clear Lamp

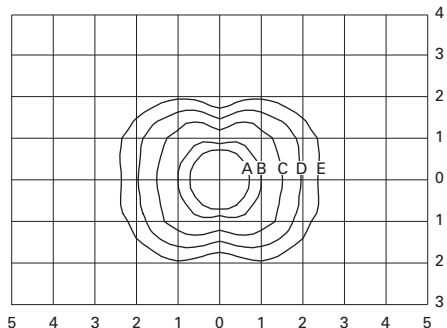

**MPNK-X76-400**  
400-Watt MP  
42,000-Lumen Clear Lamp

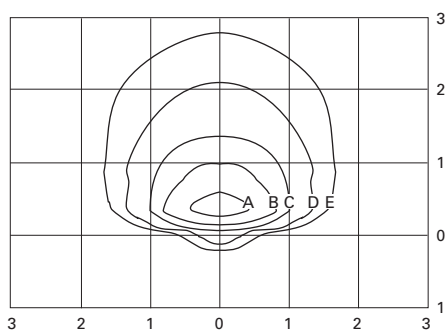

**HPNK-X76-1000**  
1000-Watt HP  
140,000-Lumen Clear Lamp

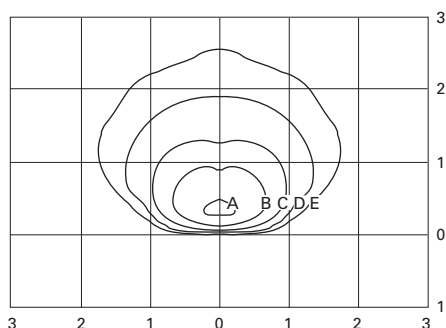

**MHNK-X76-1000**  
1000-Watt MH  
110,000-Lumen Clear Lamp

**Footcandle Table**

Select mounting height and read across for footcandle values of each isofootcandle line. Distance in units of mounting height.

Mounting Height	Footcandle Values for Isofootcandle Lines				
	A	B	C	D	E
<b>400W</b>					
20'	10.00	5.00	2.00	1.00	0.50
25'	6.40	3.20	1.28	0.64	0.32
30'	4.44	2.22	0.89	0.44	0.22
35'	3.27	1.63	0.65	0.33	0.16
40'	2.50	1.25	0.50	0.25	0.13

**1000W**

30'	20.00	10.00	5.00	2.00	1.00
35'	14.69	7.35	3.67	1.47	0.73
40'	11.25	5.63	2.81	1.13	0.56
45'	8.89	4.44	2.22	0.89	0.44
50'	7.20	3.60	1.80	0.72	0.36

**EPA Ratings:**

Fixture Angle	Wind Direction (sq. ft.)	
	Front	Side
45° from Horizontal	2.7	1.2
90° from Horizontal	4.2	1.2
0° from Horizontal	1.1	1.2

## ORDERING INFORMATION

Sample Number: MPNK-S76-400-277V

<b>Lamp Type</b> <b>MP</b> =Pulse Start Metal Halide <b>MH</b> =Metal Halide <sup>1</sup> <b>HP</b> =High Pressure Sodium	<b>Mounting</b> <b>S</b> =Slipfitter <b>T</b> =Trunnion <b>Y</b> =Yoke  <b>Distribution</b> <b>76</b> : 7H x 6V Beam Spread	<b>Lamp Wattage</b> <sup>1</sup> <b>MP</b> <b>150</b> =150W <b>250</b> =250W <b>320</b> =320W <b>400</b> =400W <b>450</b> = 450W <b>750</b> = 750W <b>1000</b> = 1000W <b>MH</b> <b>175</b> = 175W <sup>1</sup> <b>250</b> = 250W <sup>1</sup> <b>400</b> = 400W <sup>1</sup> <b>750</b> = 750W <b>1000</b> = 1000W <b>HP</b> <b>150</b> = 150W <b>250</b> = 250W <b>400</b> = 400W <b>600</b> = 600W <b>750</b> = 750W <b>1000</b> = 1000W	<b>Voltage</b> <sup>2</sup> <b>120V</b> =120V <b>208V</b> =208V <b>240V</b> =240V <b>277V</b> =277V <b>347V</b> = 347V <sup>3</sup> <b>480V</b> = 480V <b>MT</b> = Multi-Tap, wired 277V <b>TT</b> = Triple-Tap, <sup>3</sup> wired 347V	<b>Options</b> <sup>4</sup> <b>F1</b> =Single Fuse (120, 277 or 347V only) <b>F2</b> =Double Fuse (208, 240 or 480V only) <b>Q</b> =Quartz Restrike (Hot Strike Only) <b>EM</b> =Quartz Restrike with "Delay Relay" (Quartz lamp strikes at both hot and cold starts) <b>LL</b> : Lamp Included <sup>6</sup> <b>CEC</b> = California Title 20 Compliant Ballast (Applies to 250-320W and 400W MP only) <b>PER</b> = NEMA Twistlock Photocontrol Receptacle <b>PC</b> = Button Type Photocontrol <sup>7</sup> <b>T</b> = Removable Quick-Disconnect <sup>5</sup> Power Tray  <b>Standard Color</b> __ = Bronze (Standard) <b>BLK</b> = Black <b>GRY</b> = Grey <b>WHT</b> =White	<b>Accessories</b> <sup>8</sup> <b>TYS-XX</b> =Trunnion or Yoke Slipfitter for 2 3/8", 3", or 3 1/2" <sup>9</sup> O.D. Tenon <b>VS/NK</b> =Vandal Shield for 150 - 320W <b>WG/NK</b> =Wire Guard <b>VS/NK/1000</b> =Vandal Shield for 400 - 1000W Units <b>OA/RA1016</b> = Photoelectric Control, 105-285 Volt NEMA Type <b>OA/RA1201</b> = Photoelectric Control, 347V NEMA Type <b>OA/RA1027</b> = Photoelectric Control, 480V NEMA Type <b>OA1028</b> = Field Installed NEMA Twistlock Photocontrol Receptacle (Order Photocontrol Separately) <b>TV/NK-XX</b> = Top or Bottom Visor <b>SV1/NK-XX</b> = Single Side Visor <b>SV/NK-XX</b> = Double Side Visor <b>OA/RA1013</b> = Shorting Cap
--	---	--	--	--	--

- Notes:**
- 1 175W, 250W, and 400W MH available in non-U.S. markets only.
  - 2 Products also available in non-US voltages and 50HZ for international markets.
  - 3 88% efficient EISA Compliant fixtures not available in 347V or TT Voltages. TT not available with 750W HPS - Specify Voltage.
  - 4 Add as suffix in the order shown.
  - 5 Not available in 1000W.
  - 6 Lamp is shipped separate from luminaire. Lamp is Cooper designated product based on luminaire requirements. Specified lamps must be ordered as a separate line item.
  - 7 PC option not available with trunnion or yoke mount.
  - 8 Order separately, replace XX with color designation.
  - 9 Not available with slipfitter-mount.

## STOCK SAMPLE NUMBER: (LAMP INCLUDED)

SAMPLE NUMBER: MPNKS40

<b>Lamp Type</b> <b>MP</b> =Pulse Start Metal Halide <b>MH</b> =Metal Halide <b>HP</b> =High Pressure Sodium	<b>NK</b> <b>Series</b> <b>NK</b> =Nighthawk III <sup>1</sup>	<b>Mounting</b> <b>S</b> =Slipfitter <b>Y</b> =Yoke	<b>Lamp Wattage</b> <b>40</b> =400W <sup>2</sup> <b>1K</b> =1000W <sup>3</sup>	<b>TYS</b> <b>Accessories</b> (order separately) <b>TYS</b> =Trunnion or Yoke Slipfitter for 2 3/8", 3", or 3 1/2" O.D. Tenon
---	---	---	--	---

## NOTES [stock]:

- 1 Multi-tap ballast, 7Hx6V beam spread, bronze finish, and lamp are standard for stock product.
  - 2 400W available in MP only.
  - 3 1K available in MH and HPS only.
- Refer to In Stock Guide for availability.

## VOLTAGE CHART

MT=Multi-Tap 120/208/240/277V (wired 277V)

TT=Triple-Tap 120/277/347V (wired 347V)

## DESCRIPTION

The Lumark Nighthawk III utilizes a soft-cornered aerodynamic design to provide excellent EPA ratings and an aesthetically pleasing appearance. Dark bronze polyester powder coat finish assures corrosion resistance and long-lasting aesthetics. U.L. listed and CSA certified for wet locations. The Nighthawk III uses an innovative die-cut optical design which delivers maximum beam control for storage areas, rail yards, loading docks and building perimeters.

Catalog #	Type
Project	
Comments	Date
Prepared by	

## SPECIFICATION FEATURES

### Construction

**LATCHES:** Formed aluminum flush draw-action latches offer easy access to lamp compartment without tools and maintain integrity of seal when closed.  
**HOUSING:** Aerodynamically designed die-cast aluminum housing has low EPA rating.  
**DOOR:** Die-cast aluminum with integral cast hinges for removal without tools.  
**GASKET:** Door gasket is foam-in-place silicone, providing maximum protection of interior components from the elements.

### Electrical

**BALLAST:** Ballast components are hard mounted to fixture housing for maximum heat dissipation and extended component and lamp life.

### Optical

**LENS:** Heat- and impact-resistant tempered glass. Lens is mounted flush with door surface to reduce wind drag and prevent dirt or moisture from accumulating.  
**REFLECTOR:** Computer designed die-cut reflector system delivers superior beam control and efficiency.

### Mounting

**Slipfitter:** Die-cast aluminum integral slipfitter mounts on nominal 2 3/8" or 3" O.D. tenons. A degree-marked quadrant is cast in for easy and accurate aiming.  
**Yoke:** Heavy-duty steel yoke provides flexibility in mounting from a variety of surfaces.  
**Trunnion:** Die-formed steel trunnion is easily adapted to many areas and allows easy fixture aiming.



## NK NIGHTHAWK III

150 - 1000W

Pulse Start Metal Halide

Metal Halide

High Pressure Sodium

SLIPFITTER-, YOKE-, TRUNNION-MOUNT FLOODLIGHT

## DIMENSIONS

### SLIPFITTER-MOUNT

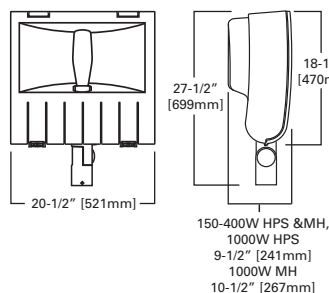

### YOKE-MOUNT

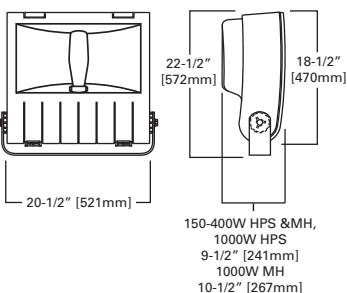

### TRUNNION-MOUNT

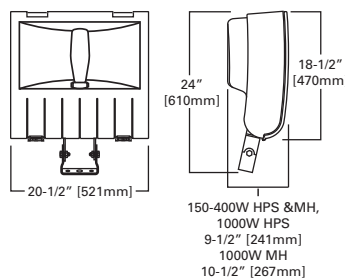

## DRILLING PATTERN FOR YOKE- AND TRUNNION-MOUNT

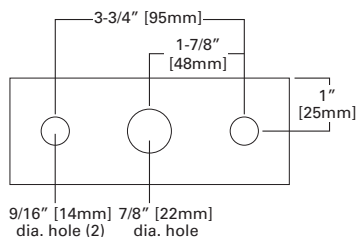

LAMP TYPE	WATTAGE
Pulse Start Metal Halide (MP)	150, 250, 320, 400, 450, 750, 1000W
Metal Halide (MH)	175, 250, 400, 750, 1000W
High Pressure Sodium (HP)	150, 250, 400, 600, 750, 1000W

## TECHNICAL DATA

U.L. Wet Location Listed  
 CSA Certified  
 EISA Compliant ©

## EPA

Effective Projected Area: 2.7

## SHIPPING DATA

Approximate Net Weight:  
 59 lbs. (27 kgs.)

PHOTOMETRICS

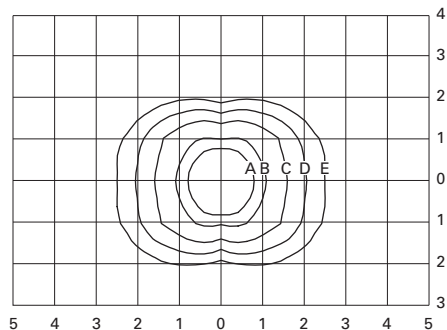

**HPNK-X76-400**  
400-Watt HP  
50,000-Lumen Clear Lamp

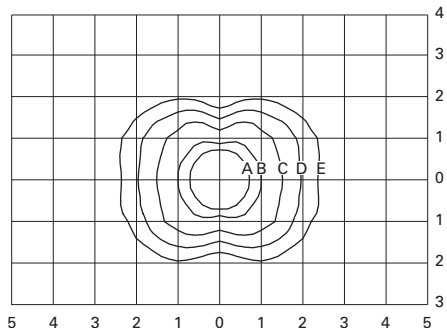

**MPNK-X76-400**  
400-Watt MP  
42,000-Lumen Clear Lamp

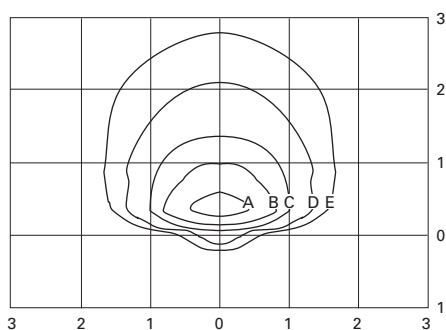

**HPNK-X76-1000**  
1000-Watt HP  
140,000-Lumen Clear Lamp

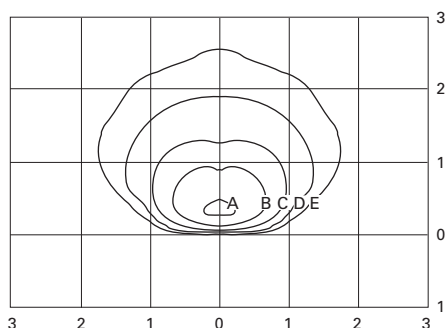

**MHNK-X76-1000**  
1000-Watt MH  
110,000-Lumen Clear Lamp

**Footcandle Table**

Select mounting height and read across for footcandle values of each isofootcandle line. Distance in units of mounting height.

Mounting Height	Footcandle Values for Isofootcandle Lines				
	A	B	C	D	E
<b>400W</b>					
20'	10.00	5.00	2.00	1.00	0.50
25'	6.40	3.20	1.28	0.64	0.32
30'	4.44	2.22	0.89	0.44	0.22
35'	3.27	1.63	0.65	0.33	0.16
40'	2.50	1.25	0.50	0.25	0.13

**1000W**

30'	20.00	10.00	5.00	2.00	1.00
35'	14.69	7.35	3.67	1.47	0.73
40'	11.25	5.63	2.81	1.13	0.56
45'	8.89	4.44	2.22	0.89	0.44
50'	7.20	3.60	1.80	0.72	0.36

**EPA Ratings:**

Fixture Angle	Wind Direction (sq. ft.)	
	Front	Side
45° from Horizontal	2.7	1.2
90° from Horizontal	4.2	1.2
0° from Horizontal	1.1	1.2

## ORDERING INFORMATION

Sample Number: MPNK-S76-400-277V

<b>Lamp Type</b> <b>MP</b> =Pulse Start Metal Halide <b>MH</b> =Metal Halide <sup>1</sup> <b>HP</b> =High Pressure Sodium	<b>Mounting</b> <b>S</b> =Slipfitter <b>T</b> =Trunnion <b>Y</b> =Yoke	<b>Lamp Wattage</b> <sup>1</sup> <b>MP</b> <b>150</b> =150W <b>250</b> =250W <b>320</b> =320W <b>400</b> =400W <b>450</b> =450W <b>750</b> =750W <b>1000</b> =1000W <b>MH</b> <b>175</b> =175W <sup>1</sup> <b>250</b> =250W <sup>1</sup> <b>400</b> =400W <sup>1</sup> <b>750</b> =750W <b>1000</b> =1000W <b>HP</b> <b>150</b> =150W <b>250</b> =250W <b>400</b> =400W <b>600</b> =600W <b>750</b> =750W <b>1000</b> =1000W	<b>Voltage</b> <sup>2</sup> <b>120V</b> =120V <b>208V</b> =208V <b>240V</b> =240V <b>277V</b> =277V <b>347V</b> =347V <sup>3</sup> <b>480V</b> =480V <b>MT</b> = Multi-Tap, wired 277V <b>TT</b> = Triple-Tap, <sup>3</sup> wired 347V	<b>Options</b> <sup>4</sup> <b>F1</b> =Single Fuse (120, 277 or 347V only) <b>F2</b> =Double Fuse (208, 240 or 480V only) <b>Q</b> =Quartz Restrike (Hot Strike Only) <b>EM</b> =Quartz Restrike with "Delay Relay" (Quartz lamp strikes at both hot and cold starts) <b>LL</b> : Lamp Included <sup>6</sup> <b>CEC</b> = California Title 20 Compliant Ballast (Applies to 250-320W and 400W MP only) <b>PER</b> = NEMA Twistlock Photocontrol Receptacle <b>PC</b> = Button Type Photocontrol <sup>7</sup> <b>T</b> = Removable Quick-Disconnect <sup>5</sup> Power Tray	<b>Accessories</b> <sup>8</sup> <b>TYS-XX</b> =Trunnion or Yoke Slipfitter for 2 3/8", 3", or 3 1/2" <sup>9</sup> O.D. Tenon <b>VS/NK</b> =Vandal Shield for 150 - 320W <b>WG/NK</b> =Wire Guard <b>VS/NK/1000</b> =Vandal Shield for 400 - 1000W Units <b>OA/RA1016</b> = Photoelectric Control, 105-285 Volt NEMA Type <b>OA/RA1201</b> = Photoelectric Control, 347V NEMA Type <b>OA/RA1027</b> = Photoelectric Control, 480V NEMA Type <b>OA1028</b> = Field Installed NEMA Twistlock Photocontrol Receptacle (Order Photocontrol Separately) <b>TV/NK-XX</b> = Top or Bottom Visor <b>SV1/NK-XX</b> = Single Side Visor <b>SV/NK-XX</b> = Double Side Visor <b>OA/RA1013</b> = Shorting Cap
--	---	--	--	---	--

**Standard Color**  
\_ = Bronze (Standard)  
**BLK**= Black  
**GRY**= Grey  
**WHT**=White

- Notes:**
- 1 175W, 250W, and 400W MH available in non-U.S. markets only.
  - 2 Products also available in non-US voltages and 50HZ for international markets.
  - 3 88% efficient EISA Compliant fixtures not available in 347V or TT Voltages. TT not available with 750W HPS - Specify Voltage.
  - 4 Add as suffix in the order shown.
  - 5 Not available in 1000W.
  - 6 Lamp is shipped separate from luminaire. Lamp is Cooper designated product based on luminaire requirements. Specified lamps must be ordered as a separate line item.
  - 7 PC option not available with trunnion or yoke mount.
  - 8 Order separately, replace XX with color designation.
  - 9 Not available with slipfitter-mount.

## STOCK SAMPLE NUMBER: (LAMP INCLUDED)

SAMPLE NUMBER: MPNKS40

<b>Lamp Type</b> <b>MP</b> =Pulse Start Metal Halide <b>MH</b> =Metal Halide <b>HP</b> =High Pressure Sodium	<b>Series</b> <b>NK</b> =Nighthawk III <sup>1</sup>	<b>Mounting</b> <b>S</b> =Slipfitter <b>Y</b> =Yoke	<b>Lamp Wattage</b> <b>40</b> =400W <sup>2</sup> <b>1K</b> =1000W <sup>3</sup>	<b>Accessories</b> (order separately) <b>TYS</b> =Trunnion or Yoke Slipfitter for 2 3/8", 3", or 3 1/2" O.D. Tenon
---	--	---	--	---

## NOTES [stock]:

- 1 Multi-tap ballast, 7Hx6V beam spread, bronze finish, and lamp are standard for stock product.
  - 2 400W available in MP only.
  - 3 1K available in MH and HPS only.
- Refer to In Stock Guide for availability.

## VOLTAGE CHART

MT=Multi-Tap 120/208/240/277V (wired 277V)

TT=Triple-Tap 120/277/347V (wired 347V)