

FLAT PLATE FITTINGS

FOR 1 5/8" (41.3) WIDTH SERIES CHANNEL



1 5/8" Channels

Nuts & Hardware

General Fittings

**P1062, P1063,
P1064, P1964,
P2471, P2490**

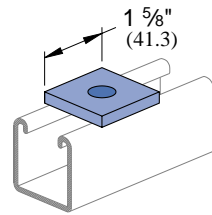

Part Number	Bolt Size	Hole Size	Weight/C	
			Lbs	kg
P1062	5/16"	1 1/32"	18	8.2
P1063	3/8"	7/16"	18	8.2
P1064	1/2"	9/16"	17	7.7
P1964	5/8"	1 1/16"	16	7.3
P2471	3/4"	1 3/16"	15	6.8
P2490	7/8"	1 5/16"	14	6.4

**P1959
P1960
P1961**

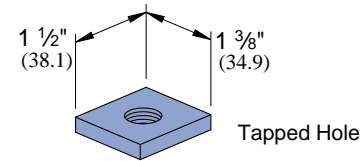

Tapped Hole

Material: 3/8" (9.5) thick.

Part Number	U.S. Std. Thd Size	Weight/C	
		Lbs	kg
P1959	3/8"-16	21	9.5
P1960	1/2"-13	20	9.1
P1961	5/8"-11	19	8.6

Pipe/Conduit Supports

Electrical Fittings

Concrete Inserts

**P2862
P2863
P2864**

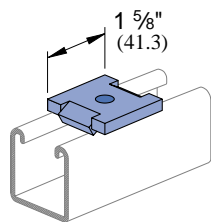

Part Number	Bolt Size	Hole Size	Weight/C	
			Lbs	kg
P2862	5/16"	1 1/32"	18	8.2
P2863	3/8"	7/16"	18	8.2
P2864	1/2"	9/16"	17	7.7

P1065

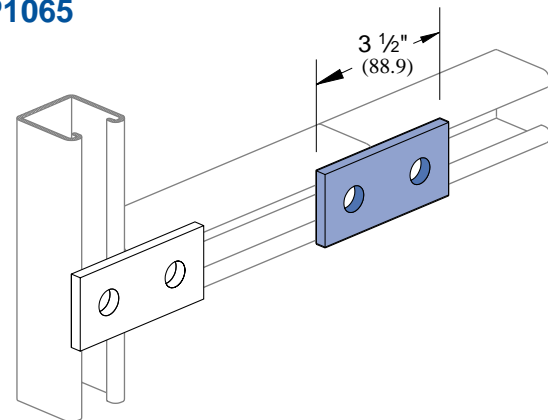

Wt/C 38 Lbs (17.2 kg)

1 1/2" Framing System

1 3/16" Framing System

Spec. Metals & Fiberglass

P1924

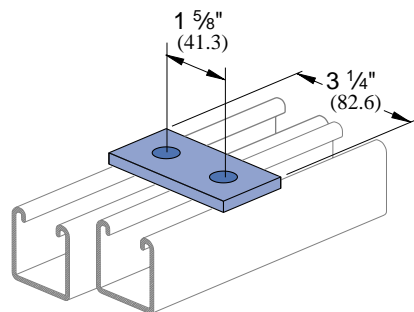

Wt/C 35 Lbs (15.9 kg)

P2325

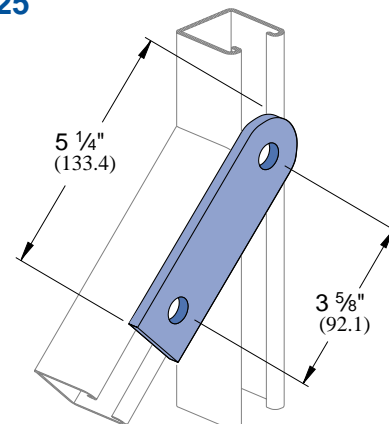

Wt/C 55 Lbs (24.9 kg)

Index

Hole Size	Hole Spacing	Width	Thickness
5/16" Diameter 14.3 mm	1 3/16" (20.6 mm) From End 1 7/8" (47.6 mm) On Center	1 5/8" 41.3 mm	1/4" 6.4 mm

GENERAL FITTINGS

FOR 1 5/8" (41 MM) WIDTH SERIES CHANNEL



1 5/8"
Channels

Nuts &
Hardware

General
Fittings

Pipe/Conduit
Supports

Electrical
Fittings

Concrete
Inserts

1 1/4" Framing
System

1 3/16" Framing
System

Spec. Metals
& Fiberglass

Index

Page

**Flat Plate
Fittings**

82

**Ninety Degree
Fittings**

86

**Angular
Fittings**

93

**"Z" Shape
Fittings**

94

**"U" Shape
Fittings**

96

**Wing Shape
Fittings**

101

Post Bases

105

**Brackets and
Braces**

106

Beam Clamps

112

Trolleys

122

**Special Application
Fittings**

124

End Caps

126

**Partition and
Display Fittings**

127



MATERIAL

Fittings, unless noted, are made from hot-rolled, pickled and oiled steel plates, strip or coil, and conform to ASTM specifications A575, A576, A635, or A36. The fitting steel also meets the physical requirements of ASTM A570 GR 33. The pickling of the steel produces a smooth surface free from scale.

Many fittings are also available in stainless steel, aluminum and fiberglass. Consult factory for ordering information.

FINISHES

Fittings are available in: Perma-Green II (GR), electro-galvanized

(EG), conforming to ASTM B633 Type III SC1; Hot-dipped galvanized (HG), conforming to ASTM A123 or A153 and plain (PL).

APPLICATION

All parts drawings illustrate only one application of each fitting. In most cases many other applications are possible. The channels shown in the illustrations are P1000, 1 5/8" square, except where noted otherwise. All 1/16" diameter holes use 1/2" x 1 5/16" hex head cap screws and 1/2" nuts - P1010, P4010 or P5510 - depending on the channel used. Nuts and bolts are not included with the fitting and must be ordered separately.

DESIGN BOLT TORQUE

BOLT SIZE	1/4"	5/16"	3/8"	1/2"	5/8"	3/4"
FOOT LBS.	20	18	16	13	11	10
N·m	6	11	19	50	100	125
	8	15	25	70	135	170

DIMENSIONS

Imperial dimensions are illustrated in inches. Metric dimensions are shown in parenthesis or as noted. Unless noted, all metric dimensions are in millimeters and rounded to one decimal place.

DESIGN LOAD

Design load data, where shown, is based on the ultimate strength of the connection with a safety factor of 2.5, unless otherwise noted.

FLAT PLATE FITTINGS

FOR 1 5/8" (41.3) WIDTH SERIES CHANNEL



1 5/8" Channels

Nuts & Hardware

General Fittings

**P1062, P1063,
P1064, P1964,
P2471, P2490**

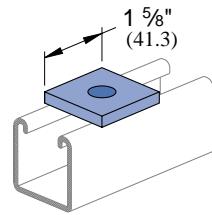

Part Number	Bolt Size	Hole Size	Weight/C	
			Lbs	kg
P1062	5/16"	11/32"	18	8.2
P1063	3/8"	7/16"	18	8.2
P1064	1/2"	9/16"	17	7.7
P1964	5/8"	11/16"	16	7.3
P2471	3/4"	13/16"	15	6.8
P2490	7/8"	15/16"	14	6.4

**P1959
P1960
P1961**

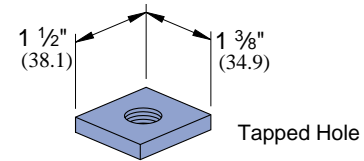

Material: 3/8" (9.5) thick.

Part Number	U.S. Std. Thd Size	Weight/C	
		Lbs	kg
P1959	3/8"-16	21	9.5
P1960	1/2"-13	20	9.1
P1961	5/8"-11	19	8.6

Pipe/Conduit Supports

Electrical Fittings

Concrete Inserts

**P2862
P2863
P2864**

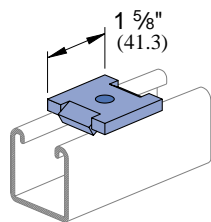

Part Number	Bolt Size	Hole Size	Weight/C	
			Lbs	kg
P2862	5/16"	11/32"	18	8.2
P2863	3/8"	7/16"	18	8.2
P2864	1/2"	9/16"	17	7.7

P1065

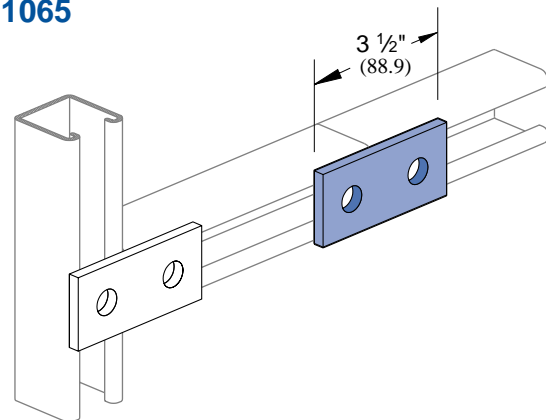

Wt/C 38 Lbs (17.2 kg)

1 1/2" Framing System

13/16" Framing System

Spec. Metals & Fiberglass

P1924

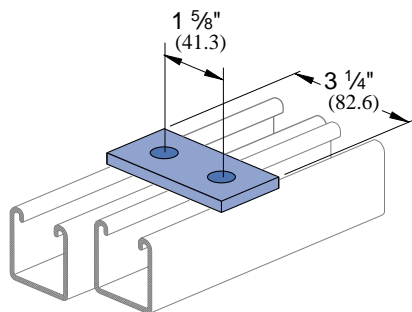

Wt/C 35 Lbs (15.9 kg)

P2325

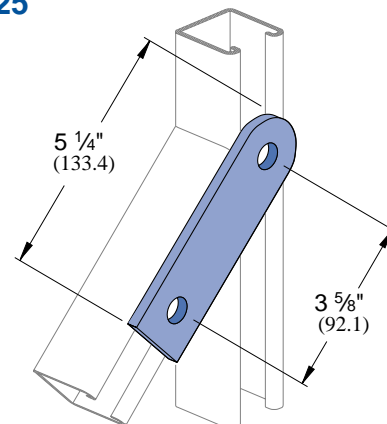

Wt/C 55 Lbs (24.9 kg)

Index

Hole Size	Hole Spacing	Width	Thickness
5/16" Diameter 14.3 mm	13/16" (20.6 mm) From End 17/8" (47.6 mm) On Center	1 5/8" 41.3 mm	1/4" 6.4 mm

GENERAL FITTINGS

FOR 1 5/8" (41 MM) WIDTH SERIES CHANNEL



1 5/8"
Channels

Nuts &
Hardware

General
Fittings

Pipe/Conduit
Supports

Electrical
Fittings

Concrete
Inserts

1 1/4" Framing
System

13/16" Framing
System

Spec. Metals
& Fiberglass

Index

Page

**Flat Plate
Fittings**

82

**Ninety Degree
Fittings**

86

**Angular
Fittings**

93

**"Z" Shape
Fittings**

94

**"U" Shape
Fittings**

96

**Wing Shape
Fittings**

101

Post Bases

105

**Brackets and
Braces**

106

Beam Clamps

112

Trolleys

122

**Special Application
Fittings**

124

End Caps

126

**Partition and
Display Fittings**

127



MATERIAL

Fittings, unless noted, are made from hot-rolled, pickled and oiled steel plates, strip or coil, and conform to ASTM specifications A575, A576, A635, or A36. The fitting steel also meets the physical requirements of ASTM A570 GR 33. The pickling of the steel produces a smooth surface free from scale.

Many fittings are also available in stainless steel, aluminum and fiberglass. Consult factory for ordering information.

FINISHES

Fittings are available in: Perma-Green II (GR), electro-galvanized

(EG), conforming to ASTM B633 Type III SC1; Hot-dipped galvanized (HG), conforming to ASTM A123 or A153 and plain (PL).

APPLICATION

All parts drawings illustrate only one application of each fitting. In most cases many other applications are possible. The channels shown in the illustrations are P1000, 1 5/8" square, except where noted otherwise. All 1/16" diameter holes use 1/2" x 1 5/16" hex head cap screws and 1/2" nuts - P1010, P4010 or P5510 - depending on the channel used. Nuts and bolts are not included with the fitting and must be ordered separately.

DESIGN BOLT TORQUE

BOLT SIZE	1/4"	5/16"	3/8"	1/2"	5/8"	3/4"
FOOT LBS.	20	18	16	13	11	10
N·m	6	11	19	50	100	125

DIMENSIONS

Imperial dimensions are illustrated in inches. Metric dimensions are shown in parenthesis or as noted. Unless noted, all metric dimensions are in millimeters and rounded to one decimal place.

DESIGN LOAD

Design load data, where shown, is based on the ultimate strength of the connection with a safety factor of 2.5, unless otherwise noted.