



## Maximize corrosion resistance.

PSDS30SR, PSDS60SR, PSDS60HPSR, PSDS100SR

Legrand's 316-Grade Sloped-Roof Stainless Steel Safety Switches are designed to provide superior corrosion resistance in harsh environments like food and beverage processing plants where wash-down/hose-down at extreme temperatures is a daily necessity, as well as in applications where salts, acids and chemicals are prevalent. Legrand's Sloped-Roof Stainless Steel Safety Switches with NEMA 4X/12, IP66/67/69 ratings are the best solution for durability and personnel safety in any environment.

## Features & Benefits

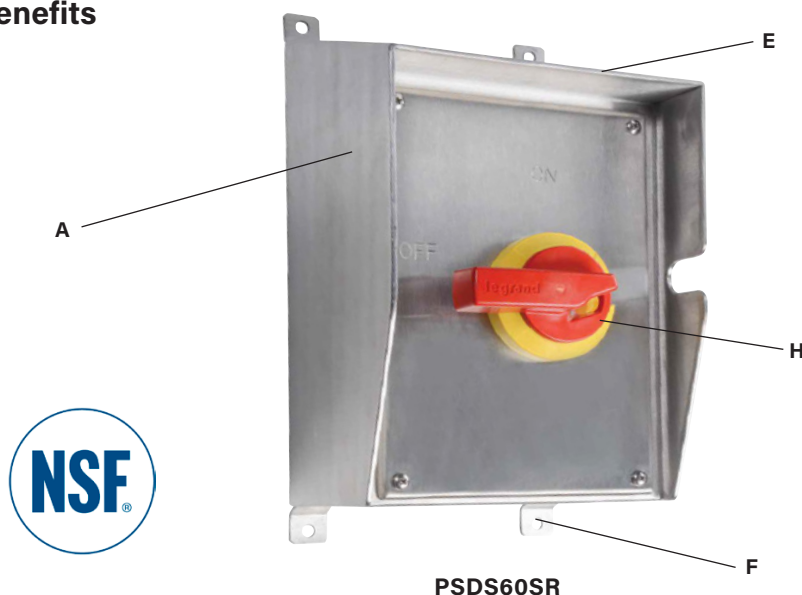

PSDS60SR

- A. Type 316 grade stainless steel** provides superior resistance to corrosion.
- B. 6 conduit entry points** for flexible installation options.
- C. Certified by the National Sanitation Foundation (NSF)** for hygiene requirements in food and beverage processing.
- D. Can accommodate up to 3 sets of auxiliary contacts** for control circuit applications.
- E. 5° sloped roof** helps to facilitate run-off and minimize the harborage of contaminants.
- F. 3/4" standoffs on mounting feet** allow adequate space for runoff and inspection behind the switch.
- G. Water- and dust-tight enclosure** rated **NEMA 4X/12** and **IP66/67/69** for protection against high-pressure, high-temperature water from multiple directions.
- H. High-visibility yellow and red handle** can be padlocked to meet OSHA lockout/ tagout requirements.

## Compliance



UL Listed 767A File #E31169; Complies with CSA standards; NSF Approved;  
NEMA 4X, 12; IP66, IP67, IP69; OSHA Compliant

## Technical Information

### Performance

#### Electrical

Dielectric Voltage Withstand	3000V minimum
Maximum Working Voltage	600V RMS
Current Interrupting	Listed for current interrupting at full-rated current and voltage
Short Circuit Withstand Rating	For use on circuit capable of delivering not more than (see chart on back page) RMS amps at 600VAC
Operations	Mechanical: 10,000 cycles Electrical: 10,000 cycles
Auxiliary Contacts (optional)	10A @ 600VAC; 1 N.O. & 1 N.C.

#### Mechanical

Impact Resistance	Per UL746C
Terminal Identification	Per UL and CSA
Product Identification	Identification and rating on external and internal labels
Mounting	External adjustable feet with five (5) positions* Can be mounted directly to channel or strut

#### Environmental

Moisture Resistance	Per UL50, section 35, NEMA Enclosure Type 4X (watertight, hosedown) Per UL50, section 35, NEMA Enclosure Type 12 (dusttight, falling dirt) • IP66/67/69
Flammability	UL94 5VA and VO Classification
Operating Temperature	Maximum continuous: +60°C Minimum continuous: -50°C without impact
UV Resistance	All enclosure materials are UV stabilized

### Materials

Enclosure Cover	316 Stainless Steel – 14 Gauge on 30A; 12 Gauge on 60/100A
Enclosure Base	316 Stainless Steel – 14 Gauge
Enclosure DIN Rail	316 Stainless Steel
Switch Handle	Valox 357®
Switch Base	Valox 357®
Switch Key	14% Glass-Filled Nylon
Cover Gasket	Silicone Foam
Handle Gasket	Silicone Foam
Mounting Feet	316 Stainless Steel – 12 Gauge
Cover Screws	316 Stainless Steel
Cover Screw O-Ring	Neoprene
Assembly Screws/Hardware	300 Series Stainless Steel

### Warranty

1 Year



**PSDS60SR, PSDS100SR**



**PSDS30SR**

### Mounting Dimension Table (inches)

	A	B	C	D	E
30 Amp	5.84	4.24	9.10	10.50	6.52
60/100 Amp	8.30	6.70	12.64	14.03	7.10

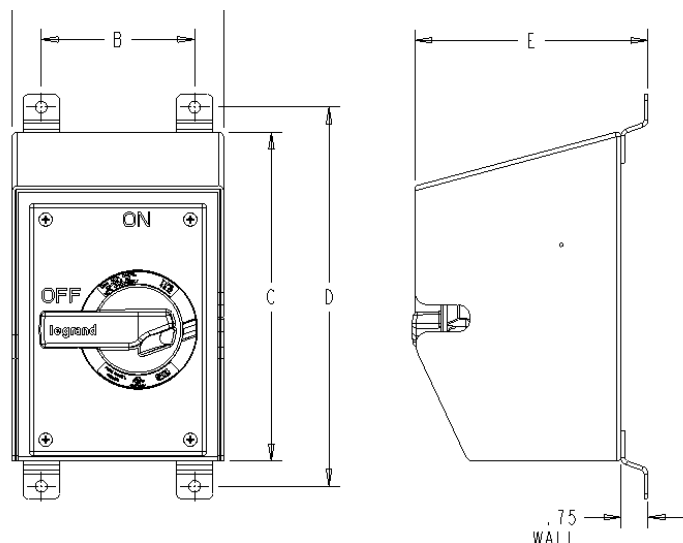

## Ordering Information

### Sloped-Roof Stainless Steel Safety Switches

VOLTAGE	MAXIMUM HORSEPOWER RATING	SLOPED-ROOF SAFETY SWITCH CATALOG NO.	SLOPED-ROOF SAFETY SWITCH WITH AUXILIARY CONTACT**	SLOPED-ROOF SAFETY SWITCH WITH 3 AUXILIARY CONTACTS**	AUXILIARY CONTACT KIT*	REPLACEMENT SWITCH	REPLACEMENT SWITCH WITH AUXILIARY CONTACT	REPLACEMENT SWITCH WITH 3 AUXILIARY CONTACTS	REPLACEMENT COVER FOR STANDARD SWITCH	REPLACEMENT COVER FOR AUXILIARY TYPE
<b>30 AMPS 600VAC</b>										
120 VAC	1.5 HP	PSDS30SR	PSDS30AXSR	PSDS30AX3SR	AX30	RS30	RS30AX	RS30AX3	PSDS30RC	PSDS30AXRC
208 VAC	3 HP									
240 VAC	5 HP									
277 VAC	5 HP									
480 VAC	7.5 HP									
600 VAC	7.5 HP									
3Ø 208Y/120 VAC	5 HP									
3Ø 240 VAC	10 HP									
3Ø 480Y/277 VAC	20 HP									
3Ø 480 VAC	20 HP									
3Ø 600Y/347 VAC	25 HP									
3Ø 600 VAC	25 HP									
<b>60 AMPS 600VAC</b>										
120 VAC	3 HP	PSDS60SR	PSDS60AXSR	—	AXD60	RS60	RS60AX	—	PSDS60RC	PSDS60AXRC
240 VAC	7.5 HP									
277 VAC	7.5 HP									
480 VAC	15 HP									
600 VAC	15 HP									
3Ø 240 VAC	15 HP									
3Ø 480Y/277 VAC	30 HP									
3Ø 480 VAC	30 HP									
3Ø 600Y/347 VAC	40 HP									
3Ø 600 VAC	40 HP									
<b>60 AMPS HP 600VAC</b>										
120 VAC	5 HP	PSDS60HPSR	PSDS60HPAXSR	—	AX60	RS60HP	RS60HPAX	—	PSDS60HPRC	PSDS60HPAXRC
240 VAC	10 HP									
277 VAC	15 HP									
480 VAC	20 HP									
600 VAC	30 HP									
3Ø 240 VAC	25 HP									
3Ø 480Y/277 VAC	50 HP									
3Ø 480 VAC	50 HP									
3Ø 600Y/347 VAC	50 HP									
3Ø 600 VAC	50 HP									
<b>100 AMPS 600VAC</b>										
120 VAC	5 HP	PSDS100SR	PSDS100AXSR	—	AX60	RS100	RS100AX	—	PSDS100RC	PSDS100AXRC
240 VAC	15 HP									
277 VAC	15 HP									
480 VAC	30 HP									
600 VAC	30 HP									
3Ø 240 VAC	25 HP									
3Ø 480Y/277 VAC	50 HP									
3Ø 480 VAC	50 HP									
3Ø 600Y/347 VAC	50 HP									
3Ø 600 VAC	50 HP									

\*For replacement of side mount auxiliary contact on previous design.

\*\*Auxiliary contacts break before switch contacts break for use with VFD.

**Interrupting Ratings — RMS Symmetrical Amperes**

Short Circuit Ratings: Suitable for use on circuits capable of delivering not more than (see chart below for cat. no. and application) RMS symmetrical amperes, 600VAC maximum.

Cat No.	KA	Fuse/Breaker	Max Size
<b>PSDS30SR (AX)</b>	10	RK1	—
	65	Class J	40A
<b>PSDS60SR (AX)</b>	10	RK1	125A
	65	Class J	70A
<b>PSDS60HPSR (AX)</b>	10	RK1	—
	10	GE Circuit Breaker	—
	65	Class J	100A

**Stainless Steel Safety Switches are ideal for a wide range of applications including:**

- Poultry Processing
- Seafood Processing
- Meat Processing
- Pharmaceutical Processing
- Food Packaging
- Food Preparation
- Agriculture
- Beverage Processing
- Health Care

**Also available in the radiant® collection**

- Mechanical Interlocks
- Flexcor® Wire Mesh Grips
- Turnlok® Locking Devices
- Portable GFCI
- IEC 309 Industrial Products
- Straight Blade Plugs & Connectors
- Ground Continuity Monitoring (GCM)



**Legrand, North America**  
60 Woodlawn Street  
West Hartford, CT 06110  
877-295-3472  
[www.legrand.us](http://www.legrand.us)  
844-977-3783  
[www.legrand.ca](http://www.legrand.ca)





## Maximize corrosion resistance.

PSDS30SR, PSDS60SR, PSDS60HPSR, PSDS100SR

Legrand's 316-Grade Sloped-Roof Stainless Steel Safety Switches are designed to provide superior corrosion resistance in harsh environments like food and beverage processing plants where wash-down/hose-down at extreme temperatures is a daily necessity, as well as in applications where salts, acids and chemicals are prevalent. Legrand's Sloped-Roof Stainless Steel Safety Switches with NEMA 4X/12, IP66/67/69 ratings are the best solution for durability and personnel safety in any environment.

## Features & Benefits

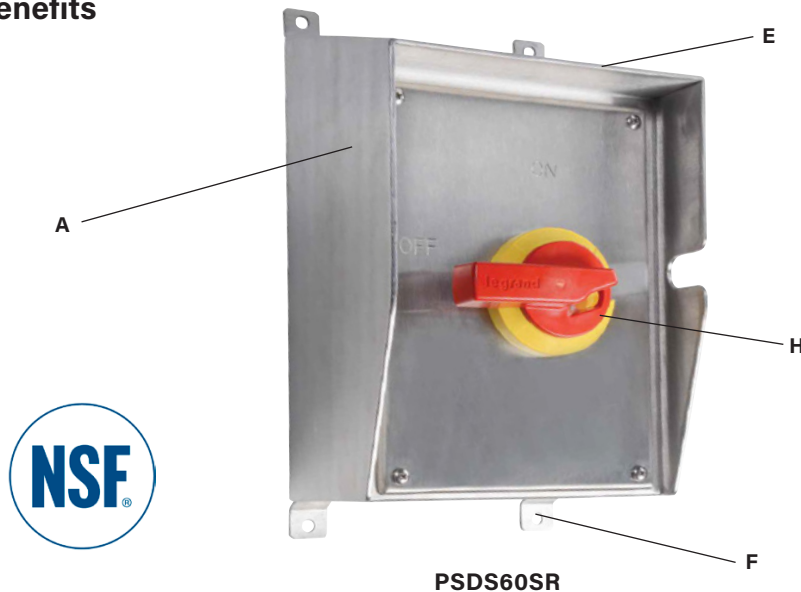

PSDS60SR

- A. Type 316 grade stainless steel** provides superior resistance to corrosion.
- B. 6 conduit entry points** for flexible installation options.
- C. Certified by the National Sanitation Foundation (NSF)** for hygiene requirements in food and beverage processing.
- D. Can accommodate up to 3 sets of auxiliary contacts** for control circuit applications.
- E. 5° sloped roof** helps to facilitate run-off and minimize the harborage of contaminants.
- F. 3/4" standoffs on mounting feet** allow adequate space for runoff and inspection behind the switch.
- G. Water- and dust-tight enclosure** rated **NEMA 4X/12** and **IP66/67/69** for protection against high-pressure, high-temperature water from multiple directions.
- H. High-visibility yellow and red handle** can be padlocked to meet OSHA lockout/ tagout requirements.

## Compliance



UL Listed 767A File #E31169; Complies with CSA standards; NSF Approved;  
NEMA 4X, 12; IP66, IP67, IP69; OSHA Compliant

## Technical Information

### Performance

#### Electrical

Dielectric Voltage Withstand	3000V minimum
Maximum Working Voltage	600V RMS
Current Interrupting	Listed for current interrupting at full-rated current and voltage
Short Circuit Withstand Rating	For use on circuit capable of delivering not more than (see chart on back page) RMS amps at 600VAC
Operations	Mechanical: 10,000 cycles Electrical: 10,000 cycles
Auxiliary Contacts (optional)	10A @ 600VAC; 1 N.O. & 1 N.C.

#### Mechanical

Impact Resistance	Per UL746C
Terminal Identification	Per UL and CSA
Product Identification	Identification and rating on external and internal labels
Mounting	External adjustable feet with five (5) positions* Can be mounted directly to channel or strut

#### Environmental

Moisture Resistance	Per UL50, section 35, NEMA Enclosure Type 4X (watertight, hosedown) Per UL50, section 35, NEMA Enclosure Type 12 (dusttight, falling dirt) • IP66/67/69
Flammability	UL94 5VA and VO Classification
Operating Temperature	Maximum continuous: +60°C Minimum continuous: -50°C without impact
UV Resistance	All enclosure materials are UV stabilized

### Materials

Enclosure Cover	316 Stainless Steel – 14 Gauge on 30A; 12 Gauge on 60/100A
Enclosure Base	316 Stainless Steel – 14 Gauge
Enclosure DIN Rail	316 Stainless Steel
Switch Handle	Valox 357®
Switch Base	Valox 357®
Switch Key	14% Glass-Filled Nylon
Cover Gasket	Silicone Foam
Handle Gasket	Silicone Foam
Mounting Feet	316 Stainless Steel – 12 Gauge
Cover Screws	316 Stainless Steel
Cover Screw O-Ring	Neoprene
Assembly Screws/Hardware	300 Series Stainless Steel

### Warranty

1 Year



**PSDS60SR, PSDS100SR**



**PSDS30SR**

### Mounting Dimension Table (inches)

	A	B	C	D	E
30 Amp	5.84	4.24	9.10	10.50	6.52
60/100 Amp	8.30	6.70	12.64	14.03	7.10

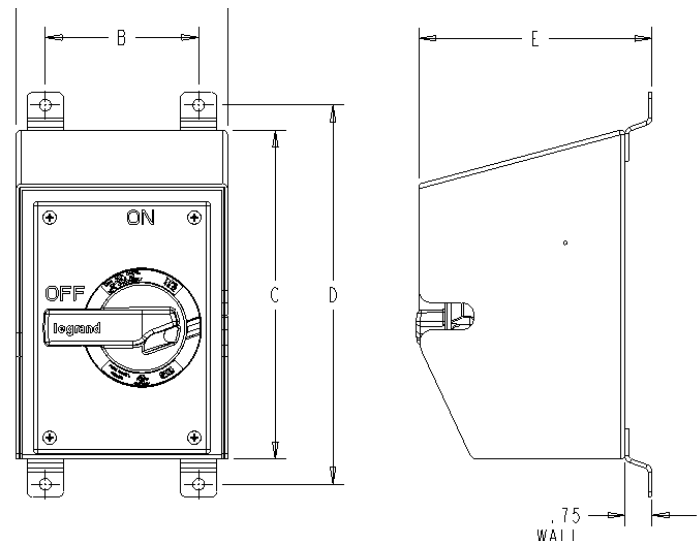



## Ordering Information

### Sloped-Roof Stainless Steel Safety Switches

VOLTAGE	MAXIMUM HORSEPOWER RATING	SLOPED-ROOF SAFETY SWITCH CATALOG NO.	SLOPED-ROOF SAFETY SWITCH WITH AUXILIARY CONTACT**	SLOPED-ROOF SAFETY SWITCH WITH 3 AUXILIARY CONTACTS**	AUXILIARY CONTACT KIT*	REPLACEMENT SWITCH	REPLACEMENT SWITCH WITH AUXILIARY CONTACT	REPLACEMENT SWITCH WITH 3 AUXILIARY CONTACTS	REPLACEMENT COVER FOR STANDARD SWITCH	REPLACEMENT COVER FOR AUXILIARY TYPE
30 AMPS	600VAC									
120 VAC	1.5 HP	PSDS30SR	PSDS30AXSR	PSDS30AX3SR	AX30	RS30	RS30AX	RS30AX3	PSDS30RC	PSDS30AXRC
208 VAC	3 HP									
240 VAC	5 HP									
277 VAC	5 HP									
480 VAC	7.5 HP									
600 VAC	7.5 HP									
3Ø 208Y/120 VAC	5 HP									
3Ø 240 VAC	10 HP									
3Ø 480Y/277 VAC	20 HP									
3Ø 480 VAC	20 HP									
3Ø 600Y/347 VAC	25 HP									
3Ø 600 VAC	25 HP									
60 AMPS	600VAC									
120 VAC	3 HP	PSDS60SR	PSDS60AXSR	—	AXD60	RS60	RS60AX	—	PSDS60RC	PSDS60AXRC
240 VAC	7.5 HP									
277 VAC	7.5 HP									
480 VAC	15 HP									
600 VAC	15 HP									
3Ø 240 VAC	15 HP									
3Ø 480Y/277 VAC	30 HP									
3Ø 480 VAC	30 HP									
3Ø 600Y/347 VAC	40 HP									
3Ø 600 VAC	40 HP									
60 AMPS HP	600VAC									
120 VAC	5 HP	PSDS60HPSR	PSDS60HPAXSR	—	AX60	RS60HP	RS60HPAX	—	PSDS60HPRC	PSDS60HPAXRC
240 VAC	10 HP									
277 VAC	15 HP									
480 VAC	20 HP									
600 VAC	30 HP									
3Ø 240 VAC	25 HP									
3Ø 480Y/277 VAC	50 HP									
3Ø 480 VAC	50 HP									
3Ø 600Y/347 VAC	50 HP									
3Ø 600 VAC	50 HP									
100 AMPS	600VAC									
120 VAC	5 HP	PSDS100SR	PSDS100AXSR	—	AX60	RS100	RS100AX	—	PSDS100RC	PSDS100AXRC
240 VAC	15 HP									
277 VAC	15 HP									
480 VAC	30 HP									
600 VAC	30 HP									
3Ø 240 VAC	25 HP									
3Ø 480Y/277 VAC	50 HP									
3Ø 480 VAC	50 HP									
3Ø 600Y/347 VAC	50 HP									
3Ø 600 VAC	50 HP									

\*For replacement of side mount auxiliary contact on previous design.

\*\*Auxiliary contacts break before switch contacts break for use with VFD.

**Interrupting Ratings — RMS Symmetrical Amperes**

Short Circuit Ratings: Suitable for use on circuits capable of delivering not more than (see chart below for cat. no. and application) RMS symmetrical amperes, 600VAC maximum.

Cat No.	KA	Fuse/Breaker	Max Size
<b>PSDS30SR (AX)</b>	10	RK1	—
	65	Class J	40A
<b>PSDS60SR (AX)</b>	10	RK1	125A
	65	Class J	70A
<b>PSDS60HPSR (AX)</b>	10	RK1	—
	10	GE Circuit Breaker	—
	65	Class J	100A

**Stainless Steel Safety Switches are ideal for a wide range of applications including:**

- Poultry Processing
- Seafood Processing
- Meat Processing
- Pharmaceutical Processing
- Food Packaging
- Food Preparation
- Agriculture
- Beverage Processing
- Health Care

**Also available in the radiant® collection**

- Mechanical Interlocks
- Flexcor® Wire Mesh Grips
- Turnlok® Locking Devices
- Portable GFCI
- IEC 309 Industrial Products
- Straight Blade Plugs & Connectors
- Ground Continuity Monitoring (GCM)



**Legrand, North America**  
60 Woodlawn Street  
West Hartford, CT 06110  
877-295-3472  
[www.legrand.us](http://www.legrand.us)  
844-977-3783  
[www.legrand.ca](http://www.legrand.ca)

