

Calbrite™

Stainless Steel Conduit Systems

Stainless Steel LL Condulet

Features:

- Manufactured in type 316 stainless steel to meet any stringent sanitary condition
- Polished with standard "brite" finish to increase corrosion resistance and aesthetic appearance
- Designed for use with stainless threaded conduit
- Solid stainless construction permits easy installation using ordinary hand tools
- The flat back design allows extra wiring capacity
- No package qty. required
- Cover & Gasket included
- Form 8 Style



Certifications and Compliances:

UL514A approved
UL File Number – E307133

Material:

Material: Body CF8M- 316SS
Gasket - Neoprene
Cover & Screws: 316SS

Applications:

To connect and change direction of conduit runs
Can be used as pulling fittings
Accessible wiring chamber provides
a spacious location to make splices

Industries Commonly Served:

- Food & Beverage Production & Distribution
- Chemical Plants
- Water & Wastewater Treatment
- Pharmaceuticals & Cosmetics
- Refining & Extraction Sites
- Petrochemical Operations
- Marine & Coastal Facilities
- Pulp and Paper Mills
- Along with other corrosive environments

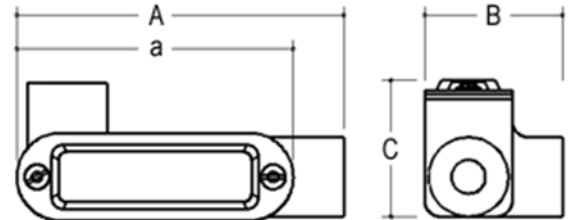

Size	Part Number	A	B	C	A	Cubic Inches	Weight (ea) per lb.
1/2"	S60500LL00	4.950"	2.150"	1.690"	4.320"	4"	1.04
3/4"	S60700LL00	5.590"	2.320"	1.950"	4.940"	7"	1.34
1"	S61000LL00	6.480"	2.670"	2.250"	5.650"	11"	1.91
1-1/2"	S61500LL00	8.940"	3.650"	3.040"	7.810"	35"	4.45
2"	S62000LL00	11.17"	4.710"	3.860"	10.00"	71"	9.02

All dimensions are for informational purposes only *Tolerances +/- 5%

Calbrite™

Stainless Steel Conduit Systems

Stainless Steel LL Condulet

Features:

- Manufactured in type 316 stainless steel to meet any stringent sanitary condition
- Polished with standard "brite" finish to increase corrosion resistance and aesthetic appearance
- Designed for use with stainless threaded conduit
- Solid stainless construction permits easy installation using ordinary hand tools
- The flat back design allows extra wiring capacity
- No package qty. required
- Cover & Gasket included
- Form 8 Style



Certifications and Compliances:

UL514A approved
UL File Number – E307133

Material:

Material: Body CF8M- 316SS
Gasket - Neoprene
Cover & Screws: 316SS

Applications:

To connect and change direction of conduit runs
Can be used as pulling fittings
Accessible wiring chamber provides
a spacious location to make splices

Industries Commonly Served:

- Food & Beverage Production & Distribution
- Chemical Plants
- Water & Wastewater Treatment
- Pharmaceuticals & Cosmetics
- Refining & Extraction Sites
- Petrochemical Operations
- Marine & Coastal Facilities
- Pulp and Paper Mills
- Along with other corrosive environments

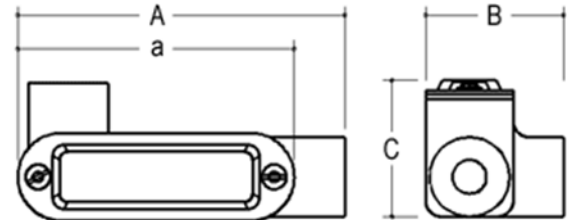

Size	Part Number	A	B	C	A	Cubic Inches	Weight (ea) per lb.
1/2"	S60500LL00	4.950"	2.150"	1.690"	4.320"	4"	1.04
3/4"	S60700LL00	5.590"	2.320"	1.950"	4.940"	7"	1.34
1"	S61000LL00	6.480"	2.670"	2.250"	5.650"	11"	1.91
1-1/2"	S61500LL00	8.940"	3.650"	3.040"	7.810"	35"	4.45
2"	S62000LL00	11.17"	4.710"	3.860"	10.00"	71"	9.02

All dimensions are for informational purposes only *Tolerances +/- 5%