

PRO
Operation Manual

PRO
Operation Manual



T701

Pro1 Technologies

1111 S. Glenstone Ave., Suite 3 -100
Springfield, MO 65804

Toll Free : 888-776-1427

Web: www.pro1iaq.com

Hours of Operation: M-F 9AM - 6PM Eastern

Table of Contents	Page
Table of Contents	1
Thermostat Operation	2-3
Thermostat Quick Reference	4-6
Thermostat Warranty Information	7

Una version en español de este manual se puede descargar en la pagina web de la compañía.



Caution

Equipment damage hazard. Do not operate the cooling system if the outdoor temperature is below 50 °F (10 °C) to prevent possible compressor damage.

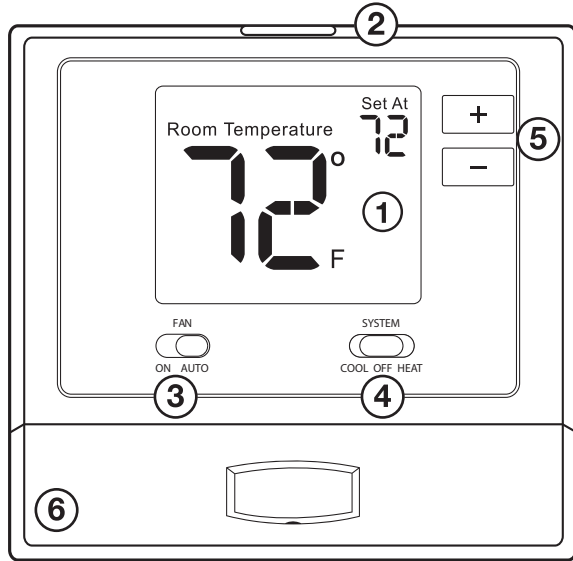

① LCD Display

② Glow in the dark light button

③ Fan Switch

④ System Switch

⑤ Temperature Setpoint Buttons

⑥ Easy change battery door

① LCD Display

See page 6 for details about this display read out.

② Glow in the dark light button

The glow in the dark light button will self illuminate for several hours after exposure to ambient light. This button turns on the display light when pressed.

③ Fan Switch

Select **ON** or **AUTO**. **ON** will run the fan continuously. **AUTO** will cycle the fan on only when the heating or cooling system is on.

④ System Switch

Selects the operation mode on your HVAC system. Selecting **HEAT** turns on the heat mode. Selecting **COOL** turns on the cool mode. Selecting **OFF** turns both heating and cooling off.

⑤ Temperature Setpoint Buttons

Press the + or - buttons to select the desired room temperature.

⑥ Easy Change Battery Door

See page 4 for details.

Battery Door Information

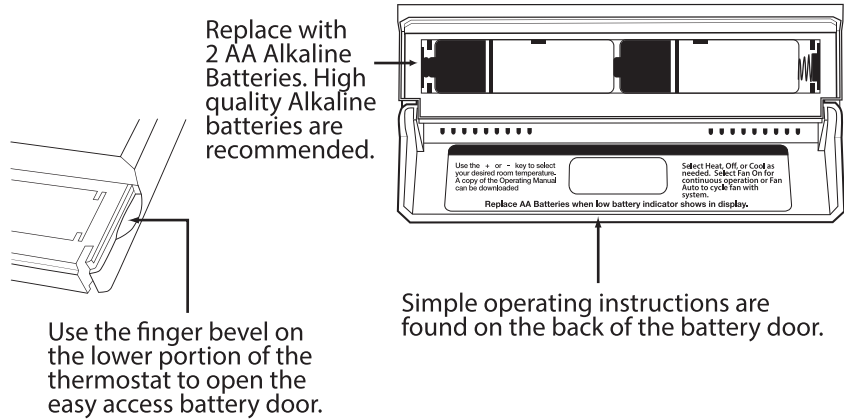

Important:

The low battery indicator is displayed when the AA battery power is low. If the user fails to replace the battery within 21 days, the screen will only show the low battery indicator but maintain all functionality. If the user fails to replace the batteries after an additional 21 days (days 22-42 since first "low battery" display) the setpoints will change to 55°F (Heating) and 85°F (Cooling). If the user adjusts the setpoint away from either of these, it will hold for 4 hours then return to either 55°F or 85°F. After day 63 the batteries must be replaced immediately to avoid freezing or overheating because the thermostat will shut the unit off until the batteries are changed.



Caution:

When the battery icon **LOW** appears replace your AA batteries immediately. Failure to do so may result in your heating & cooling system becoming inoperable. Freezing or overheating can occur.

Room Temperature:



Indicates the current room temperature.

Setpoint Temperature:

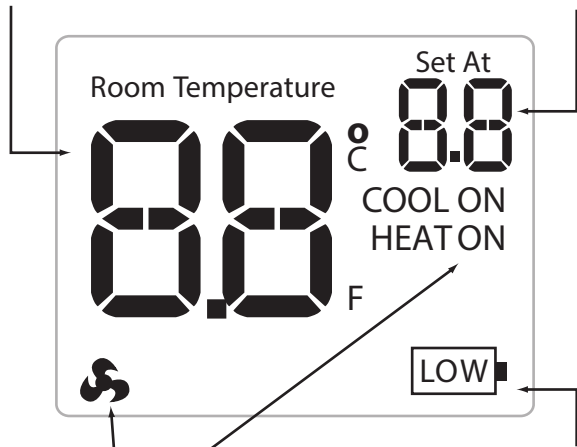
Displays the selected setpoint temperature.



System Operation Indicators:

The COOL ON, HEAT ON or  icon will display when the COOL, HEAT or  (fan) is on.

NOTE: The compressor delay feature is active if these icons are flashing. The compressor will not turn on until the 5 minute delay has elapsed.

Low Battery Indicator:

Replace batteries when indicator is shown.

Warranty Registration

Your new thermostat has a 5 year limited warranty. You must register your thermostat within 60 days of installation. Without this registration the warranty period will begin on date of manufacture. For warranty issues please contact the HVAC professional that installed this product. You can register your new thermostat in 2 ways:

Online

Go to the company website, select warranty registration and fill out a short registration form.

Mail

Complete the form below and mail it to the address shown.

Warranty Registration

Name: _____ Thermostat Model: _____

Address: _____ Date Installed: _____

City: _____ Complete form and mail to:

State: _____ **Thermostat Warranty Registration**

Zip: _____ 1111 S. Glenstone

Suite 3 -100
Springfield, MO 65804

**Cut Out For
Warranty Registration**



www.pro1iaq.com