

TMCX Connectors For Jacketed Metal Clad Cable

Explosionproof, Dust-Ignitionproof

TMCX For Hazardous Locations.

Class I, Division 1 and 2, Groups A, B, C, D

Class I, Zone 1, AExd IIC

Class II, Division 1 and 2 Groups E, F, G

Class III

NEMA 4X

IP66

Applications

- TMC connectors are designed for use with the following cables:
 - MC/MCHL
 - Corrugated Interlocked Aluminium/Steel Armor
 - Continuously Welded Armor Cables
 - E.g. TECK or CLX
- Provide a means for terminating jacketed type MC cable, forming a mechanical watertight connection and providing ground continuity for cable armor.
- For use on horizontal or vertical runs.

Features

- Independent sealing and armor clamping.
- True 360° grounding.
- Superior pull out prevention.
- Compact slim profile.
- Widest cable acceptance range.
- Supplied complete with epoxy sealing compound.
- Disconnectable design.
- Additional integral deluge proof seal for protection in extreme offshore and onshore environments.

Standard Materials

- Bodies, sleeve and gland nut: copperfree (4/10 or 1% max.) aluminum, nickel plated brass, stainless steel
- Grounding spring: stainless steel
- Bushing: LSF-TPE (halogen-free)
- Stop and slip washers: nylon
- O-ring: Viton

Size Ranges

- Trade sizes: 1/2" thru 4".
- Cable Jacket Diameter Range: 0.354" thru 4.220"
- Cable Armor Diameter Range: 0.342" thru 4.020"

Certifications and Compliances

- UL Standard: 2225, 514B
- UL Listed: 83827
- CSA Standard: C22.2 No. 174
- CSA Certified: 025875, 249506

Options

- PVC coating available on select connectors. Add suffix **-PVC** to catalog number.

Entry Thread A		Inches/Millimeters Cable Armor Diameter C				Cable Jacket Diameter D		Catalog Number		
NPT (Inches)	Metric	End Stop In		End Stop Out		Min	Max	Aluminum	NP Brass	Stainless Steel *
		Min	Max	Min	Max					
1/2S	M20	—	—	0.34/8.6	0.50/12.7	0.35/8.7	0.55/13.8	TMCX050SA †	TMCX050SNB	TMCX050SSS
1/2	M20	—	—	0.51/12.9	0.67/16.9	0.55/13.9	0.79/19.9	TMCX050A †	TMCX050NB	TMCX050SS
3/4	M25	0.59/15.0	0.76/19.1	0.76/19.2	0.92/23.2	0.67/19.9	1.04/26.2	TMCX075A †	TMCX075NB	TMCX075SS
1	M32	0.83/20.9	0.97/24.6	0.97/24.6	1.15/29.2	0.91/23.1	1.27/32.2	TMCX100A †	TMCX100NB	TMCX100SS
1-1/4	M40	1.08/27.5	1.23/31.1	1.23/31.1	1.39/35.2	1.16/29.4	1.50/38.2	TMCX125A †	TMCX125NB	TMCX125SS
1-1/2	M50	1.32/33.5	1.46/37.1	1.46/37.1	1.62/41.0	1.40/35.6	1.74/44.0	TMCX150A †	TMCX150NB	TMCX150SS
2S	M50	1.51/38.3	1.68/42.5	1.68/42.5	1.85/47.0	1.58/40.1	2.07/51.0	TMCX200SA	TMCX200SNB	TMCX200SSS
2	M63	1.77/45.0	1.93/49.0	1.93/49.0	2.09/53.0	1.86/47.1	2.21/56.0	TMCX200A †	TMCX200NB	TMCX200SS
2-1/2S	M63	2.05/52.1	2.16/54.8	2.16/54.8	2.32/58.9	2.08/52.8	2.44/26.0	TMCX250SA	TMCX250SNB	TMCX250SSS
2-1/2	M75	2.25/57.0	2.41/61.1	2.41/61.1	2.55/64.6	2.33/59.1	2.68/67.9	TMCX250A †	TMCX250NB	TMCX250SS
3	M90	2.54/64.5	2.78/70.5	2.78/70.5	2.97/75.3	2.62/66.5	3.13/79.4	TMCX300A †	TMCX300NB	TMCX300SS
3-1/2	M100	2.91/73.9	3.29/83.5	3.29/83.5	3.49/88.5	2.99/75.9	3.83/97.2	TMCX350A †	TMCX350NB	TMCX350SS
4	M110	—	—	3.50/88.9	4.02/102.1	3.70/93.9	4.22/107.1	TMCX402400	—	—

* Stainless Steel is priced by quote only. Contact your factory representative for assistance.

† PVC coating available. Add suffix **-PVC** to catalog number.

TMCX Connectors For Jacketed Metal Clad Cable

Explosionproof, Dust-Ignitionproof

TMCX For Hazardous Locations.

Class I, Division 1 and 2, Groups A, B, C, D
 Class I, Zone 1, AExd IIC
 Class II, Division 1 and 2 Groups E, F, G
 Class III
 NEMA 4X
 IP66

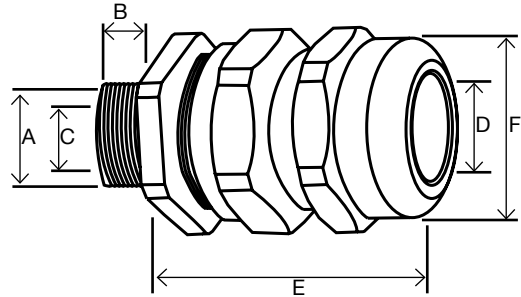

Entry Thread A		Inches/Millimeters			Compound Weight (Ounces)	Compound Supplied (Grams)	Quantity Each	Replacement Compound
NPT (Inches)	Metric	Minimum Thread Length B	Nominal Assembly Length E	Envelope Diameter F				
1/2S	M20	0.59/14.9	2.20/55.8	1.31/33.2	0.5	15	1	LTCOMP15
1/2	M20	0.59/14.9	2.20/55.8	1.57/39.8				
3/4	M25	0.59/14.9	2.20/55.8	1.79/45.4	1.2	35	1	LTCOMP35
1	M32	0.63/16.0	2.24/56.8	2.18/55.3	1.2	35	1	LTCOMP35
1-1/4	M40	0.63/16.0	2.24/56.8	2.40/60.9	2	55	1	LTCOMP55
1-1/2	M50	0.63/16.0	2.37/60.1	2.62/66.5	3.2	90	1	LTCOMP90
2S	M50	0.63/16.0	2.60/66.0	3.06/77.7	3.2	90	1	LTCOMP90
2	M63	0.63/16.0	2.81/71.3	3.28/83.3	4.8	135	1	LTCOMP135
2-1/2S	M63	0.90/22.8	2.88/73.1	3.49/88.6	9.5	270	1	LTCOMP270
2-1/2	M75	0.90/22.8	2.88/73.1	3.71/94.2	9.5	270	1	LTCOMP270
3	M90	0.98/24.8	3.92/99.5	4.80/121.9	14.3	405	1	LTCOMP135 LTCOMP270
3-1/2	M100	1.44/36.4	4.61/117.0	5.82/147.8	19	540	2	LTCOMP270
4	M110	1.44/36.4	7.66/194.5	5.84/148.3				

TMCX Connectors For Jacketed Metal Clad Cable

Explosionproof, Dust-Ignitionproof

TMCX For Hazardous Locations.

Class I, Division 1 and 2, Groups A, B, C, D

Class I, Zone 1, AExd IIC

Class II, Division 1 and 2 Groups E, F, G

Class III

NEMA 4X

IP66

Applications

- TMC connectors are designed for use with the following cables:
 - MC/MCHL
 - Corrugated Interlocked Aluminium/Steel Armor
 - Continuously Welded Armor Cables
 - E.g. TECK or CLX
- Provide a means for terminating jacketed type MC cable, forming a mechanical watertight connection and providing ground continuity for cable armor.
- For use on horizontal or vertical runs.

Features

- Independent sealing and armor clamping.
- True 360° grounding.
- Superior pull out prevention.
- Compact slim profile.
- Widest cable acceptance range.
- Supplied complete with epoxy sealing compound.
- Disconnectable design.
- Additional integral deluge proof seal for protection in extreme offshore and onshore environments.

Standard Materials

- Bodies, sleeve and gland nut: copperfree (4/10 or 1% max.) aluminum, nickel plated brass, stainless steel
- Grounding spring: stainless steel
- Bushing: LSF-TPE (halogen-free)
- Stop and slip washers: nylon
- O-ring: Viton

Size Ranges

- Trade sizes: 1/2" thru 4".
- Cable Jacket Diameter Range: 0.354" thru 4.220"
- Cable Armor Diameter Range: 0.342" thru 4.020"

Certifications and Compliances

- UL Standard: 2225, 514B
- UL Listed: 83827
- CSA Standard: C22.2 No. 174
- CSA Certified: 025875, 249506

Options

- PVC coating available on select connectors. Add suffix **-PVC** to catalog number.

Entry Thread A		Inches/Millimeters Cable Armor Diameter C				Cable Jacket Diameter D		Catalog Number		
NPT (Inches)	Metric	End Stop In		End Stop Out		Min	Max	Aluminum	NP Brass	Stainless Steel *
		Min	Max	Min	Max					
1/2S	M20	—	—	0.34/8.6	0.50/12.7	0.35/8.7	0.55/13.8	TMCX050SA †	TMCX050SNB	TMCX050SSS
1/2	M20	—	—	0.51/12.9	0.67/16.9	0.55/13.9	0.79/19.9	TMCX050A †	TMCX050NB	TMCX050SS
3/4	M25	0.59/15.0	0.76/19.1	0.76/19.2	0.92/23.2	0.67/19.9	1.04/26.2	TMCX075A †	TMCX075NB	TMCX075SS
1	M32	0.83/20.9	0.97/24.6	0.97/24.6	1.15/29.2	0.91/23.1	1.27/32.2	TMCX100A †	TMCX100NB	TMCX100SS
1-1/4	M40	1.08/27.5	1.23/31.1	1.23/31.1	1.39/35.2	1.16/29.4	1.50/38.2	TMCX125A †	TMCX125NB	TMCX125SS
1-1/2	M50	1.32/33.5	1.46/37.1	1.46/37.1	1.62/41.0	1.40/35.6	1.74/44.0	TMCX150A †	TMCX150NB	TMCX150SS
2S	M50	1.51/38.3	1.68/42.5	1.68/42.5	1.85/47.0	1.58/40.1	2.07/51.0	TMCX200SA	TMCX200SNB	TMCX200SSS
2	M63	1.77/45.0	1.93/49.0	1.93/49.0	2.09/53.0	1.86/47.1	2.21/56.0	TMCX200A †	TMCX200NB	TMCX200SS
2-1/2S	M63	2.05/52.1	2.16/54.8	2.16/54.8	2.32/58.9	2.08/52.8	2.44/26.0	TMCX250SA	TMCX250SNB	TMCX250SSS
2-1/2	M75	2.25/57.0	2.41/61.1	2.41/61.1	2.55/64.6	2.33/59.1	2.68/67.9	TMCX250A †	TMCX250NB	TMCX250SS
3	M90	2.54/64.5	2.78/70.5	2.78/70.5	2.97/75.3	2.62/66.5	3.13/79.4	TMCX300A †	TMCX300NB	TMCX300SS
3-1/2	M100	2.91/73.9	3.29/83.5	3.29/83.5	3.49/88.5	2.99/75.9	3.83/97.2	TMCX350A †	TMCX350NB	TMCX350SS
4	M110	—	—	3.50/88.9	4.02/102.1	3.70/93.9	4.22/107.1	TMCX402400	—	—

* Stainless Steel is priced by quote only. Contact your factory representative for assistance.

† PVC coating available. Add suffix **-PVC** to catalog number.

TMCX Connectors For Jacketed Metal Clad Cable

Explosionproof, Dust-Ignitionproof

TMCX For Hazardous Locations.

Class I, Division 1 and 2, Groups A, B, C, D
 Class I, Zone 1, AExd IIC
 Class II, Division 1 and 2 Groups E, F, G
 Class III
 NEMA 4X
 IP66

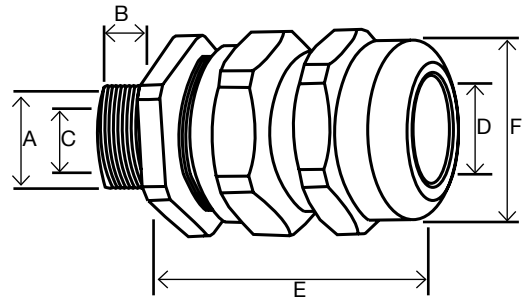

Entry Thread A		Inches/Millimeters			Compound Weight (Ounces)	Compound Supplied (Grams)	Quantity Each	Replacement Compound
NPT (Inches)	Metric	Minimum Thread Length B	Nominal Assembly Length E	Envelope Diameter F				
1/2S	M20	0.59/14.9	2.20/55.8	1.31/33.2	0.5	15	1	LTCOMP15
1/2	M20	0.59/14.9	2.20/55.8	1.57/39.8				
3/4	M25	0.59/14.9	2.20/55.8	1.79/45.4	1.2	35	1	LTCOMP35
1	M32	0.63/16.0	2.24/56.8	2.18/55.3	1.2	35	1	LTCOMP35
1-1/4	M40	0.63/16.0	2.24/56.8	2.40/60.9	2	55	1	LTCOMP55
1-1/2	M50	0.63/16.0	2.37/60.1	2.62/66.5	3.2	90	1	LTCOMP90
2S	M50	0.63/16.0	2.60/66.0	3.06/77.7	3.2	90	1	LTCOMP90
2	M63	0.63/16.0	2.81/71.3	3.28/83.3	4.8	135	1	LTCOMP135
2-1/2S	M63	0.90/22.8	2.88/73.1	3.49/88.6	9.5	270	1	LTCOMP270
2-1/2	M75	0.90/22.8	2.88/73.1	3.71/94.2	9.5	270	1	LTCOMP270
3	M90	0.98/24.8	3.92/99.5	4.80/121.9	14.3	405	1	LTCOMP135 LTCOMP270
3-1/2	M100	1.44/36.4	4.61/117.0	5.82/147.8	19	540	2	LTCOMP270
4	M110	1.44/36.4	7.66/194.5	5.84/148.3				