

Receptacles

From decorator and standard styles to Tamper Resistant receptacles, our broad line covers virtually any need throughout a house. All of our receptacles are designed for long-term reliability and ease of installation, while meeting and exceeding the latest industry and UL performance standards.

Receptacle Families

 <p>Heavy Duty Grade</p> <p>B-22</p>	 <p>Decorator Standard Grade</p> <p>B-23</p>	 <p>Standard Grade</p> <p>B-24</p>	 <p>Specialty Standard Grade</p> <p>B-27</p>	 <p>Academy Series Outlets</p> <p>B-28</p>
---	---	---	--	---

Receptacle Colors

Almond (A)	Black (BK)	Brown (B)	Gray (GY)	Ivory (V)	Light Almond (LA)	White (W)
---------------	---------------	--------------	--------------	--------------	----------------------	--------------

The Cooper Wiring Devices Difference



- 1 Extra durability Heavy Duty Grade models available for high abuse areas
- 2 Screw-Catch™ feature on traditional duplex devices automatically holds the wallplate mounting screw in place
- 3 Built-in wire looper to speed termination of both #14 and #12 AWG wire
- 4 Slotted, Phillips and Robertson Tri-Combo screw heads offer greater installation flexibility
- 5 Tamper Resistant versions provide compliance with 2011 NEC® section 406.12 and provide significantly improved protection over traditional receptacles with removable plastic safety caps



Specific Receptacle Solutions for Today's Needs



Child Safety

Tamper Resistant receptacles not only provide code compliance, they also deliver automatic, continual protection from electrical injury as a result of inserting foreign objects.



Shown:
TR270

See
page:
B-22



Home Entertainment Devices

Today's flat-screen televisions mount closely to the wall, requiring recessed receptacles to permit tight mounting clearances and leave more room for cord control.



Shown:
TR780

See
page:
B-22



Aluminum Wiring

There are many homes that still contain aluminum wiring. Using hybrid copper & aluminum compatible (CO/ALR) receptacles can reduce the hazards of aluminum wiring.



Shown:
5270

See
page:
B-26

Standard Grade Receptacles

2-Pole, 3-Wire Grounding
2-Pole, 2-Wire Non-Grounding
15A, 125V/AC



5-15R



5-20R





TR270



TWR270

Features

- Tamper Resistant versions provide compliance with 2011 NEC® Article 406.12 that states that all receptacles installed in dwelling units must be tamper resistant 
- Weather Resistant versions provide compliance with 2011 NEC® Article 406.9 that states that all receptacles installed in wet and damp locations must be weather resistant 
- Longer, wider strap provides 40% more contact area to wall board, virtually eliminating floating installations
- Push-in terminals accept #14 AWG solid wire
- Patented built-in wire stripper for #14 and #12 AWG wire to speed installation
- Patented built-in wire looper for pre-looping
- High impact-resistant thermoplastic face and back body eliminates breakage
- Double-wipe ground contacts ensure long-term ground retention
- Easy access split circuit break-off tab
- Tri-Combo screws accept Slotted-, Phillips-, and Robertson-head tools for installation flexibility
- Terminal screws backed out and ready for wiring
- Side wire terminals accept up to #10 AWG solid wire

Tamper Resistant Duplex Receptacles



Rating A	V/AC	Description	Color Suffix	Catalog No.	
15	125	Tamper Resistant NEMA 5-15R Duplex Receptacle, Side & Push Wire	A, B, BK, LA, V, W	□ TR270__	•
		Auto Grounding Tamper Resistant NEMA 5-15R, Duplex Receptacle, Side & Push Wire	A, B, LA, V, W	□ TR270-9__	•
20	125	NEMA 5-20 Tamper Resistant Duplex Receptacle, 2-Pole, 3-Wire, Side Wire	A, B, BK, GY, LA, V, W	□ TR370__	

cULus Listed to UL498, file no. E15058; NOM certified

Tamper & Weather Resistant Duplex Receptacles



Rating A	V/AC	Description	Color Suffix	Catalog No.	
15	125	Tamper & Weather Resistant NEMA 5-15R Duplex Receptacle, Side & Push Wire	LA, V, W	□ TWR270__	•

cULus Listed to UL498, file no. E15058; NOM certified

Color Ordering Information:

For ordering devices, include Catalog No. followed by the Color Suffix: A (Almond), B (Brown), BK (Black), GY (Gray), LA (Light Almond), V (Ivory), W (White)

A	B	BK	GY	LA	V	W
(Almond)	(Brown)	(Black)	(Gray)	(Light Almond)	(Ivory)	(White)

Dimensional Information: B-68 **Specification Information:** Please visit www.cooperwiringdevices.com.
Specifications and availability are subject to change without notice.

 NAFTA Compliant - see page F-21

Switches

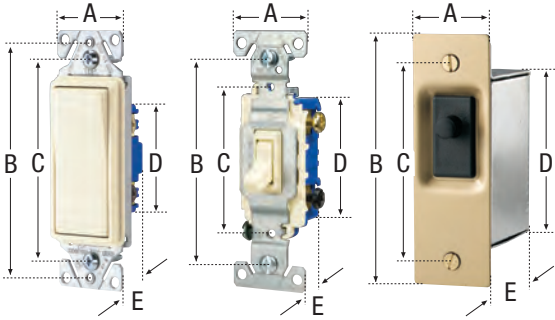

Family	A	B	C	D	E
Decorator Standard Grade, Single-Pole & 3-Way	1.44" (36.6mm)	3.81" (96.8mm)	3.28" (83.3mm)	2.74" (69.6mm)	0.97" (24.6mm)
Decorator Standard Grade, 4-Way	1.44" (36.6mm)	3.81" (96.8mm)	3.28" (83.3mm)	2.60" (66.1mm)	1.18" (30.0mm)
Heavy Duty Grade Toggle	1.31" (33.3mm)	3.28" (83.3mm)	2.38" (60.5mm)	2.00" (50.8mm)	1.05" (26.7mm)
Standard Grade Toggle	1.31" (33.3mm)	3.28" (83.3mm)	2.38" (60.5mm)	2.13" (54.1mm)	0.88" (22.4mm)
Standard Grade Toggle, Less Ears	0.75" (19.1mm)	3.28" (83.3mm)	2.38" (60.5mm)	2.13" (54.1mm)	0.88" (22.4mm)
CO/ALR Standard Grade Toggle	1.31" (33.3mm)	3.28" (83.3mm)	2.38" (60.5mm)	2.13" (54.1mm)	0.88" (22.4mm)
Door Operated Canopy Switch Assembly	1.25" (31.8mm)	3.94" (100.1mm)	3.13" (79.5mm)	2.63" (66.8mm)	1.25" (31.8mm)

Circuit Control Switches

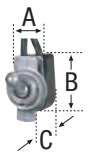

Cat. No.	A	B	C
452	0.50" (12.7mm)	0.88" (22.4mm)	0.53" (13.5mm)

Feed-Through Cord Switches

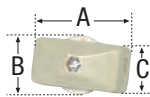

Cat. Nos.	A	B	C
410	1.35" (34.5mm)	0.91" (23.1mm)	0.55" (14.0mm)
933	2.49" (63.4mm)	1.47" (36.7mm)	1.25" (31.6mm)

Combination Devices

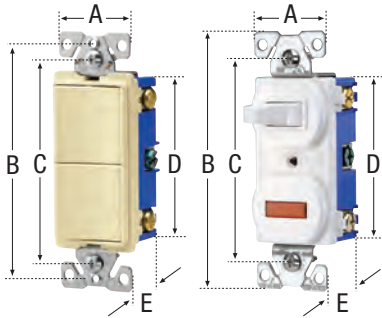

Family	A	B	C	D	E
Decorator Combination	1.30" (33.0mm)	3.81" (96.8mm)	3.28" (83.3mm)	2.65" (67.3mm)	1.08" (27.4mm)
Traditional Combination	1.30" (33.0mm)	4.19" (106.4mm)	3.28" (83.3mm)	2.65" (67.3mm)	1.08" (27.4mm)
Nightlight Combination	1.30" (33.0mm)	3.81" (96.8mm)	3.28" (83.3mm)	2.65" (67.3mm)	1.08" (27.4mm)

Duplex Receptacle

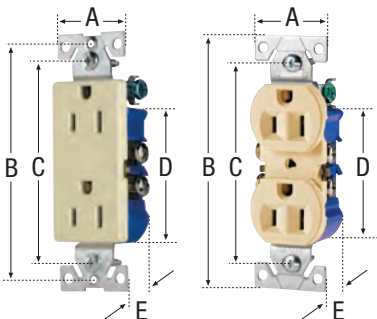

Family or Cat. No.	A	B	C	D	E
Heavy Duty Grade Tamper Resistant	1.24" (31.5mm)	4.00" (101.6mm)	3.23" (82.0mm)	2.63" (66.8mm)	1.04" (26.4mm)
Decorator Standard Grade	1.30" (33.0mm)	3.81" (96.8mm)	3.28" (83.3mm)	2.12" (53.8mm)	0.69" (17.5mm)
Standard Grade, except 298	1.31" (33.3mm)	4.19" (106.4mm)	3.28" (83.3mm)	2.63" (66.8mm)	0.69" (17.5mm)
298	1.31" (33.3mm)	4.19" (106.4mm)	3.28" (83.3mm)	2.63" (66.8mm)	0.74" (18.8mm)
CO/ALR Standard Grade	1.38" (35.1mm)	4.06" (103.1mm)	3.28" (83.3mm)	2.61" (66.3mm)	0.71" (18.0mm)