

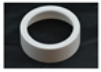

ELLIOTT ELECTRIC SUPPLY

We Deliver...Lower Cost, Quality Products, & Personal Service

3804 South Street
75964-7263, TX Nacogdoches
Phone: 936-569-7941
Fax: 936-560-4685



TWB58 3" Emt Insulating Bushing *Bridgeport Fittings*

Catalog Number	TWB58
Manufacturer	Bridgeport Fittings
Description	Emt Insulating Bushing, 3 In Trade Size, Plastic, White, 2.725 In Length, 1.21 In Width, +90 °C Operating Temperature
Weight per unit	0.0720 (lbs/each)
Product Category	Emt Insulating Bushings

Features

media	Yes
-------	-----

Material, Color, and Finish

Color	WHITE
Finish	PLAIN

Dimensions and Weight

Size	3 In
------	------

Descriptions

Description	3" EMT INSULATING BUSHING
-------------	---------------------------

Manufacturer Information

Brand	Bridgeport
GTIN	00781747400581
UPC	781747400581

Taxonomies, Classifications, and Categories

Category Description	Locknuts, Bushings, Re-Bushings, Re-Washers, Threaded Plugs, Knockout Plugs
Type	BUSHING

Packaging

Carton	1
Package	25
Weight Per each	0.072

Uses, Certifications, and Standards

Temperature Rating	90 DEG
--------------------	--------

Insulating Bushings - EMT Type

Images

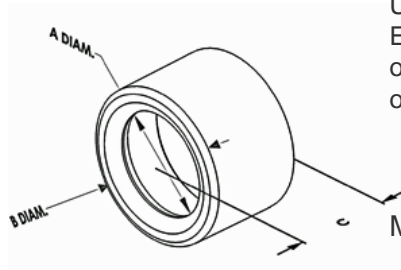

Application

Use where nonmetallic low voltage cabling is installed in EMT. Protects from sharp edges. May be used for single or multiple voice, video, or data cables. Place bushing over end of RMT and tap lightly onto tubing.

Product Information

Material: Plastic

Certifications & Codes:

UNSPSC: 39121312

[Download Photo Image](#)

[Download Dimensional Image](#)

Dimension A in Inches: 2.725
Dimension B in Inches: 3.600
Dimension C in Inches: 1.210

Catalog ID: TWB-58

UPC Number: 781747400581

Description: Bushing, Insulating, Polyethylene, Trade Size 3 Inch

Application: Use where nonmetallic low voltage cabling is installed in EMT. Protects from sharp edges. May be used for single or multiple voice, video, or data cables. Place bushing over end of RMT and tap lightly onto tubing.

Trade Size: 3"

Std Pkg Qty: 25

Unit Qty: Bulk