

D2PB PANELBOARDS REPLACEMENT PARTS

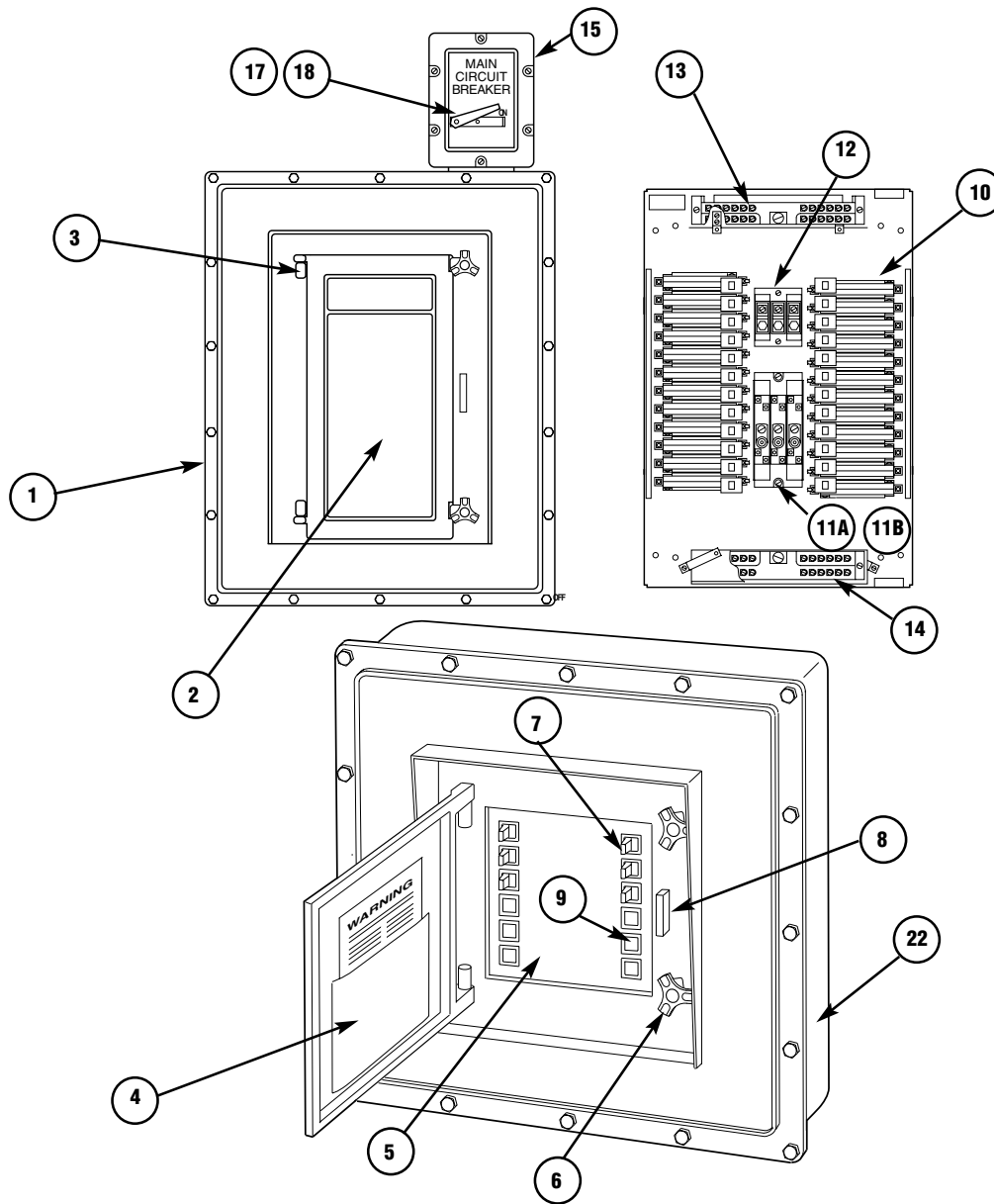

ITEM	DESCRIPTION	USED ON	PART NO.
1	COVER ASSEMBLY (includes main cover, door, directory, and gasket)	D2PB SIZE 1 D2PB SIZE 2	D2PBC-K2 D2PBC-K4
2	DOOR ASSEMBLY (includes door, gasket, breaker directory, and protective sleeve)	D2PB SIZE 1 D2PB SIZE 2	D2PB-K5-M2 * D2PB-K6-M2 *
3	HINGE KIT (includes 2 hinges and hardware)	ALL D2PB	D2PB-K20

D2PB PANELBOARDS REPLACEMENT PARTS

ITEM	DESCRIPTION	USED ON	PART NO.
12	CONNECTION BLOCK – D2PB W/ MAIN BREAKER	D2PB-2M (2-POLE)	D2PB:0204796-1
		D2PB-3M (3-POLE)	D2PB:0204796-2
13	NEUTRAL BAR ASSEMBLY	ALL D2PB	D2PB-K26
14	GROUND BAR ASSEMBLY	ALL D2PB	D2PB-K27
15	MAIN BREAKER HOUSING W/ BREAKER	D2PB-2M (2-POLE)	D2PB K12 2M ****
		D2PB-3M (3-POLE)	D2PB K13 3M ****
16	MAIN BREAKER HOUSING LESS BREAKER (Not shown)	D2PB-2M (2-POLE)	D2PB K24 2M **** LS BRKR
		D2PB-3M (3-POLE)	D2PB K25 3M **** LS BRKR
17	MAIN BREAKER HANDLE ASSEMBLY (includes shaft/bushing, handle, and hardware)	D2PB-2M, 3M	D2PB K23
18	MAIN BREAKER SHAFT / BUSHING ONLY (Not shown)	D2PB-2M, 3M	D2PB K11
19	MAIN BREAKER HANDLE ONLY	D2PB-2M, 3M	D2PB:0203068
20	MAIN CIRCUIT BREAKER BAIL OPERATING ASSEMBLY (Not shown)	D2PB-2M, 3M	D2PB:0204094
21	D2PB HOUSING, LESS BREAKERS (Not shown)	D2PB SIZE 1, SINGLE-PHASE	D2PB1412 LS BRKRS
		D2PB SIZE 1, THREE-PHASE	D2PB1512 LS BRKRS
		D2PB SIZE 2, SINGLE-PHASE	D2PB2424 LS BRKRS
		D2PB SIZE 2, THREE-PHASE	D2PB2524 LS BRKRS
22	D2PB HOUSING, LESS BREAKERS, MACHINED FOR MAIN BREAKER HOUSING (Not shown)	D2PB SIZE 1, SINGLE-PHASE	D2PB14M LS BRKRS
		D2PB SIZE 1, THREE-PHASE	D2PB15M LS BRKRS
		D2PB SIZE 2, SINGLE-PHASE	D2PB24M LS BRKRS
		D2PB SIZE 2, THREE-PHASE	D2PB25M LS BRKRS
23	PLUGS FOR BRANCH OPENINGS (Not shown)	ALL MODELS	PLG4
24	BREATHER (Not shown)	ALL MODELS	ECD13
25	DRAIN (Not shown)	ALL MODELS	ECD11

**** Specify amperage when ordering (20 through 100 amp)